

SCALE 1:250  
0 10 20m

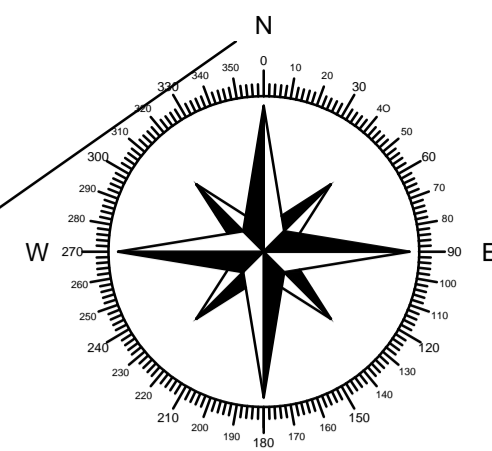

The Development registered under title PTH44433 and plots 1 to 29 within have been DPA approved by:  
*Craig McFadden - 13 January 2017*  
Craig McFadden ( DPA Officer)

TITLE DEED PLAN

NOTE:  
All proprietary goods and materials are to be fitted in accordance with manufacturer's instructions, Codes of Practice and British Standards. All dimensions to be verified by the Contractor on site. Work to figured dimensions only.  
© This drawing remains the Copyright of Fouin+Bell Architects Ltd. and may not be reproduced in whole or in any part without prior written permission.  
REVISION / DESCRIPTION / DATE

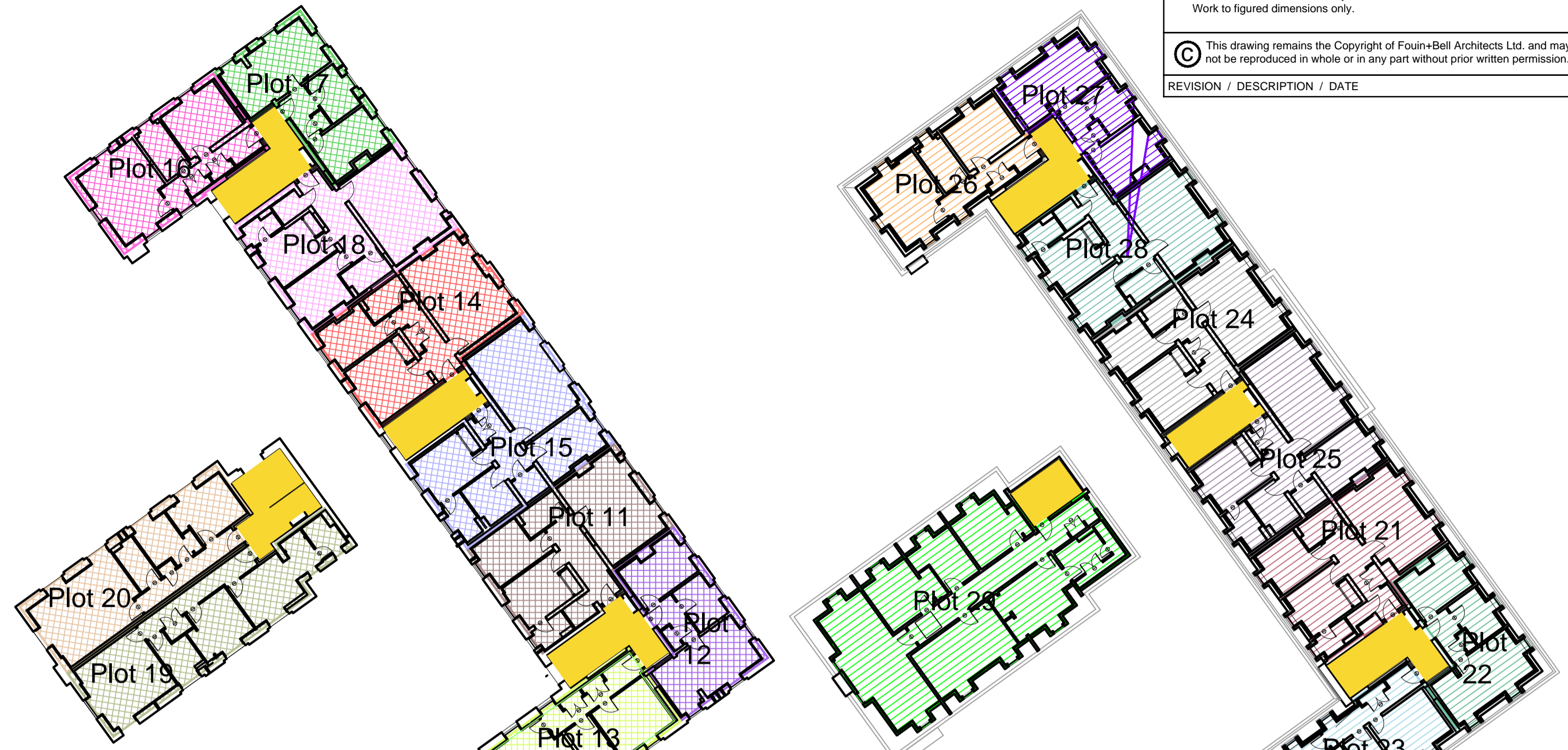

First floor.

Second floor.

HATCH INDICATES PLOT POSITION AND ALLOCATED PARKING SPACE.

- PLOT ONE - GROUND FLOOR
- PLOT TWO - GROUND FLOOR
- PLOT THREE - GROUND FLOOR
- PLOT FOUR - GROUND FLOOR
- PLOT FIVE - GROUND FLOOR
- PLOT SIX - GROUND FLOOR
- PLOT SEVEN - GROUND FLOOR
- PLOT EIGHT - GROUND FLOOR
- PLOT NINE - GROUND FLOOR
- PLOT TEN - GROUND FLOOR

- STAIRWELL ACCESS
- CYCLE STORE
- BIN STORE
- COMMUNAL LANDSCAPING & LAWN
- SITE ACCESS
- VISITOR PARKING (V)

- PLOT ELEVEN - FIRST FLOOR
- PLOT TWELVE - FIRST FLOOR
- PLOT THIRTEEN - FIRST FLOOR
- PLOT FOURTEEN - FIRST FLOOR
- PLOT FIFTEEN - FIRST FLOOR
- PLOT SIXTEEN - FIRST FLOOR
- PLOT SEVENTEEN - FIRST FLOOR
- PLOT EIGHTEEN - FIRST FLOOR
- PLOT NINETEEN - FIRST FLOOR
- PLOT TWENTY - FIRST FLOOR
- PLOT TWENTY ONE - SECOND FLOOR
- PLOT TWENTY TWO - SECOND FLOOR
- PLOT TWENTY THREE - SECOND FLOOR
- PLOT TWENTY FOUR - SECOND FLOOR
- PLOT TWENTY FIVE - SECOND FLOOR
- PLOT TWENTY SIX - SECOND FLOOR
- PLOT TWENTY SEVEN - SECOND FLOOR
- PLOT TWENTY EIGHT - SECOND FLOOR
- PLOT TWENTY NINE - SECOND FLOOR



Location Plan, Scale 1:1250.

Rev D: 20.10.2016; Plots 4 and 5 file text corrected  
 Rev C: 22.08.2016; Plots 04,05 parking swapper with plots 14 and 15  
 Rev B: 04.05.2016; Boundary at main entrance altered, Car parking allocation altered.



1 John's Place Edinburgh EH6 7EL  
T: 0131 478 7100 F: 0131 478 7111  
mail@fouin-bell.com www.fouin-bell.com

---



---

PROJECT  
**RESIDENTIAL DEVELOPMENT  
TAYMOUNT TERRACE  
PERTH**

---

SCALE @A1	1:250@A1 1:500@A3	DATE	25.08.15
DRAWN BY	MCR	CHECKED	STAGE
DRAWING <b>TITLE DEED PLAN</b>			
PROJECT NUMBER	DRAWING NUMBER	REVISION	
<b>14-329</b>	<b>(PL)15</b>	<b>D</b>	