

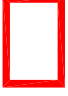







-  DENOTES PHASE 8 SUBJECTS
-  DENOTES FLAT BLOCK BOUNDARY
-  DENOTES COMMON STAIR (COMMUNALLY OWNED) AND MAINTAINED BY FACTOR
-  OPEN SPACE (COMMUNALLY OWNED) AND MAINTAINED BY FACTOR
-  DENOTES ROADS, FOOTPATHS AND HARDSTANDINGS MAINTAINED BY FACTOR
-  DENOTES WAYLEAVE
-  DENOTES ALLOCATED PARKING

**PHASE 8 SITE PLAN 1:500**

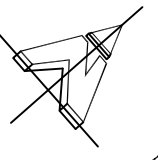

The Development (Phase 8) registered under title STG60102 and plots 517 to 532

and 145 to 153 within have been DPA approved by:

*Craig McFadden - 11 February 2016*

Craig McFadden ( DPA Officer)

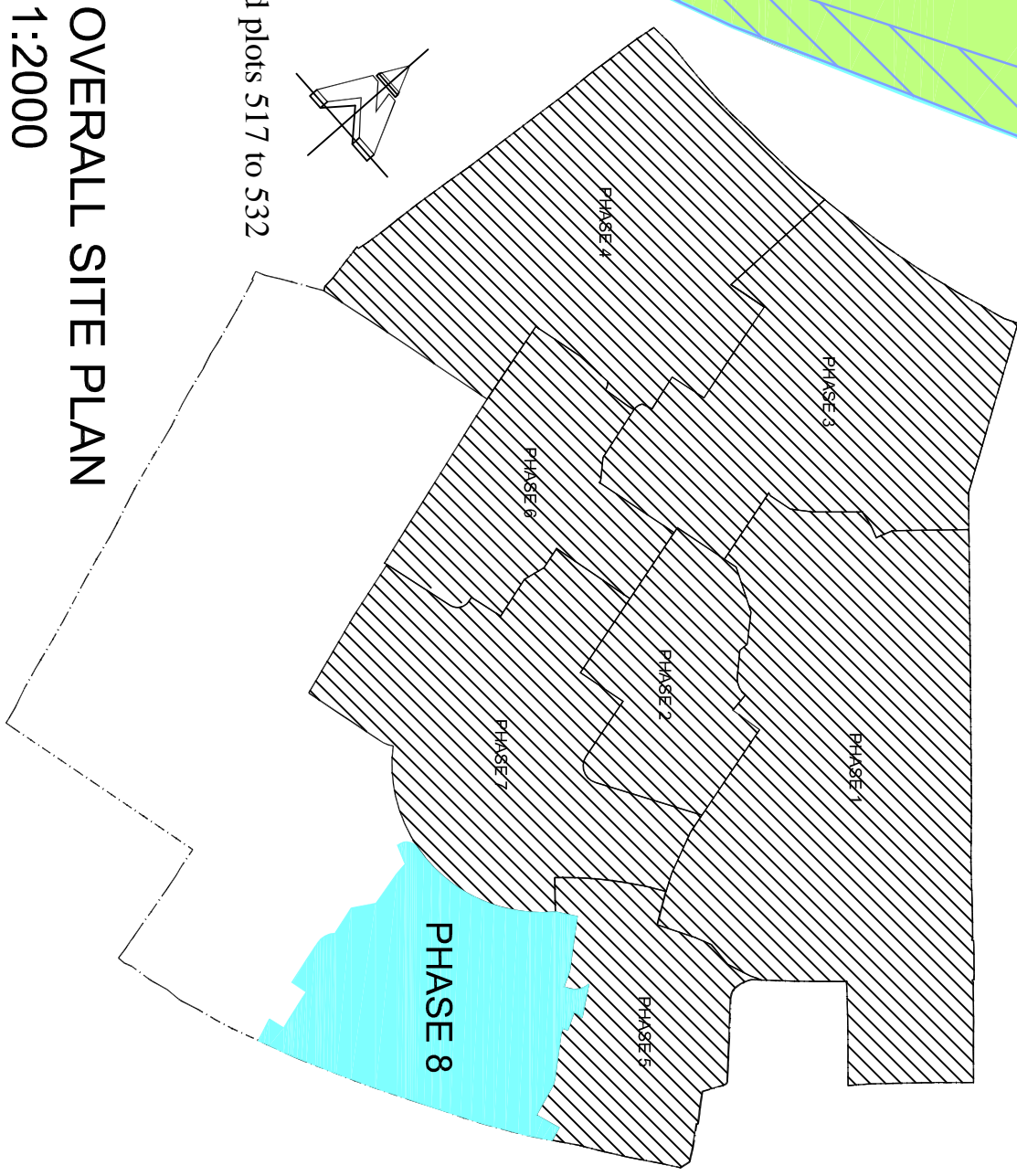

**OVERALL SITE PLAN 1:2000**

**Notes**  
DO NOT SCALE DRAWINGS

REV B 09/02/16 WAYLEAVES ADDED HD  
 REV A 19/10/15 FLAT BLOCK 2 SPLIT INTO BLOCKS 2A, 2B, 2C AND PARKING AREAS UPDATED HD

PRELIMINARY/APPROVED DRAWING

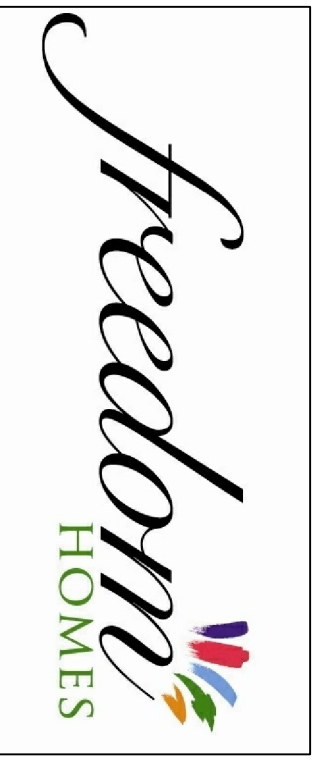

Project:  
**STIRLING HIGH SCHOOL**

Drawing:  
**MASTER DEED PLAN  
PHASE 8**

Scale		1:500, 1:2000	
Date	01/14	Job No.	69
Drawn By	RJ	Drawing No.	MDOC-8
		Rev.	B