

The Development registered under Titles ARG13621 and ARG13966 and Plots C and D within have been DPA approved by:  
*I MacLaren - 28 March 2018*  
**Iain MacLaren (DPA Officer)**

**DEED PLAN**  
 Sites at Victoria Park, Minard  
 by LOCHGILPHEAD  
 Area C 531.7 Sq.M or Thereby  
 Area D 853.7 Sq.M or Thereby

SCALE 1 : 1000  
 0 50m

# Minard

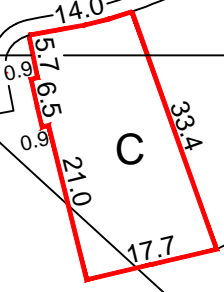
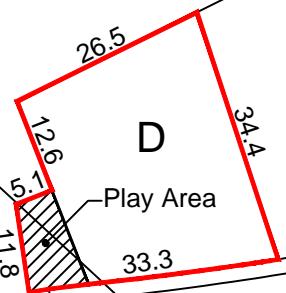
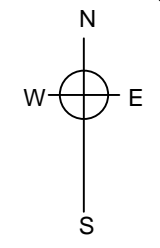

Labels on map: Ardach, Barrosa, Greenbank, Dunstanburgh, Branksea, Tigh-na-Bruaich, Grianan, Karuna, Victoria Cottages, Inver Cottage, Free Church, 5.2m, A83 Lochgilphead, MLWS, NTL, BM 4.82m, A83 Inveraray, F Sta, Tel Ex, Achagoil, Shira, Imachar, The Drovers, Upper Achdgoyle, Viewfield, Viewfield Cottage, Tigh an Uillt, FB, e, 977, 978, 979, 964, 963, 6965.00m, 6962.70m, 197620m, 197983m.