

The Development registered under title MID21487 and Flats 2, 2A, 4, 6A, 6B, 6/1, 6/2, 6/3, 6/4 and 6/5 within have been DPA approved by:

*Craig McFadden - 16 May 2022*

Craig McFadden ( DPA Officer)

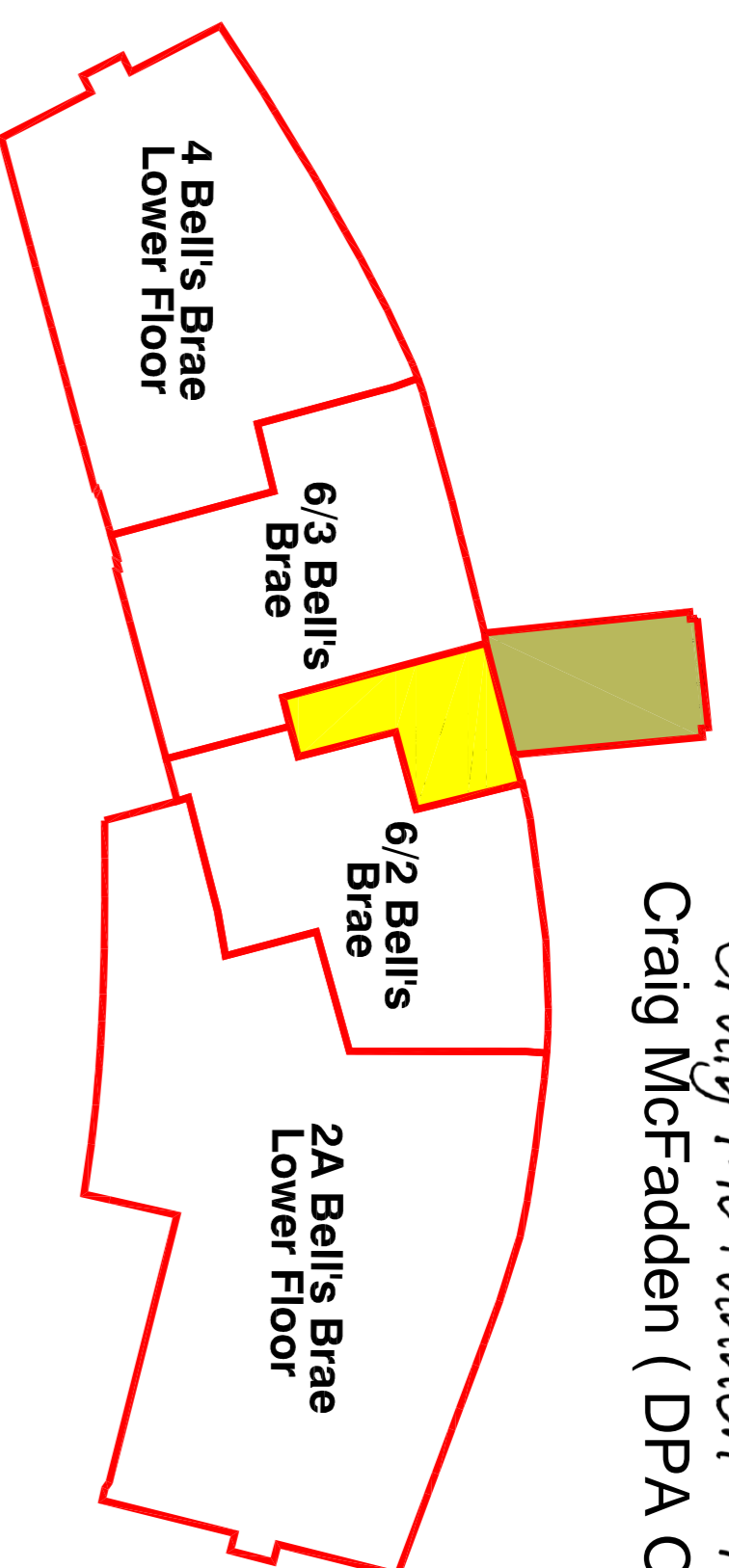

**LEVEL 1**

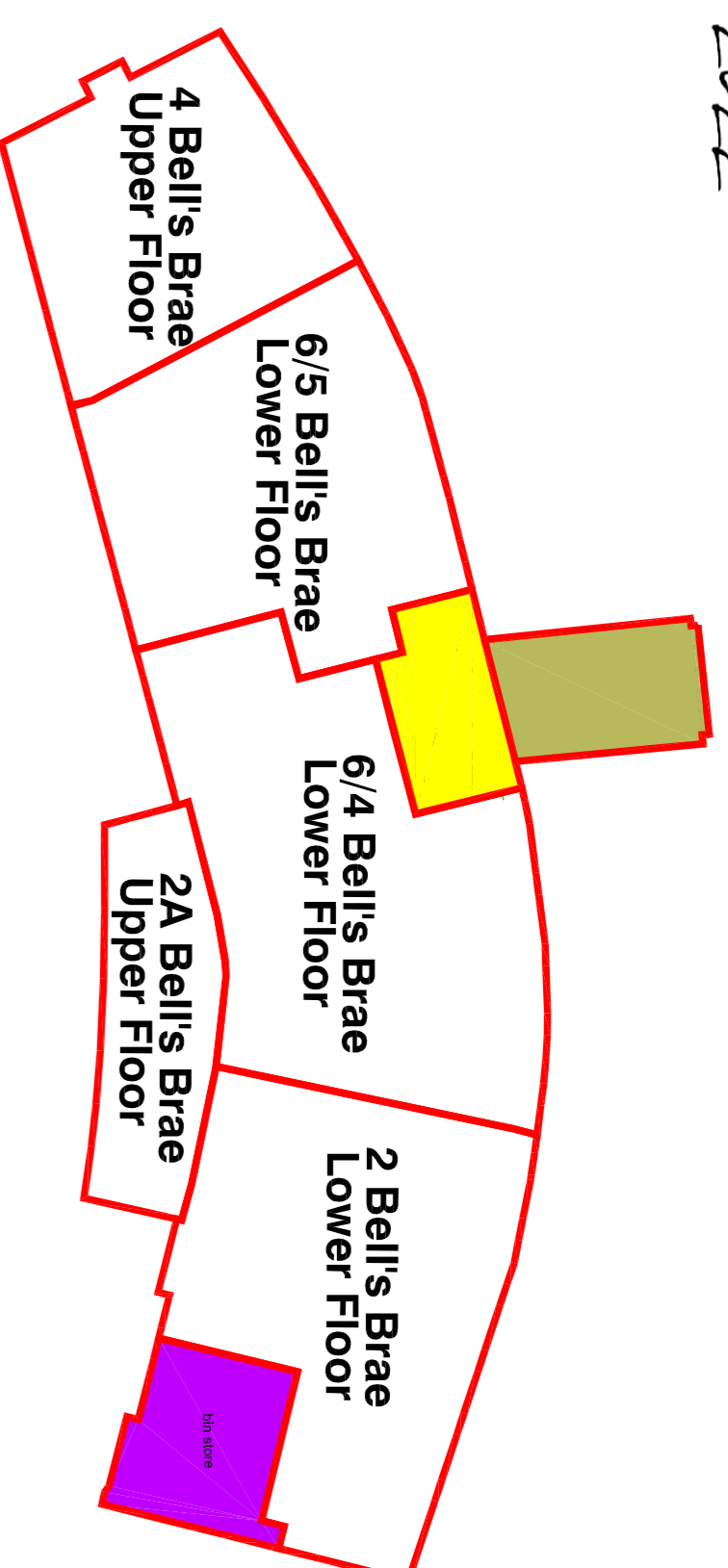



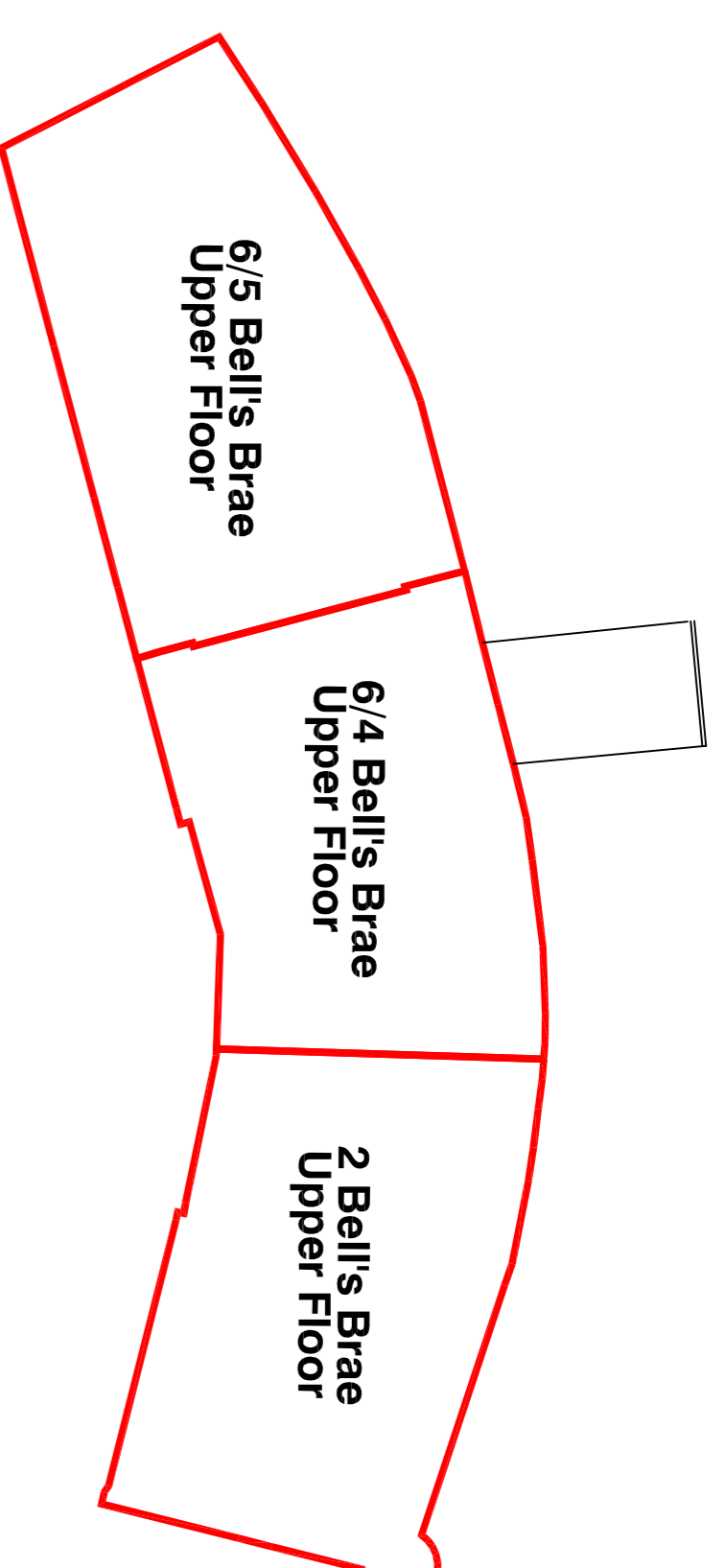



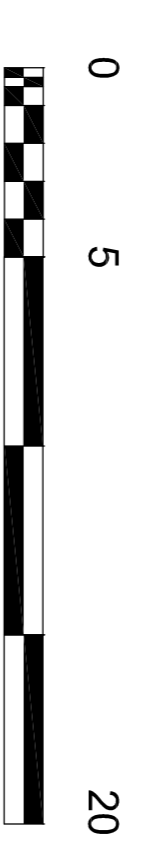
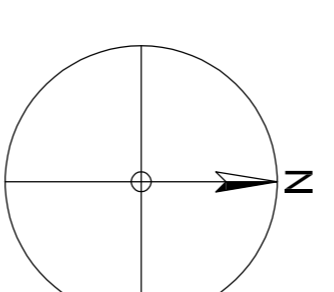
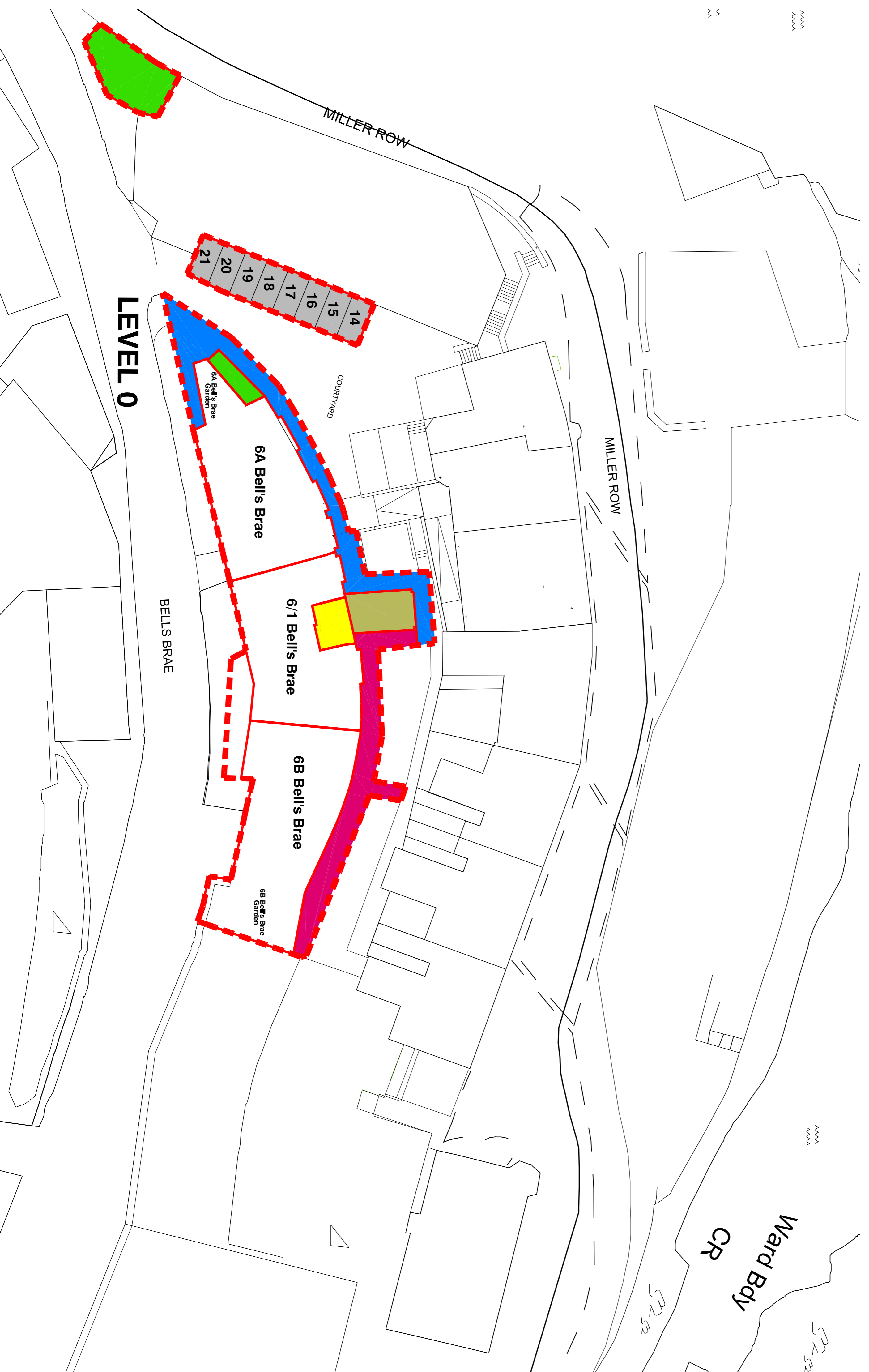

**LEVEL 2**



**LEVEL 3**

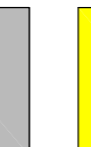

-  SITE DEVELOPMENT BOUNDARY
-  PLOT BOUNDARY
-  WEST PATH
-  COMMON BIKE STORE
-  COMMON BIN STORE
-  STAIRWELL COMMON AREA
-  LIFT LOBBY COMMON AREA
-  CAR PARKING SPACE
-  EAST PATH

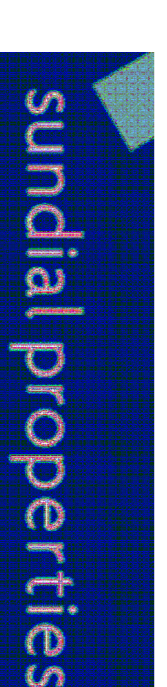

Project Title  
6 BELLS BRAE  
EDINBURGH

Drawing Title  
DPA PLAN

Scale  
1:200

Date  
17/03/2022

Drawing No.

Rev.