

Block Plots 238-246 & 247-252

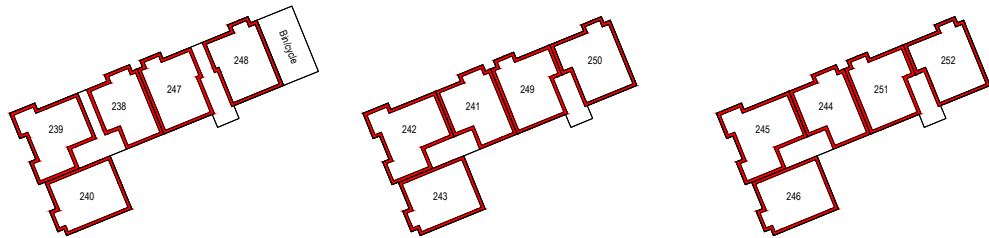

Plots 238-240 and 247-248
Ground Floor

Plots 241-243 and 249-250
First Floor

Plots 244-246 and 251-252
Second Floor

Block Plots 169-177 & 178-186

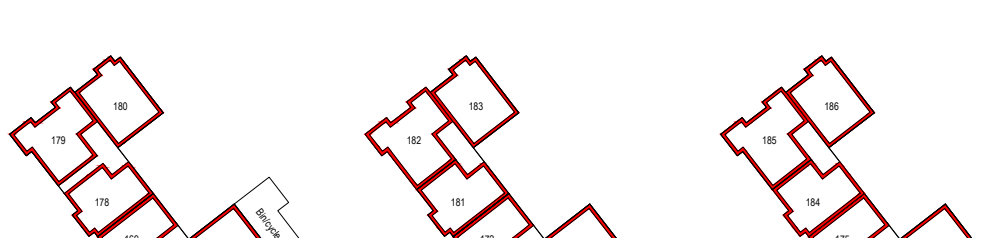

Plots 169-171 and 178-180
Ground Floor

Plots 172-174 and 181-183
First Floor

Plots 175-177 and 184-186
Second Floor

Block Plots 219-227 & 228-236

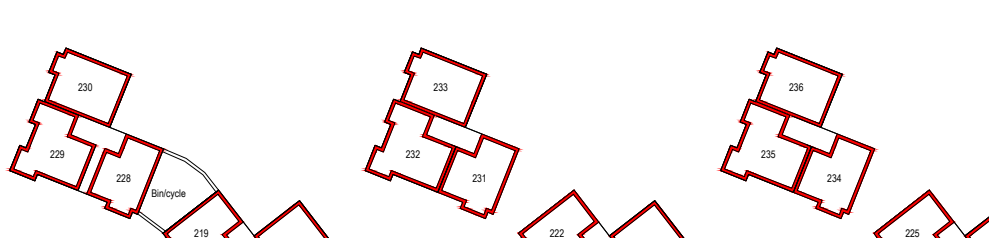

Plots 219-221 and 228-230
Ground Floor

Plots 222-224 and 231-233
First Floor

Plots 222-224 and 231-233
Second Floor

CONSENTED DEVELOPMENT
BY OTHERS
(UNDER CONSTRUCTION)

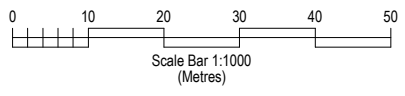

LEGEND

- Site Boundary
- Shared hardstanding 1 adopted & maintained by factor. (Orange) - Plots 146-148
- Shared hardstanding 2 adopted & maintained by factor. (Blue) - Plots 151-154
- Shared hardstanding 3 adopted & maintained by factor. (Peach cross hatch) - Plots 152-154
- Shared hardstanding 4 adopted & maintained by factor. (Cyan with black hatch) - Plots 155-157
- Shared hardstanding 5 adopted & maintained by factor. (Light Yellow) - Plots 256-257
- Shared hardstanding 6 adopted & maintained by factor. (Cyan) - Plots 275-277
- Shared hardstanding 8 adopted & maintained by factor. (Turquoise) - Plots 270-272
- Shared hardstanding 9 adopted & maintained by factor. (Brown cross hatch) - Plots 289-291
- Shared hardstanding 10 adopted & maintained by factor. (Mint Green cross hatch) - Plots 285-287
- Shared hardstanding 11 adopted & maintained by factor. (Purple) - Plots 301-302
- Shared hardstanding 12 adopted & maintained by factor. (Light Orange) - Plots 295-297 & 298-300
- Shared hardstanding 13 adopted & maintained by factor. (Light Red) - Plots 211-214
- Shared hardstanding 14 adopted & maintained by factor. (Indigo cross hatch) - Plots 216-218
- Shared hardstanding 15 adopted & maintained by factor. (Sky Blue) - Plots 187-189
- Shared hardstanding courtyard 1 adopted & maintained by factor. (Light red with black hatch) - Plots 238-252
- Shared hardstanding courtyard 2 adopted & maintained by factor. (hot pink with black hatch) - Plots 169-186
- Shared soft landscaped area, paths and bin/cycle store adopted & maintained by factor (Cyan with black hatch) - Plots 219-227 & 228-236
- Shared soft landscaped area, paths and bin/cycle store adopted & maintained by factor. (Light Yellow with black hatch) - Plots 238-252
- Shared soft landscaped area, paths and bin/cycle store adopted & maintained by factor. (Bright Yellow with black hatch) - Plots 169-186
- FibreNest distribution cabinet to be maintained by FibreNest. (Olive Green)

The development registered under
Title MID174837 and Plots 146 to 311
within have been DPA approved.

Ross Cairns - 11/11/2022

Ross Cairns (DPA Officer)

Persimmon Homes

Persimmon Homes East Scotland
Unit 1
Wester Inch Business Park
Old Well Court
Bathgate
West Lothian
EH48 2TQ
10th August 2021

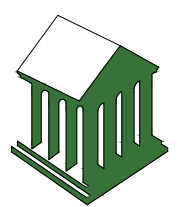

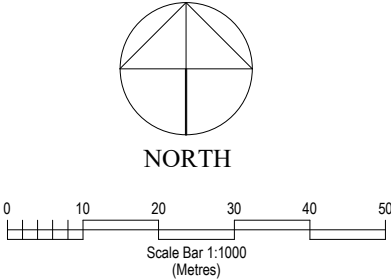

- LEGEND**
- Site Boundary
 - Roadways, footways & parking adopted and maintained by City of Edinburgh Council Roads Department.
 - Public Open space & landscaping maintained by Factor. (Green)
 - Soft landscaped service strip adopted by City of Edinburgh Council Roads department and maintained by factor. (Yellow)
 - Shared hardstanding 1 adopted & maintained by factor. (Orange) - Plots 146-148
 - Shared hardstanding 2 adopted & maintained by factor. (Blue) - Plots 151-154
 - Shared hardstanding 3 adopted & maintained by factor. (Peach cross hatch) - Plots 152-154
 - Shared hardstanding 4 adopted & maintained by factor. (Cyan with black hatch) - Plots 155-157
 - Shared hardstanding 5 adopted & maintained by factor. (Light Yellow) - Plots 256-257
 - Shared hardstanding 6 adopted & maintained by factor. (Cyan) - Plots 275-277
 - Shared hardstanding 8 adopted & maintained by factor. (Turquoise) - Plots 270-272
 - Shared hardstanding 9 adopted & maintained by factor. (Brown cross hatch) - Plots 289-291
 - Shared hardstanding 10 adopted & maintained by factor. (Mint Green cross hatch) - Plots 285-287
 - Shared hardstanding 11 adopted & maintained by factor. (Purple) - Plots 301-302
 - Shared hardstanding 12 adopted & maintained by factor. (Light Orange) - Plots 295-297 & 298-300
 - Shared hardstanding 13 adopted & maintained by factor. (Light Red) - Plots 211-214
 - Shared hardstanding 14 adopted & maintained by factor. (Indigo cross hatch) - Plots 216-218
 - Shared hardstanding 15 adopted & maintained by factor. (Sky Blue) - Plots 187-189
 - Shared hardstanding courtyard 1 adopted & maintained by factor. (Light red with black hatch) - Plots 238-252
 - Shared hardstanding courtyard 1 adopted & maintained by factor. (hot pink with black hatch) - Plots 169-186
 - Shared hardstanding courtyard 2 adopted & maintained by factor. (Orange with black hatch) - Plots 219-227 & 228-236
 - Shared soft landscaped area, paths and bin/cycle store adopted & maintained by factor (Cyan with black hatch) - Plots 219-227 & 228-236
 - Shared soft landscaped area, paths and bin/cycle store adopted & maintained by factor. (Light Yellow with black hatch) - Plots 238-252
 - Shared soft landscaped area, paths and bin/cycle store adopted & maintained by factor. (Bright Yellow with black hatch) - Plots 169-186
 - FibreNest distribution cabinet to be maintained by FibreNest. (Olive Green)

CONSENTED DEVELOPMENT
BY OTHERS
(UNDER CONSTRUCTION)

