

All levels and dimensions to be checked on site prior to construction / fabrication; report discrepancies immediately. Do not scale dimensions from this drawings. This drawing is copyright protected.

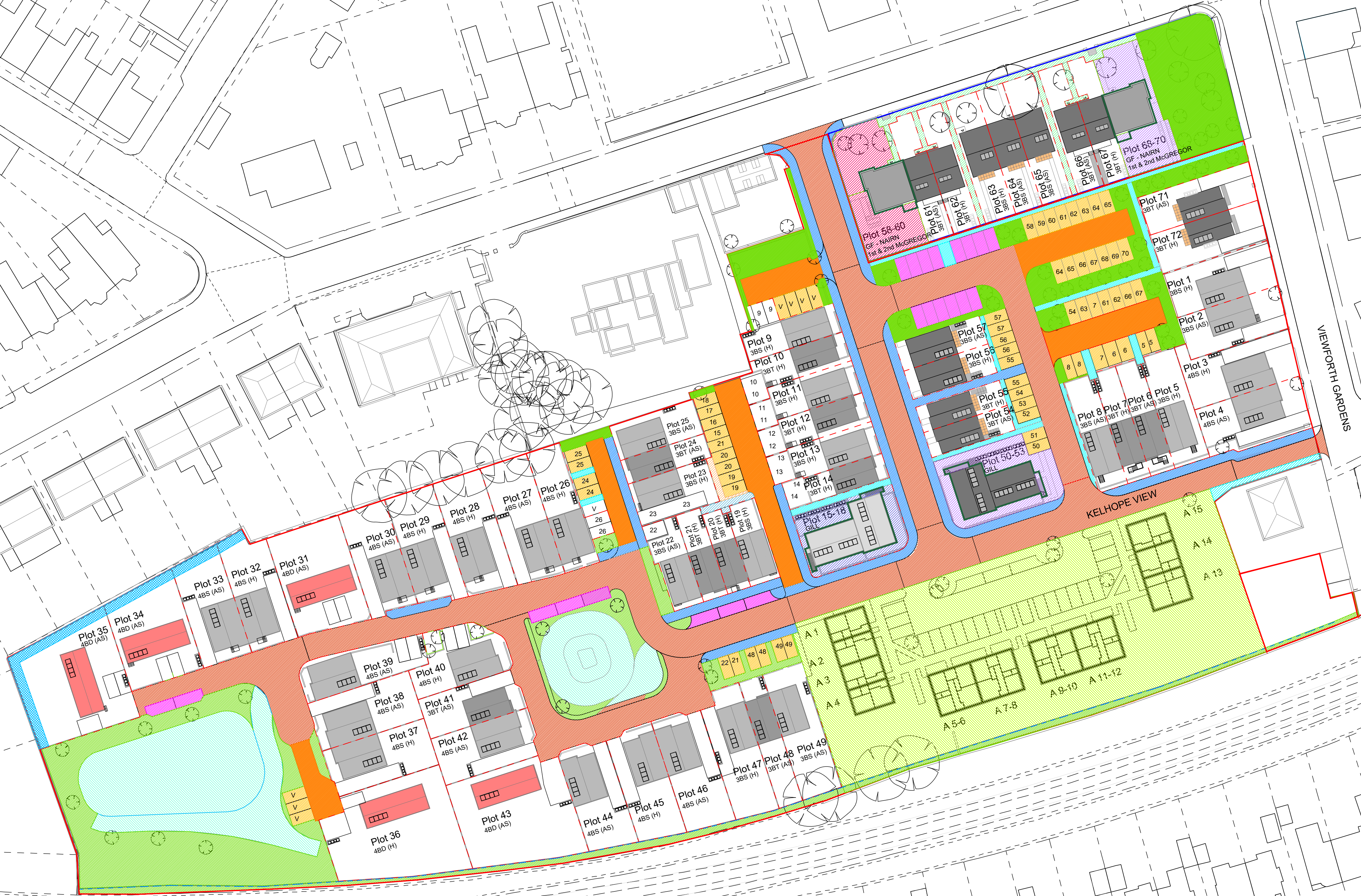

- Key
- Factored Open Space
 - Road - Adopted
 - Road - Factor
 - Footpath - Adopted
 - Footpath - Common to development
 - Parking space, Adopted, non allocated
 - Parking space factored.
 - Private path common to plots 19 - 21
 - Private path common to plots 23
 - Private paths common to plots 58 - 70
 - Land common to plots 15 - 18
 - Land common to plots 50 - 53
 - Land common to plots 58 - 60
 - Land common to plots 68 - 70
 - Kingdom Housing Association
 - Scottish Water
 - 2m BT wayleave for overhead cables
 - Line of acoustic fence

Rev	Date	Reason for issue	By	Chk
E	29/01/25	Parking bays plot 15-25 amended	RTB	TJ
D	16/06/23	Parking bays plot 7 / 54 amended	RTB	TJ
C	16/05/23	Parking bay next to plot 26 amended	JW	RTB
B	06/04/22	Common space and parking amended	RTB	Emc
A	11/03/22	Parking allocation amended to school site, plot 22 & 23 noted	JW	RTB

The Development registered under title FFE134824 and plots 9 to 25, 30, 40, 42, 45 to 53 and 58 to 70 within have been DPA approved.

The Keeper - 17 April 2025

Keeper for the Registers of Scotland

Do not scale drawings. Dimensions govern.
All dimensions to be checked on site before proceeding with the work.
Whiteburn shall be notified in writing of any discrepancies.



Clock Tower
1 Jackson's Entry
Edinburgh EH8 8PJ
T +44 (0)131 558 2710

www.whiteburn.co.uk

Client:	NA
Project:	Viewforth High School Kirkcaldy
Drawing:	Site Development Plan Deed Plan
Scale:	1:500 @ A1
Purpose of issue:	DOC
Drawn by:	JW
Drawing No:	VF/LG/10
	E