

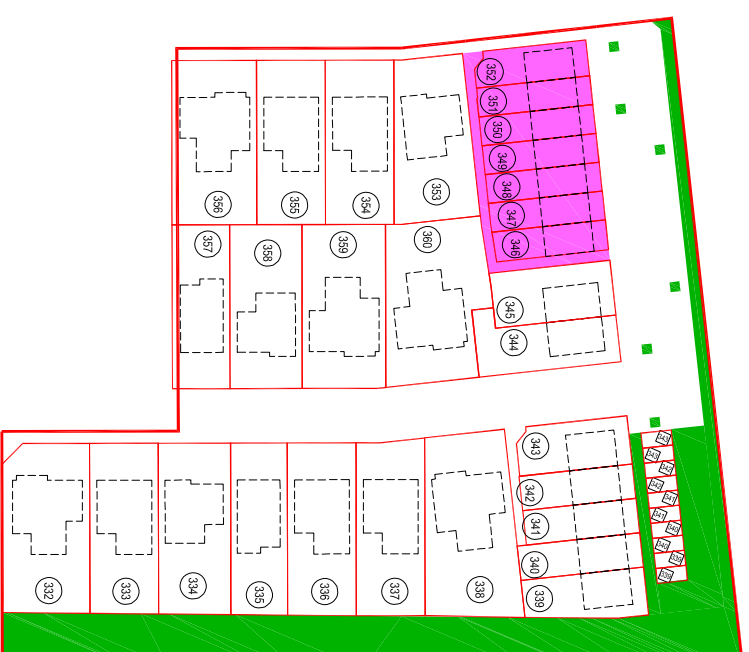





The Development registered under Title MID169598 and plots 332 to 345 and 353 to 360 within have been DPA approved by:

*D. McIntyre - 9th March 2021*

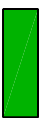
Danielle McIntyre (DPA Officer)



	PHASE 5 BOUNDARY
	SOFT & HARD LANDSCAPING AND POS INCLUDING REMOTE WALLS / FENCES / GATES TO BE MAINTAINED BY FACTOR ON BEHALF OF THE CLIENTS
	AFFORDABLE HOUSING - (PLOTS 346-352)
	PLOT NUMBERS
	PRIVATE PARKING (ALLOCATED)

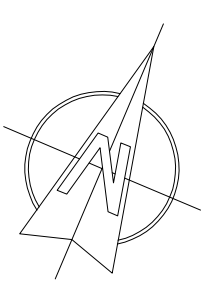
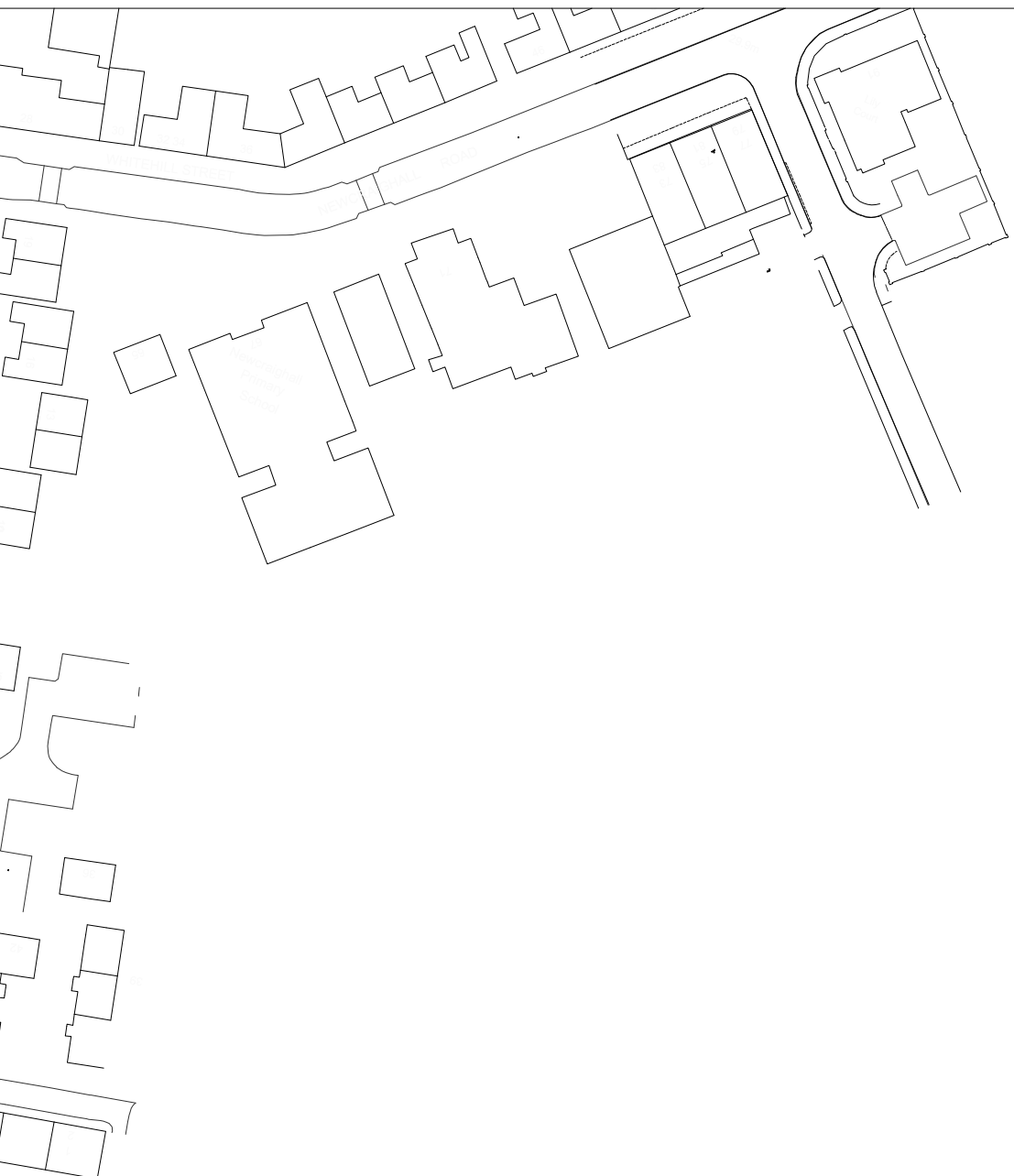
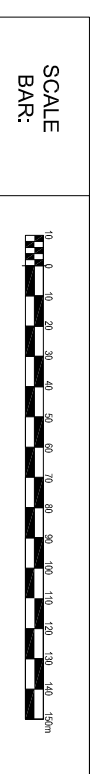

REV	DATE	BY	AMENDMENTS

**AVANT**  
homes

Avant Homes  
Aryll Court,  
The Castle Business Park  
Strifling, RG9 4TT  
Tel: 01784 477777  
Fax: 01784 77866  
www.avanthomes.co.uk

SPROJECT/00-033 - Balfour Park, Newcraighall 02 Architectural Legal Plans/DPA/Pha

DATE: Mar 21 SCALE: 1:1250 @ A3 DRAWN BY: SAR

DWG TITLE: PHASE 5 INTERNAL DPA PLAN

PROJECT: BALFOUR PARK  
NEWCRAIGHALL  
DWG No. NSE/DPA/007 Rev.