

© This drawing is Copyright and the property of Cruden Homes (East) Ltd
It may not be reproduced or disclosed to a third party without written consent.

HEAD ROAD

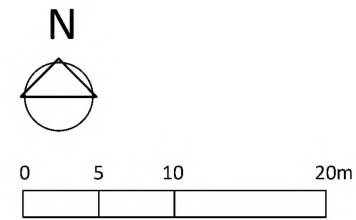
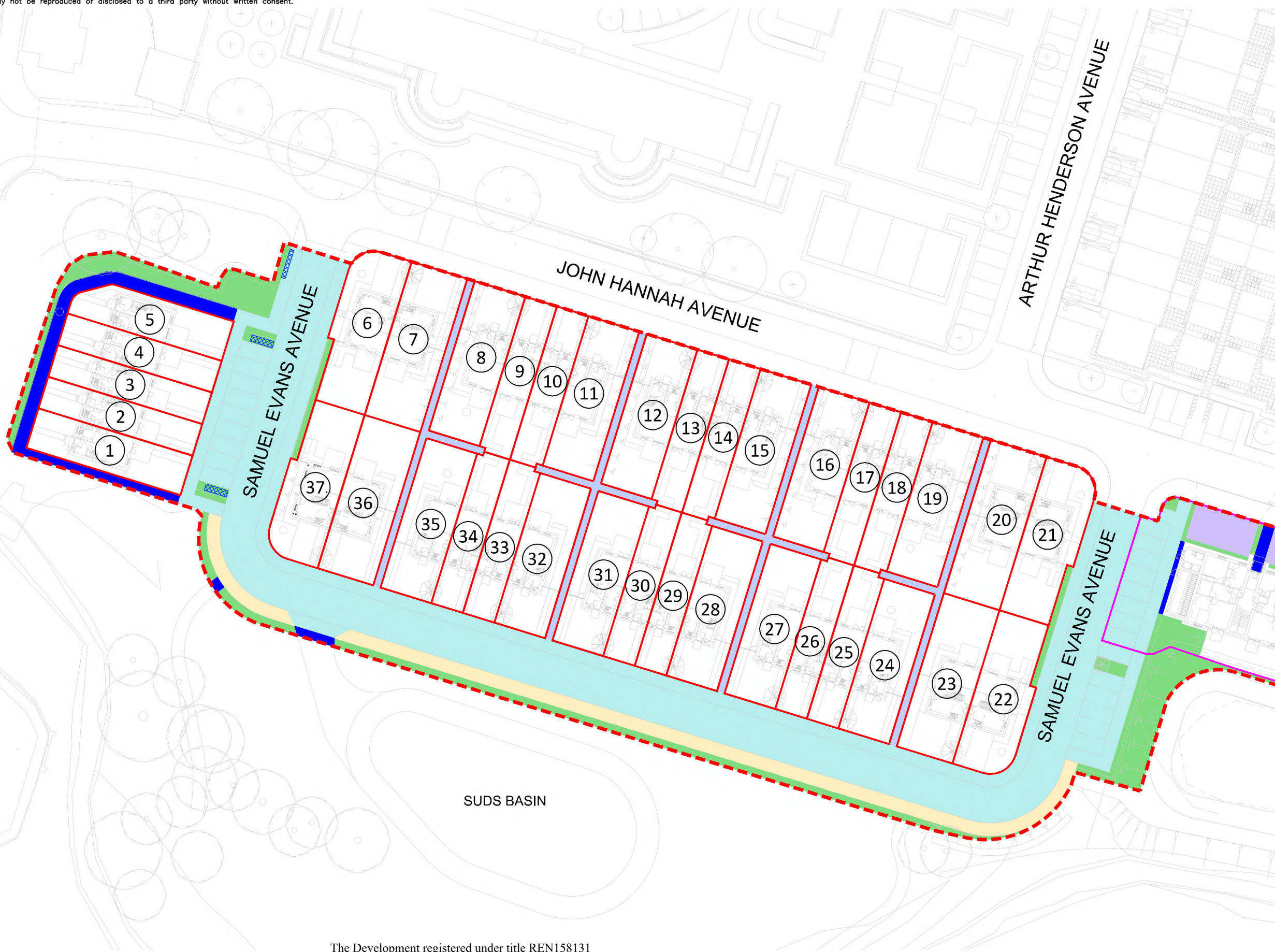

- Development boundary
- Plot boundary
- Housing Association boundary
- Section 14 to be adopted and maintained by factor
- Open space to be adopted and maintained by factor
- SUDS basin to be adopted and maintained by Scottish Water
- Stairwells, footways & roads to be adopted and maintained by factor
- Carparking to be adopted and maintained by factor
- Footways, carparking and roads to be pro-indiviso share
- Service strip to be adopted by Renfrewshire Council but maintained by factor
- Carriageway to be adopted and maintained by Renfrewshire Council
- Open ground
- Filtration trench (adoptable by Council)
- Right of Way

The Development registered under title REN158131
and plots 1 to 37 within have been DPA approved.

The Keeper - 16 May 2024

Keeper for the Registers of Scotland

A LP STREET NAMING UPDATED 24/06/24

Rev By Details Date

Project	Hawkhead, phases 12-14	Drawing No.	1714(LG)001	Rev	A
Drawing	Development Plan Approval and Deed of Conditions Plan (1 of 2)	Status	INFORMATION		
Scale	1:600 @ A3	Drawn	KH	Date	23/11/23

cruden HOMES
Firm foundations, flexible living
CRUDEN HOMES (EAST) LIMITED
CRUDEN HOUSE, 36 SOUTH GYLE CRESCENT,
EDINBURGH, EH12 9EB TEL 0131 285 6600

© This drawing is Copyright and the property of Cruden Homes (East) Ltd
It may not be reproduced or disclosed to a third party without written consent.

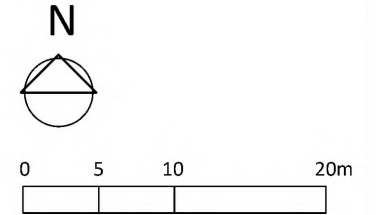

- Development boundary
- Plot boundary
- Housing Association boundary
- Section 14 to be adopted and maintained by factor
- Open space to be adopted and maintained by factor
- SUDS basin to be adopted and maintained by Scottish Water
- Stairwells, footways & roads to be adopted and maintained by factor
- Carparking to be adopted and maintained by factor
- Footways, carparking and roads to be pro-indiviso share
- Service strip to be adopted by Refrewshire Council but maintained by factor
- Carriageway to be adopted and maintained by Renfrewshire Council
- Open ground
- Filtration trench (adoptable by Council)
- Right of Way

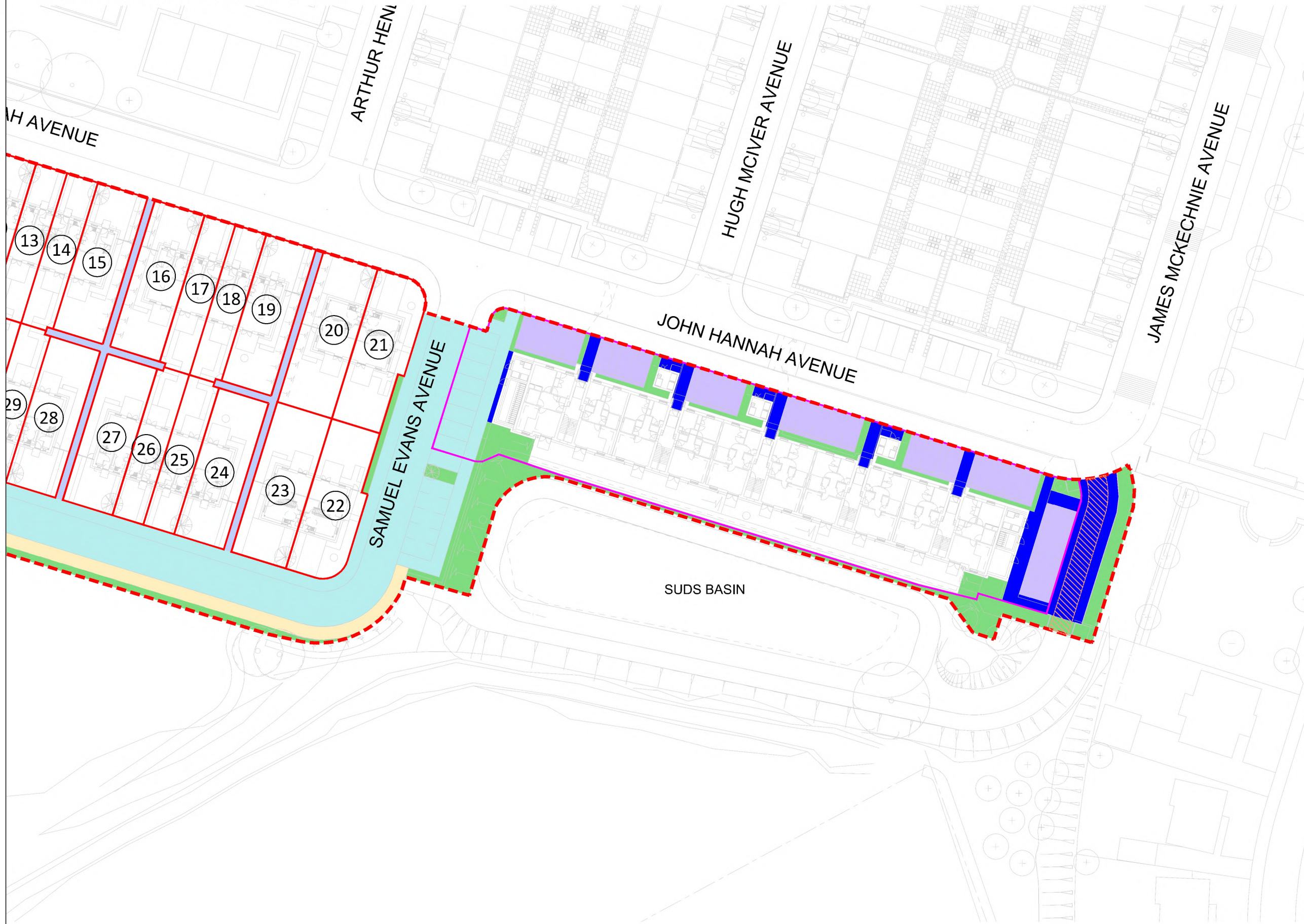

A	LP STREET NAMING UPDATED	24/06/24
Rev	Bv Details	Date

Project	Hawkhead, phaseS 12-14	Drawing No.	1714(LG)002	Rev	A
Drawing	Development Approval Plan and Deed of Conditions Plan (2 of 2)	Status	INFORMATION		
Scale	1:600 @ A3	Drawn	KH	Date	23/11/23

cruden HOMES
Firm foundations, flexible living
CRUDEN HOMES (EAST) LIMITED
CRUDEN HOUSE, 36 SOUTH GYLE CRESCENT,
EDINBURGH, EH12 9EB TEL 0131 285 6600