

The Development registered under title
REN157580 and plots 1 to 30 within
have been DPA approved.

The Keeper – 13 November 2024

Keeper for the Registers of Scotland

MADEIRA STREET

NEWARK STREET

KEY

- TITLE BOUNDARY (RED)
- BLOCK PARKING SPACES (TURQUOISE)
- FRONT GARDENS (GREEN)
- ATTENUATION TANK (DOTTED BLUE)
- LANDSCAPED OPEN SPACES (DARK GREEN)
- PRIVATE PARKING COURT ACCESS (ORANGE)
- VISITOR PARKING SPACES (BLUE)
- ROADS AND PATHS (GREY)
- GAS GOVERNOR (PINK)

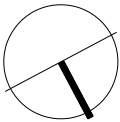

APPLICABLE REGULATIONS
CDM 2015 & HASAW ACT 1974 (and all amendments) - Applies at all times.
Working at height Regs 2005 - Applies at all times.
Workplace (Health, Safety and Welfare) Regs 1992 - Applies at all times.
Control of Asbestos Regs 2012 - Applies at all times.

Notes

Rev	Description	Date	Issued
A	Red line updated	Dec 23	RH
C3	Updated for rear path addition	Oct 24	RH

0 2.5 5 10 15 20
SCALE (M) 1:500

51 St Vincent Crescent
Glasgow
G3 8NQ

T 0141 221 6834
E mast@mastarchitects.co.uk
W mastarchitects.co.uk



MASTARCH Ltd trading as MAST Architects registered in Scotland, company number SC447111, whose registered office is at 51 St Vincent Crescent, Glasgow, G3 8NQ

DO NOT SCALE FROM DRAWINGS
All dimensions to be checked on site by the Contractor and any discrepancies to be notified to the Architect prior to works being commenced. Use Figured dimensions only.

©All Rights Reserved. Copyright in all documents and drawings prepared by MAST Architects and in any work executed from those documents and drawings shall remain the property of MAST Architects.

Client

CCG Homes (Ltd)

Scale	Sheet Size	Job No.
1:500	A3	3333
Originator	Checked	Date
RH	-	Nov 23

Project

Madeira Street,
Greenock

Drawing Title	Rev
Deed of Condition	A5-C3

Drawing No.
3333-MST-S1-
GF-D-A-PM_40_40_15-1720



- PLOT TITLE BOUNDARY**
- PARKING SPACE TO PLOT (HATCHED BLUE)**
- GARDEN AREA TO PLOT (HATCHED GREEN)**

APPLICABLE REGULATIONS

CDM 2015 & HASAW ACT 1974 (and all amendments) - Applies at all times.

Working at height Regs 2005 - Applies at all times.

Workplace (Health, Safety and Welfare) Regs 1992 - Applies at all times.

Control of Asbestos Regs 2012 - Applies at all times.

Notes

Rev	Description	Date	Issued
C2	Updated for rear path addition	Oct 24	RH



51 St Vincent Crescent
Glasgow
G3 8NQ

T 0141 221 6834
E mast@mastarchitects.co.uk
W mastarchitects.co.uk



MASTARCH Ltd trading as MAST Architects registered in Scotland, company number SC447111, whose registered office is at 51 St Vincent Crescent, Glasgow, G3 8NQ

DO NOT SCALE FROM DRAWINGS
All dimensions to be checked on site by the Contractor and any discrepancies to be notified to the Architect prior to works being commenced. Use Figured dimensions only.

©All Rights Reserved. Copyright in all documents and drawings prepared by MAST Architects and in any work executed from those documents and drawings shall remain the property of MAST Architects.

Client
CCG Homes (Ltd)

Scale	Sheet Size	Job No.
1:200	A3	3333

Originator	Checked	Date
RH	-	Nov 23

Project
**Madeira Street,
Greenock**

Drawing Title	Rev
Plot 1 - Title Deed	A5-C2

Drawing No.
**3333-MST-S1-
GF-D-A-PM_40_40_15-1721**

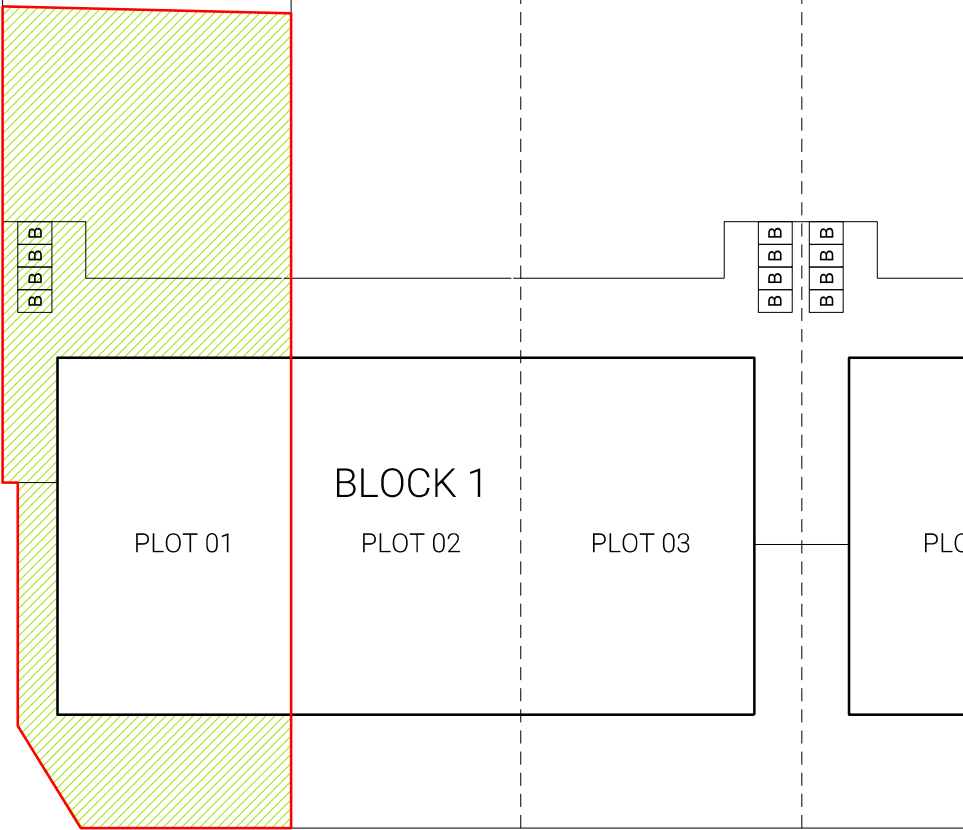
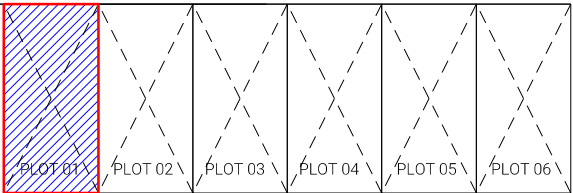
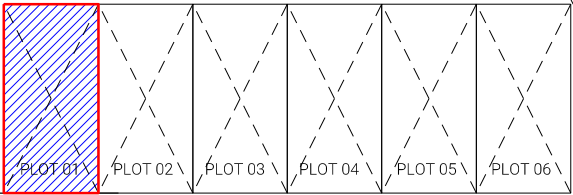



- PLOT TITLE BOUNDARY
- PARKING SPACE TO PLOT (HATCHED BLUE)
- GARDEN AREA TO PLOT (HATCHED GREEN)

APPLICABLE REGULATIONS

CDM 2015 & HASAW ACT 1974 (and all amendments) - Applies at all times.
Working at height Regs 2005 - Applies at all times.
Workplace (Health, Safety and Welfare) Regs 1992 - Applies at all times.
Control of Asbestos Regs 2012 - Applies at all times.

Notes

Rev	Description	Date	Issued
C2	Updated for rear path addition	Oct 24	RH



51 St Vincent Crescent
Glasgow
G3 8NQ

T 0141 221 6834
E mast@mastarchitects.co.uk
W mastarchitects.co.uk



MASTARCH Ltd trading as MAST Architects registered in Scotland, company number SC447111, whose registered office is at 51 St Vincent Crescent, Glasgow, G3 8NQ

DO NOT SCALE FROM DRAWINGS
All dimensions to be checked on site by the Contractor and any discrepancies to be notified to the Architect prior to works being commenced. Use Figured dimensions only.

©All Rights Reserved. Copyright in all documents and drawings prepared by MAST Architects and in any work executed from those documents and drawings shall remain the property of MAST Architects.

Client

CCG Homes (Ltd)

Scale	Sheet Size	Job No.
1:200	A3	3333

Originator	Checked	Date
RH	-	Nov 23

Project
Madeira Street,
Greenock

Drawing Title	Rev
Plot 2 - Title Deed	A5-C2

Drawing No.
3333-MST-S1-
GF-D-A-PM_40_40_15-1722



- PLOT TITLE BOUNDARY
- PARKING SPACE TO PLOT (HATCHED BLUE)
- GARDEN AREA TO PLOT (HATCHED GREEN)

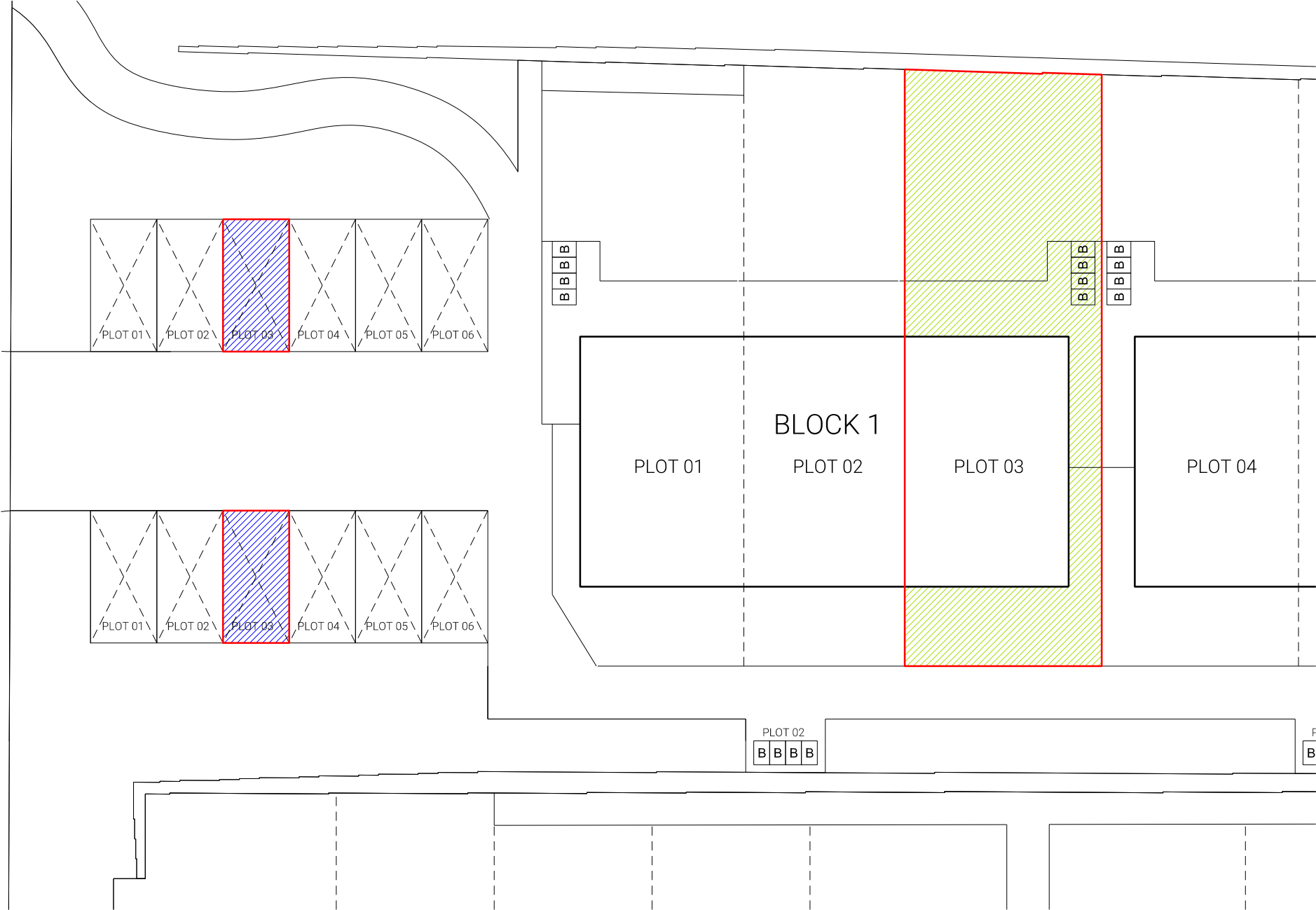

APPLICABLE REGULATIONS
CDM 2015 & HASAW ACT 1974 (and all amendments) - Applies at all times.
Working at height Regs 2005 - Applies at all times.
Workplace (Health, Safety and Welfare) Regs 1992 - Applies at all times.
Control of Asbestos Regs 2012 - Applies at all times.

Notes			
Rev	Description	Date	Issued
C2	Updated for rear path addition	Oct 24	RH

0 1 2 4 6 8
SCALE (M) 1:200

51 St Vincent Crescent
Glasgow
G3 8NQ

T 0141 221 6834
E mast@mastarchitects.co.uk
W mastarchitects.co.uk

MAST
ARCHITECTS

MASTARCH Ltd trading as MAST Architects registered in Scotland, company number SC447111, whose registered office is at 51 St Vincent Crescent, Glasgow, G3 8NQ

DO NOT SCALE FROM DRAWINGS
All dimensions to be checked on site by the Contractor and any discrepancies to be notified to the Architect prior to works being commenced. Use Figured dimensions only.

©All Rights Reserved. Copyright in all documents and drawings prepared by MAST Architects and in any work executed from those documents and drawings shall remain the property of MAST Architects.

Client
CCG Homes (Ltd)

Scale	Sheet Size	Job No.
1:200	A3	3333

Originator	Checked	Date
RH	-	Nov 23

Project
**Madeira Street,
Greenock**

Drawing Title	Rev
Plot 3 - Title Deed	A5-C2

Drawing No.
**3333-MST-S1-
GF-D-A-PM_40_40_15-1723**



PLOT TITLE BOUNDARY



PARKING SPACE TO PLOT (HATCHED BLUE)



GARDEN AREA TO PLOT (HATCHED GREEN)

APPLICABLE REGULATIONS

CDM 2015 & HASAW ACT 1974 (and all amendments) - Applies at all times.
Working at height Regs 2005 - Applies at all times.
Workplace (Health, Safety and Welfare) Regs 1992 - Applies at all times.
Control of Asbestos Regs 2012 - Applies at all times.

Notes

Rev	Description	Date	Issued
C2	Updated for rear path addition	Oct 24	RH

0 1 2 4 6 8
SCALE (M) 1:200

51 St Vincent Crescent
Glasgow
G3 8NQ

T 0141 221 6834
E mast@mastarchitects.co.uk
W mastarchitects.co.uk



MASTARCH Ltd trading as MAST Architects registered in Scotland, company number SC447111, whose registered office is at 51 St Vincent Crescent, Glasgow, G3 8NQ

DO NOT SCALE FROM DRAWINGS
All dimensions to be checked on site by the Contractor and any discrepancies to be notified to the Architect prior to works being commenced. Use Figured dimensions only.

©All Rights Reserved. Copyright in all documents and drawings prepared by MAST Architects and in any work executed from those documents and drawings shall remain the property of MAST Architects.

Client

CCG Homes (Ltd)

Scale 1:200 Sheet Size A3 Job No. 3333

Originator RH Checked - Date Nov 23

Project

Madeira Street,
Greenock

Drawing Title Plot 4 - Title Deed Rev A5-C2

Drawing No. 3333-MST-S1-GF-D-A-PM_40_40_15-1724

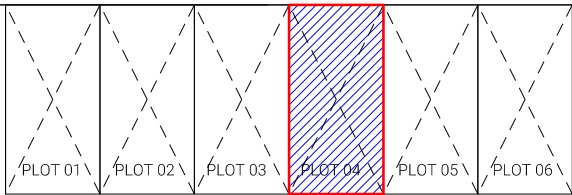
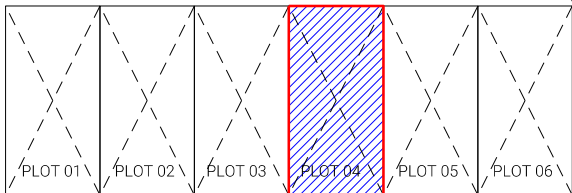

B B B B

B B B B

B B B B

PLOT 01 BLOCK 1 PLOT 02 PLOT 03

PLOT 04 BLOCK 2 PLOT 05

PLOT 02
B B B B

PLOT 05
B B B B



- PLOT TITLE BOUNDARY**
- PARKING SPACE TO PLOT (HATCHED BLUE)**
- GARDEN AREA TO PLOT (HATCHED GREEN)**

APPLICABLE REGULATIONS

CDM 2015 & HASAW ACT 1974 (and all amendments) - Applies at all times.

Working at height Regs 2005 - Applies at all times.

Workplace (Health, Safety and Welfare) Regs 1992 - Applies at all times.

Control of Asbestos Regs 2012 - Applies at all times.

Notes			
Rev	Description	Date	Issued
C2	Updated for rear path addition	Oct 24	RH



51 St Vincent Crescent
Glasgow
G3 8NQ

T 0141 221 6834
E mast@mastarchitects.co.uk
W mastarchitects.co.uk

MAST
ARCHITECTS

MASTARCH Ltd trading as MAST Architects registered in Scotland, company number SC447111, whose registered office is at 51 St Vincent Crescent, Glasgow, G3 8NQ

DO NOT SCALE FROM DRAWINGS
All dimensions to be checked on site by the Contractor and any discrepancies to be notified to the Architect prior to works being commenced. Use Figured dimensions only.

©All Rights Reserved. Copyright in all documents and drawings prepared by MAST Architects and in any work executed from those documents and drawings shall remain the property of MAST Architects.

Client		
CCG Homes (Ltd)		
Scale	Sheet Size	Job No.
1:200	A3	3333
Originator	Checked	Date
RH	-	Nov 23
Project		
Madeira Street, Greenock		
Drawing Title	Rev	
Plot 5 - Title Deed	A5-C2	
Drawing No.		
3333-MST-S1- GF-D-A-PM 40 40 15-1725		

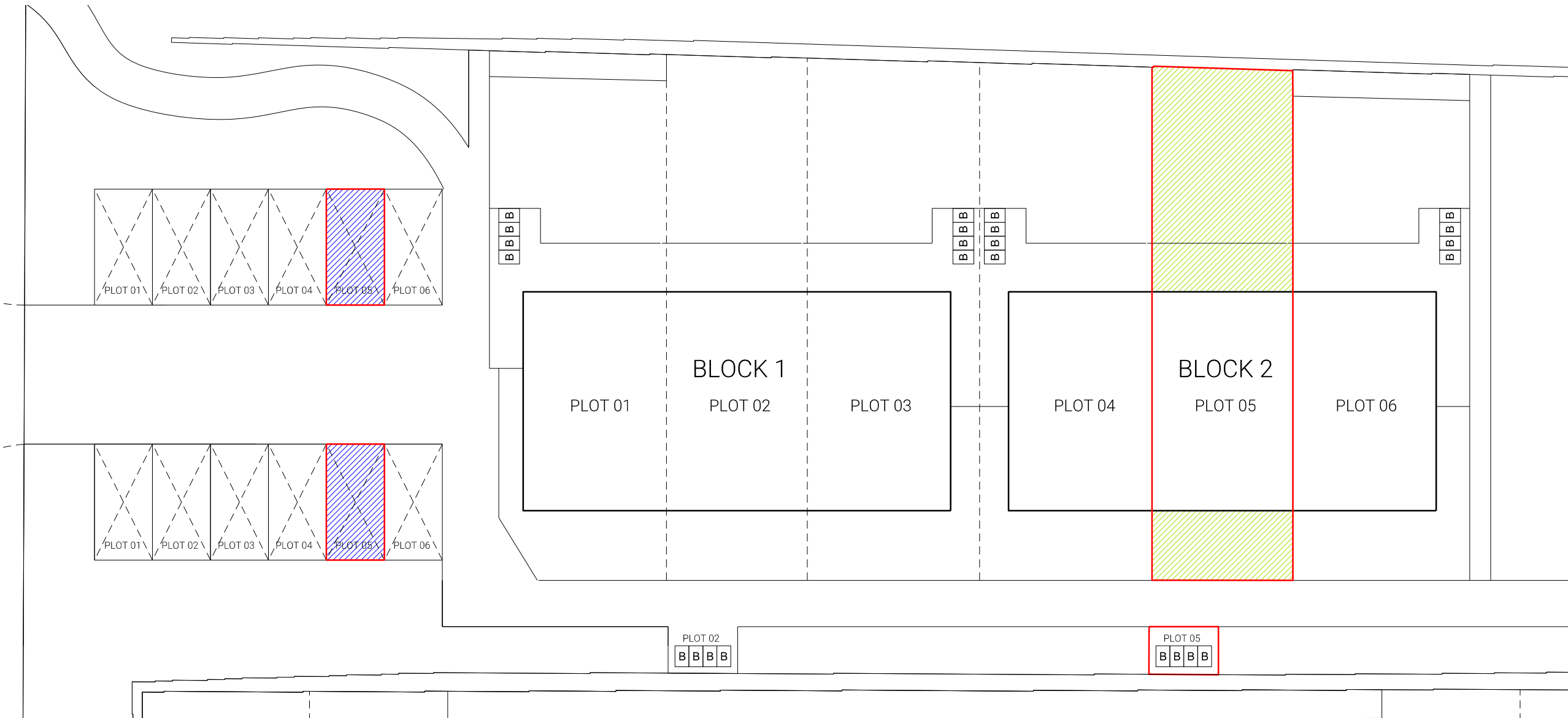



- PLOT TITLE BOUNDARY**
- PARKING SPACE TO PLOT (HATCHED BLUE)**
- GARDEN AREA TO PLOT (HATCHED GREEN)**

APPLICABLE REGULATIONS

CDM 2015 & HASAW ACT 1974 (and all amendments) - Applies at all times.

Working at height Regs 2005 - Applies at all times.

Workplace (Health, Safety and Welfare) Regs 1992 - Applies at all times.

Control of Asbestos Regs 2012 - Applies at all times.

Notes			
Rev	Description	Date	Issued
C2	Updated for rear path addition	Oct 24	RH



51 St Vincent Crescent
Glasgow
G3 8NQ

T 0141 221 6834
E mast@mastarchitects.co.uk
W mastarchitects.co.uk

MAST
ARCHITECTS

MASTARCH Ltd trading as MAST Architects registered in Scotland, company number SC447111, whose registered office is at 51 St Vincent Crescent, Glasgow, G3 8NQ

DO NOT SCALE FROM DRAWINGS
All dimensions to be checked on site by the Contractor and any discrepancies to be notified to the Architect prior to works being commenced. Use Figured dimensions only.

©All Rights Reserved. Copyright in all documents and drawings prepared by MAST Architects and in any work executed from those documents and drawings shall remain the property of MAST Architects.

Client		
CCG Homes (Ltd)		
Scale	Sheet Size	Job No.
1:200	A3	3333
Originator	Checked	Date
RH	-	Nov 23
Project		
Madeira Street, Greenock		
Drawing Title	Rev	
Plot 6 - Title Deed	A5-C2	
Drawing No.		
3333-MST-S1- GF-D-A-PM_40_40_15-1726		

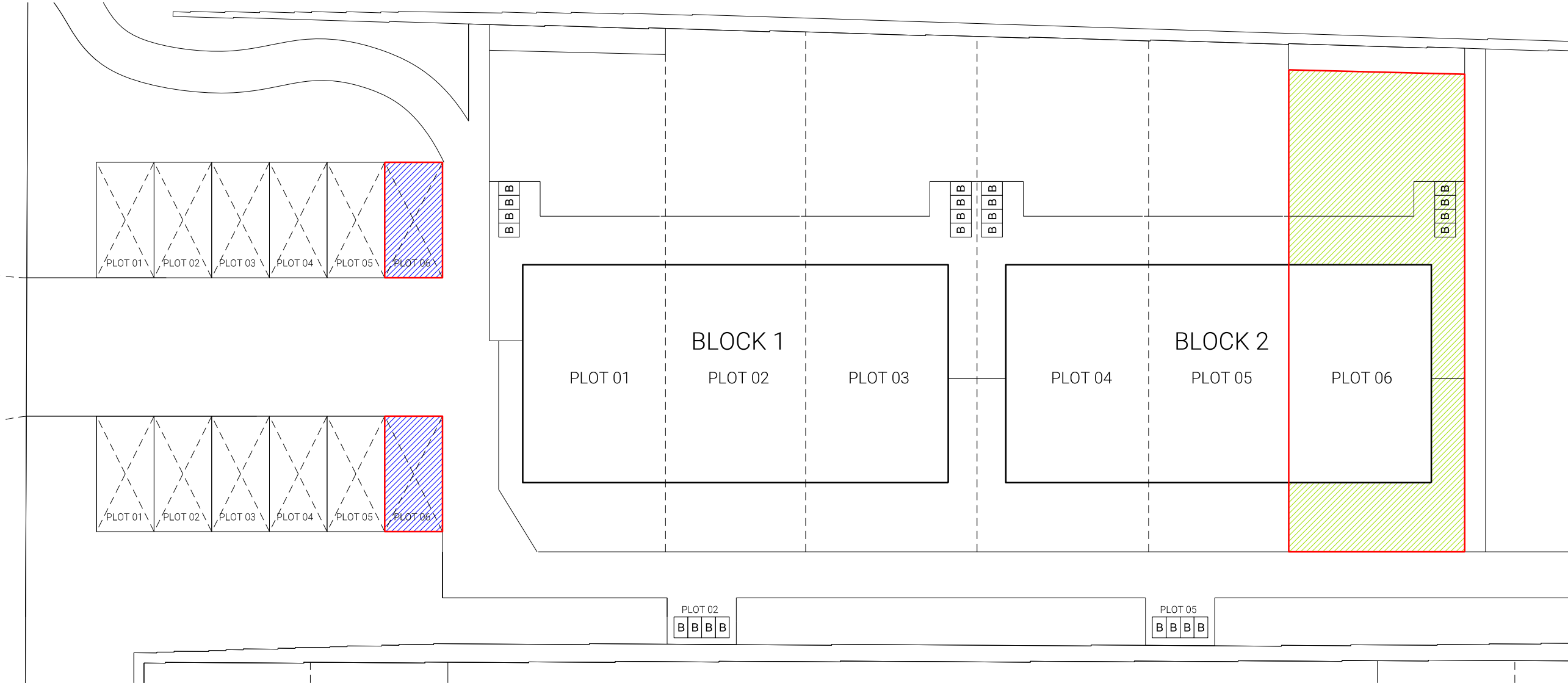



MADEIRA STREET

- PLOT TITLE BOUNDARY
- PARKING SPACE TO PLOT (HATCHED BLUE)
- GARDEN AREA TO PLOT (HATCHED GREEN)

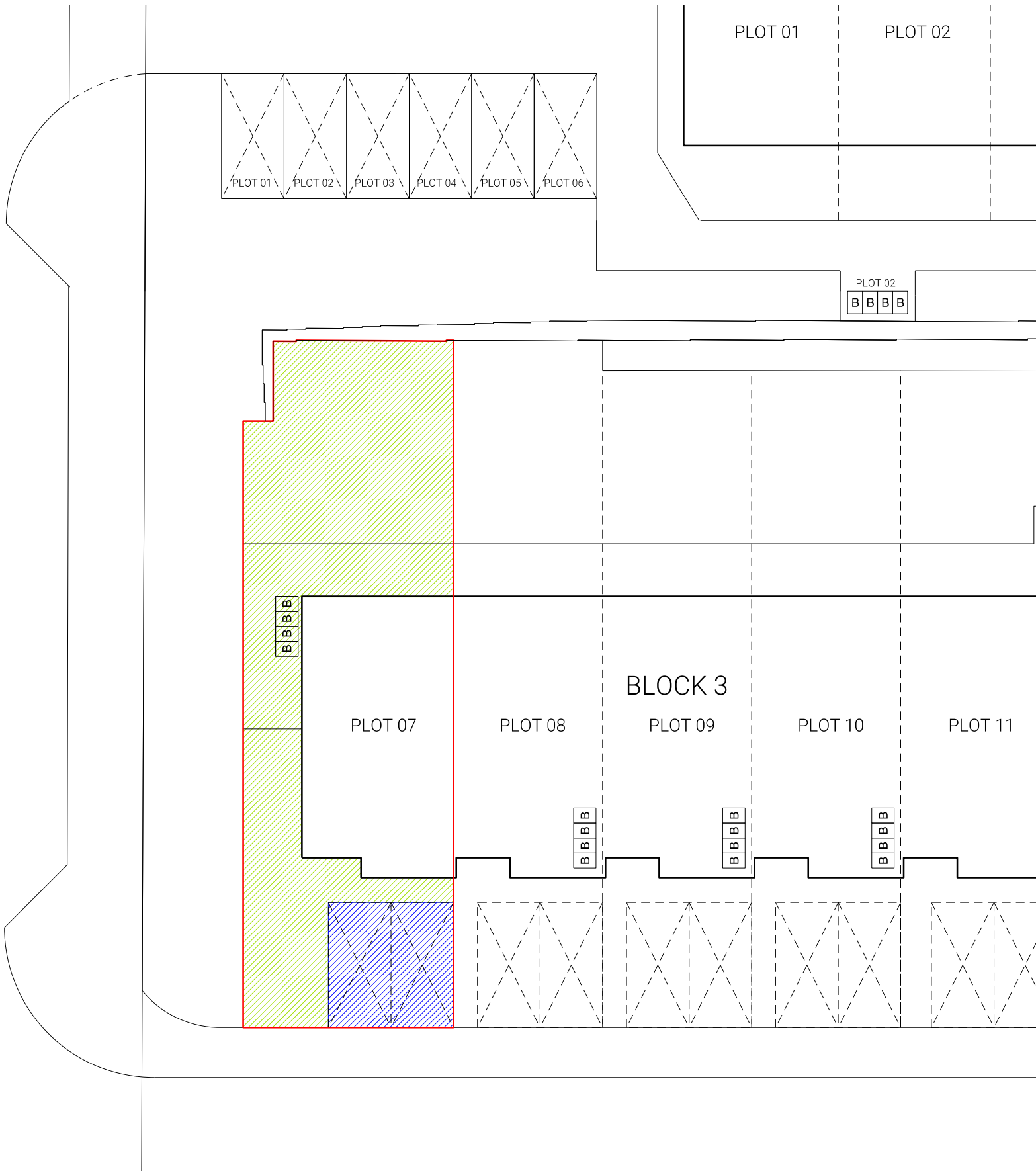

APPLICABLE REGULATIONS
CDM 2015 & HASAW ACT 1974 (and all amendments) - Applies at all times.
Working at height Regs 2005 - Applies at all times.
Workplace (Health, Safety and Welfare) Regs 1992 - Applies at all times.
Control of Asbestos Regs 2012 - Applies at all times.

Notes

Rev	Description	Date	Issued
C2	Updated for rear path addition	Oct 24	RH

0 1 2 4 6 8
SCALE (M) 1:200

51 St Vincent Crescent
Glasgow
G3 8NQ

T 0141 221 6834
E mast@mastarchitects.co.uk
W mastarchitects.co.uk



MASTARCH Ltd trading as MAST Architects registered in Scotland, company number SC447111, whose registered office is at 51 St Vincent Crescent, Glasgow, G3 8NQ

DO NOT SCALE FROM DRAWINGS
All dimensions to be checked on site by the Contractor and any discrepancies to be notified to the Architect prior to works being commenced. Use Figured dimensions only.

©All Rights Reserved. Copyright in all documents and drawings prepared by MAST Architects and in any work executed from those documents and drawings shall remain the property of MAST Architects.

Client

CCG Homes (Ltd)

Scale	Sheet Size	Job No.
1:200	A3	3333

Originator	Checked	Date
RH	-	Nov 23

Project
Madeira Street,
Greenock

Drawing Title	Rev
Plot 7 - Title Deed	A5-C2

Drawing No.
3333-MST-S1-
GF-D-A-PM_40_40_15-1727

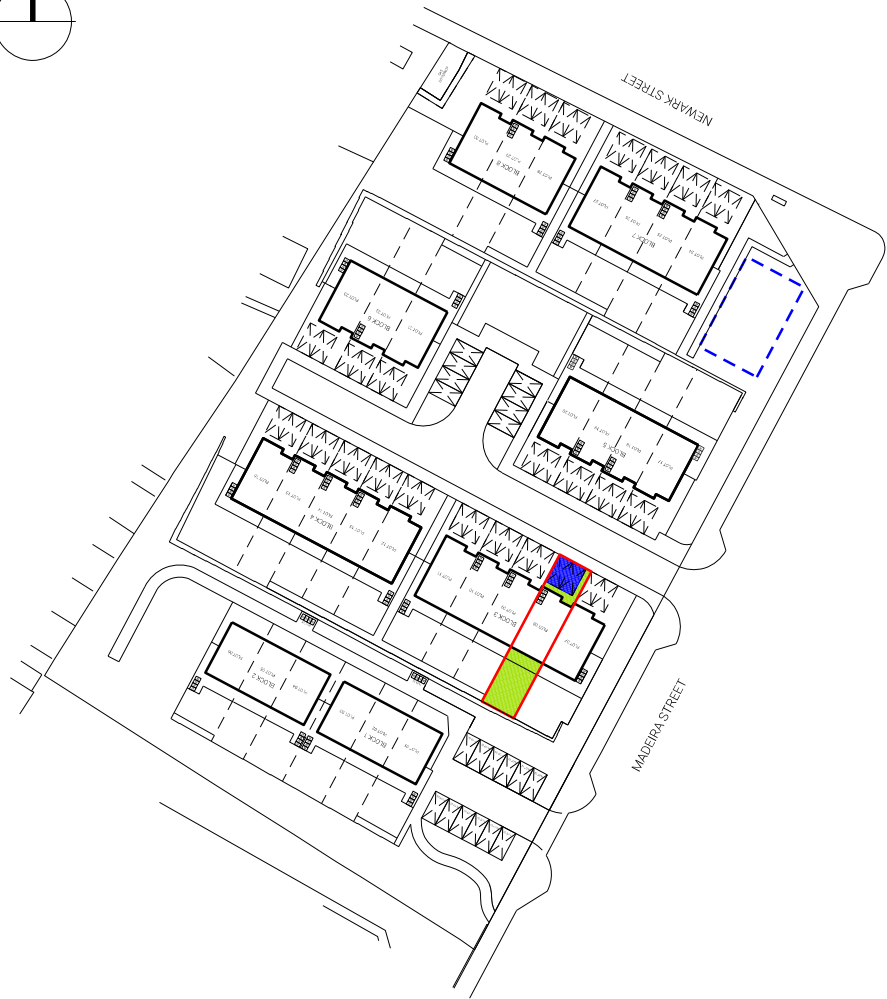

- PLOT TITLE BOUNDARY
- PARKING SPACE TO PLOT (HATCHED BLUE)
- GARDEN AREA TO PLOT (HATCHED GREEN)

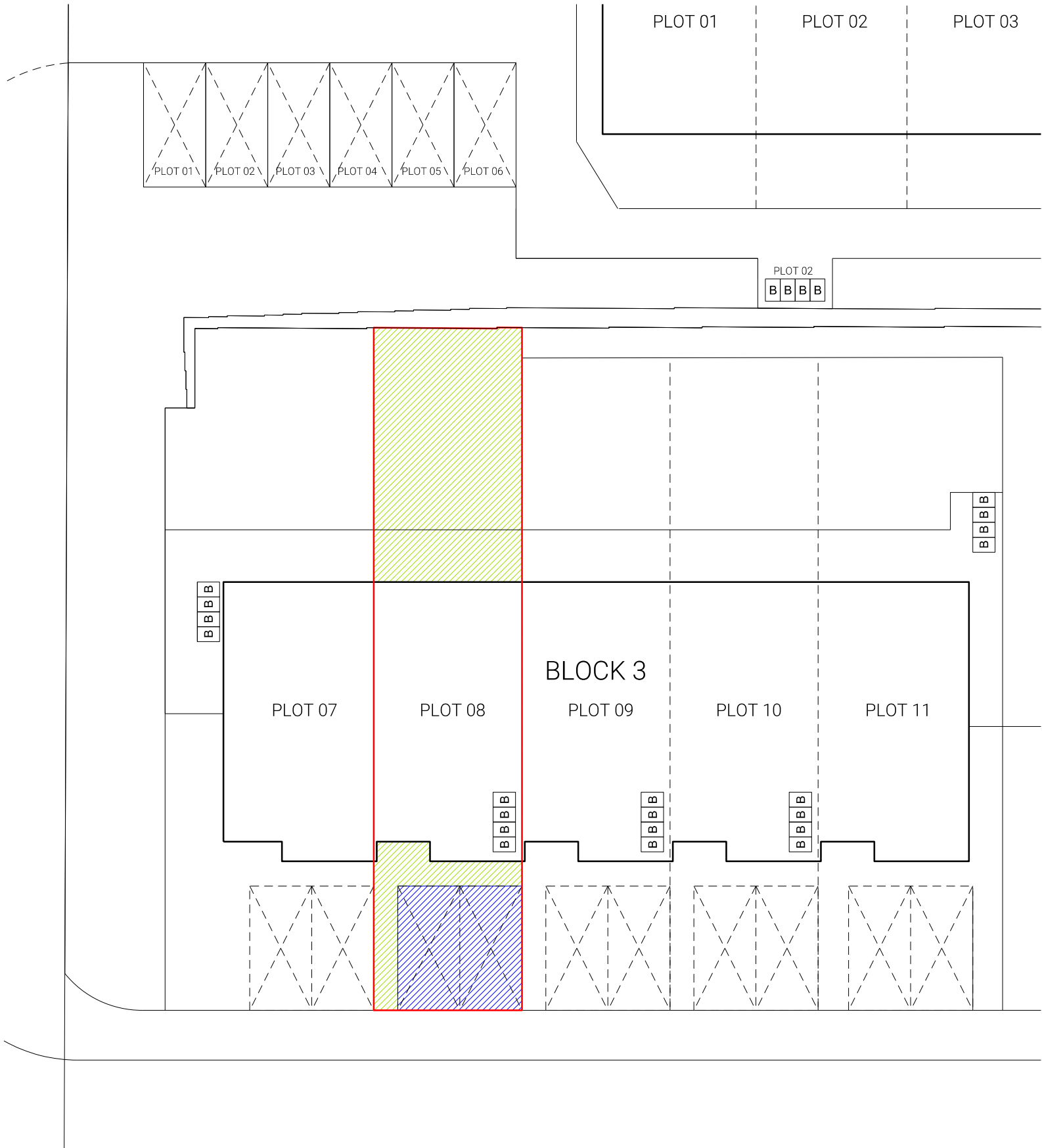

APPLICABLE REGULATIONS
CDM 2015 & HASAW ACT 1974 (and all amendments) - Applies at all times.
Working at height Regs 2005 - Applies at all times.
Workplace (Health, Safety and Welfare) Regs 1992 - Applies at all times.
Control of Asbestos Regs 2012 - Applies at all times.

Notes

Rev	Description	Date	Issued
C2	Updated for rear path addition	Oct 24	RH



51 St Vincent Crescent
Glasgow
G3 8NQ

T 0141 221 6834
E mast@mastarchitects.co.uk
W mastarchitects.co.uk



MASTARCH Ltd trading as MAST Architects registered in Scotland, company number SC447111, whose registered office is at 51 St Vincent Crescent, Glasgow, G3 8NQ

DO NOT SCALE FROM DRAWINGS
All dimensions to be checked on site by the Contractor and any discrepancies to be notified to the Architect prior to works being commenced. Use Figured dimensions only.

©All Rights Reserved. Copyright in all documents and drawings prepared by MAST Architects and in any work executed from those documents and drawings shall remain the property of MAST Architects.

Client		
CCG Homes (Ltd)		
Scale	Sheet Size	Job No.
1:200	A3	3333
Originator	Checked	Date
RH	-	Nov 23
Project		
Madeira Street, Greenock		
Drawing Title	Rev	
Plot 8 - Title Deed	A5-C2	
Drawing No.		
3333-MST-S1- GF-D-A-PM_40_40_15-1728		



- PLOT TITLE BOUNDARY
- PARKING SPACE TO PLOT (HATCHED BLUE)
- GARDEN AREA TO PLOT (HATCHED GREEN)

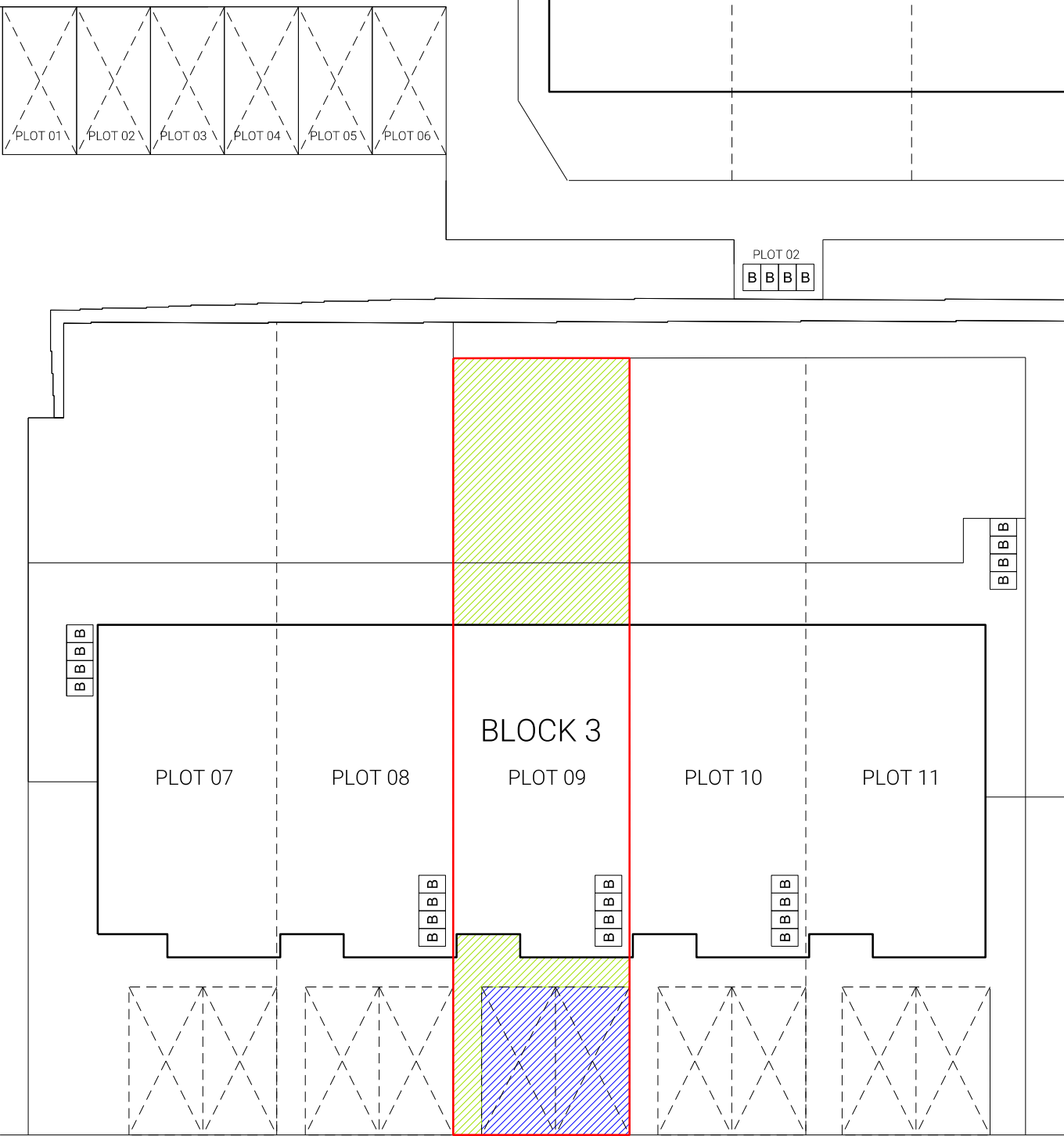

APPLICABLE REGULATIONS
CDM 2015 & HASAW ACT 1974 (and all amendments) - Applies at all times.
Working at height Regs 2005 - Applies at all times.
Workplace (Health, Safety and Welfare) Regs 1992 - Applies at all times.
Control of Asbestos Regs 2012 - Applies at all times.

Notes

Rev	Description	Date	Issued
C2	Updated for rear path addition	Oct 24	RH



51 St Vincent Crescent
Glasgow
G3 8NQ

T 0141 221 6834
E mast@mastarchitects.co.uk
W mastarchitects.co.uk



MASTARCH Ltd trading as MAST Architects registered in Scotland, company number SC447111, whose registered office is at 51 St Vincent Crescent, Glasgow, G3 8NQ

DO NOT SCALE FROM DRAWINGS
All dimensions to be checked on site by the Contractor and any discrepancies to be notified to the Architect prior to works being commenced. Use Figured dimensions only.

©All Rights Reserved. Copyright in all documents and drawings prepared by MAST Architects and in any work executed from those documents and drawings shall remain the property of MAST Architects.

Client
CCG Homes (Ltd)

Scale 1:200 Sheet Size A3 Job No. 3333

Originator RH Checked - Date Nov 23

Project
Madeira Street,
Greenock

Drawing Title Plot 9 - Title Deed Rev A5-C2

Drawing No.
3333-MST-S1-
GF-D-A-PM_40_40_15-1729



- PLOT TITLE BOUNDARY
- PARKING SPACE TO PLOT (HATCHED BLUE)
- GARDEN AREA TO PLOT (HATCHED GREEN)

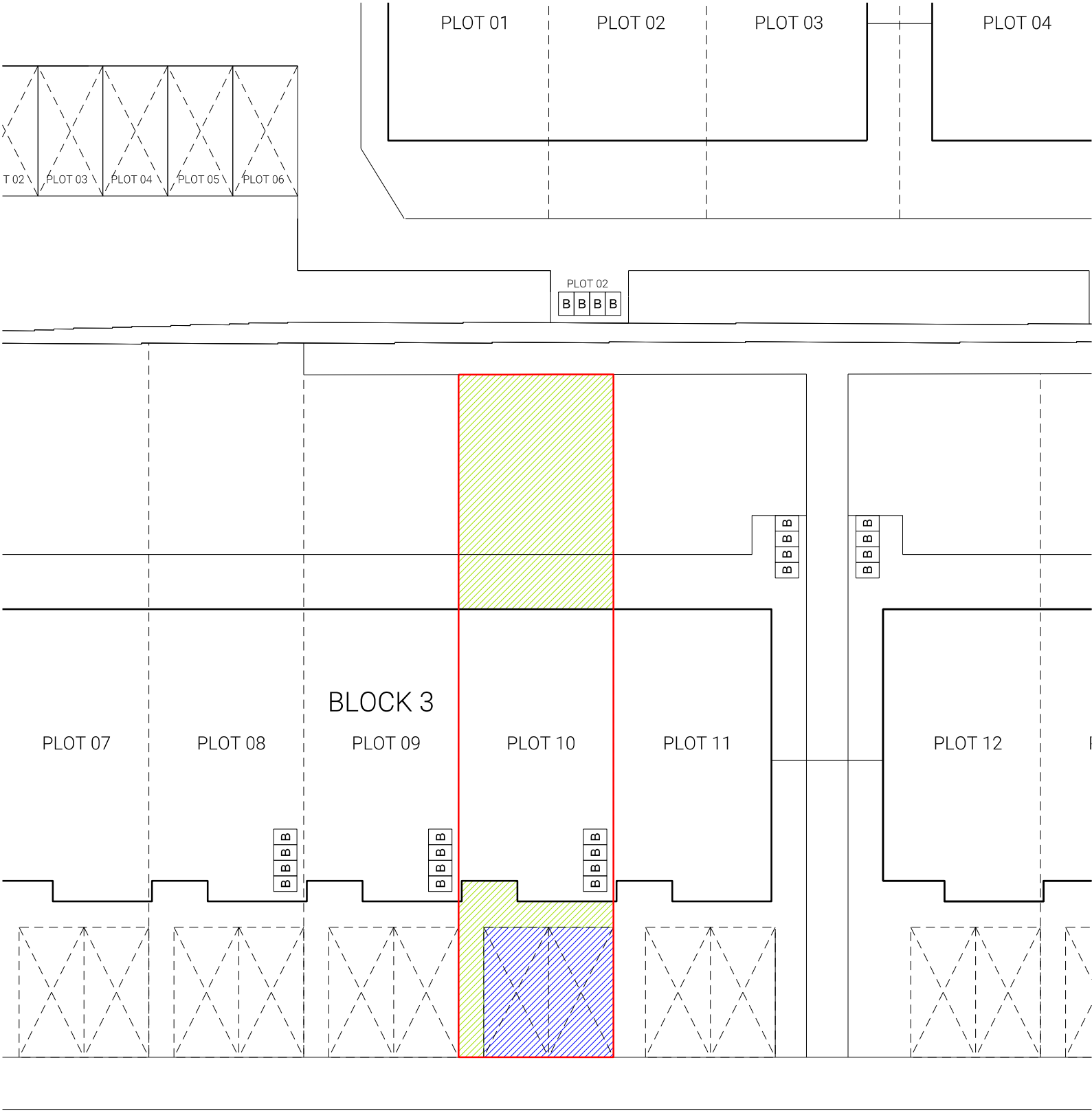

APPLICABLE REGULATIONS
CDM 2015 & HASAW ACT 1974 (and all amendments) - Applies at all times.
Working at height Regs 2005 - Applies at all times.
Workplace (Health, Safety and Welfare) Regs 1992 - Applies at all times.
Control of Asbestos Regs 2012 - Applies at all times.

Notes			
Rev	Description	Date	Issued
C2	Updated for rear path addition	Oct 24	RH

0 1 2 4 6 8
SCALE (M) 1:200

51 St Vincent Crescent
Glasgow
G3 8NQ

T 0141 221 6834
E mast@mastarchitects.co.uk
W mastarchitects.co.uk

MAST
ARCHITECTS

MASTARCH Ltd trading as MAST Architects registered in Scotland, company number SC447111, whose registered office is at 51 St Vincent Crescent, Glasgow, G3 8NQ

DO NOT SCALE FROM DRAWINGS
All dimensions to be checked on site by the Contractor and any discrepancies to be notified to the Architect prior to works being commenced. Use Figured dimensions only.

©All Rights Reserved. Copyright in all documents and drawings prepared by MAST Architects and in any work executed from those documents and drawings shall remain the property of MAST Architects.

Client		
CCG Homes (Ltd)		
Scale	Sheet Size	Job No.
1:200	A3	3333
Originator	Checked	Date
RH	-	Nov 23
Project		
Madeira Street, Greenock		
Drawing Title		Rev
Plot 10 - Title Deed		A5-C2
Drawing No.		
3333-MST-S1-GF-D-A-PM_40_40_15-1730		



- PLOT TITLE BOUNDARY
- PARKING SPACE TO PLOT (HATCHED BLUE)
- GARDEN AREA TO PLOT (HATCHED GREEN)

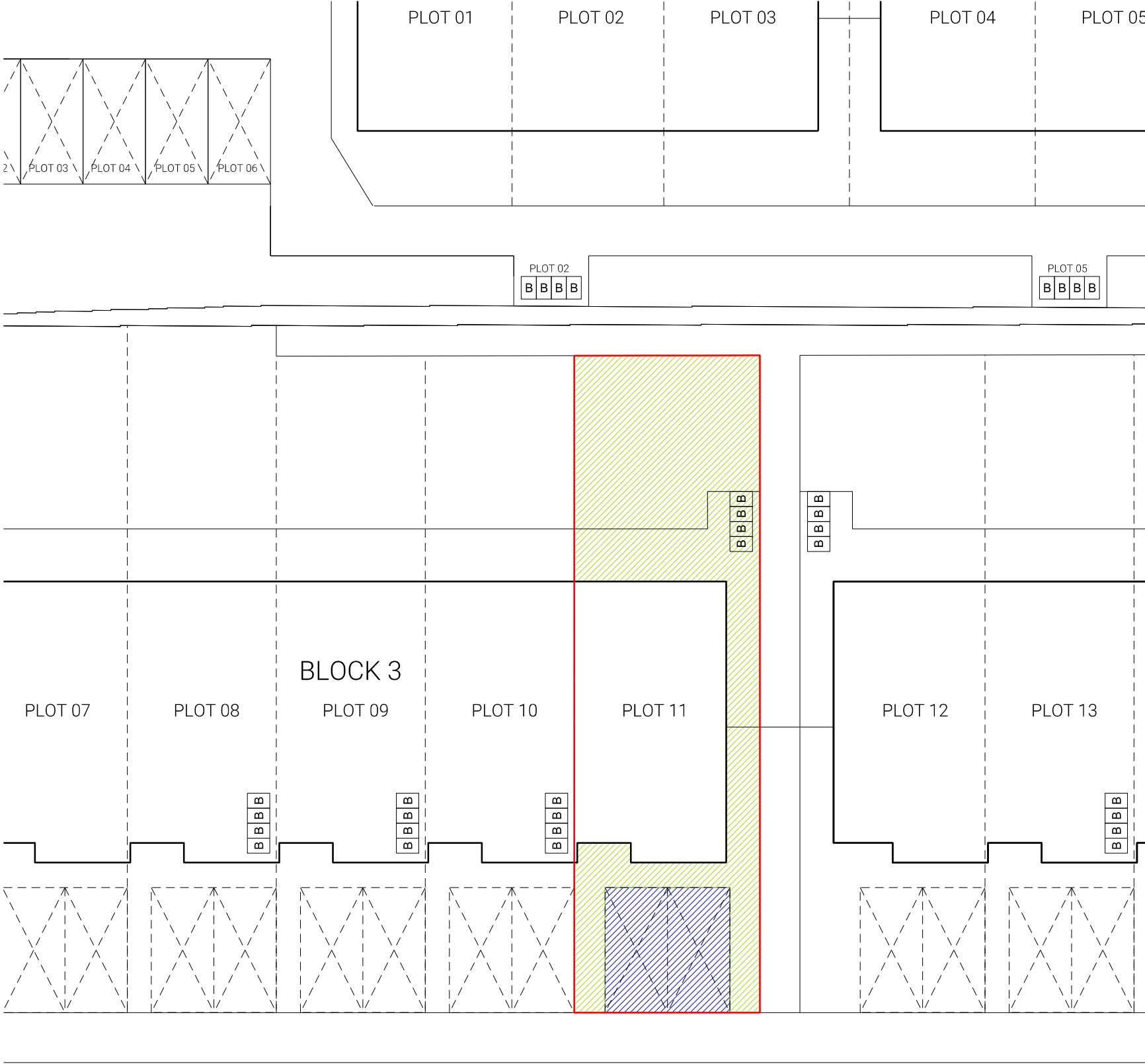

APPLICABLE REGULATIONS

CDM 2015 & HASAW ACT 1974 (and all amendments) - Applies at all times.
Working at height Regs 2005 - Applies at all times.
Workplace (Health, Safety and Welfare) Regs 1992 - Applies at all times.
Control of Asbestos Regs 2012 - Applies at all times.

Notes

Rev	Description	Date	Issued
C2	Updated for rear path addition	Oct 24	RH



51 St Vincent Crescent
Glasgow
G3 8NQ

T 0141 221 6834
E mast@mastarchitects.co.uk
W mastarchitects.co.uk



MASTARCH Ltd trading as MAST Architects registered in Scotland, company number SC447111, whose registered office is at 51 St Vincent Crescent, Glasgow, G3 8NQ

DO NOT SCALE FROM DRAWINGS
All dimensions to be checked on site by the Contractor and any discrepancies to be notified to the Architect prior to works being commenced. Use Figured dimensions only.

©All Rights Reserved. Copyright in all documents and drawings prepared by MAST Architects and in any work executed from those documents and drawings shall remain the property of MAST Architects.

Client		
CCG Homes (Ltd)		
Scale	Sheet Size	Job No.
1:200	A3	3333
Originator	Checked	Date
RH	-	Nov 23
Project		
Madeira Street, Greenock		
Drawing Title	Rev	
Plot 11 - Title Deed	A5-C2	
Drawing No.		
3333-MST-S1- GF-D-A-PM_40_40_15-1731		



- PLOT TITLE BOUNDARY
- PARKING SPACE TO PLOT (HATCHED BLUE)
- GARDEN AREA TO PLOT (HATCHED GREEN)

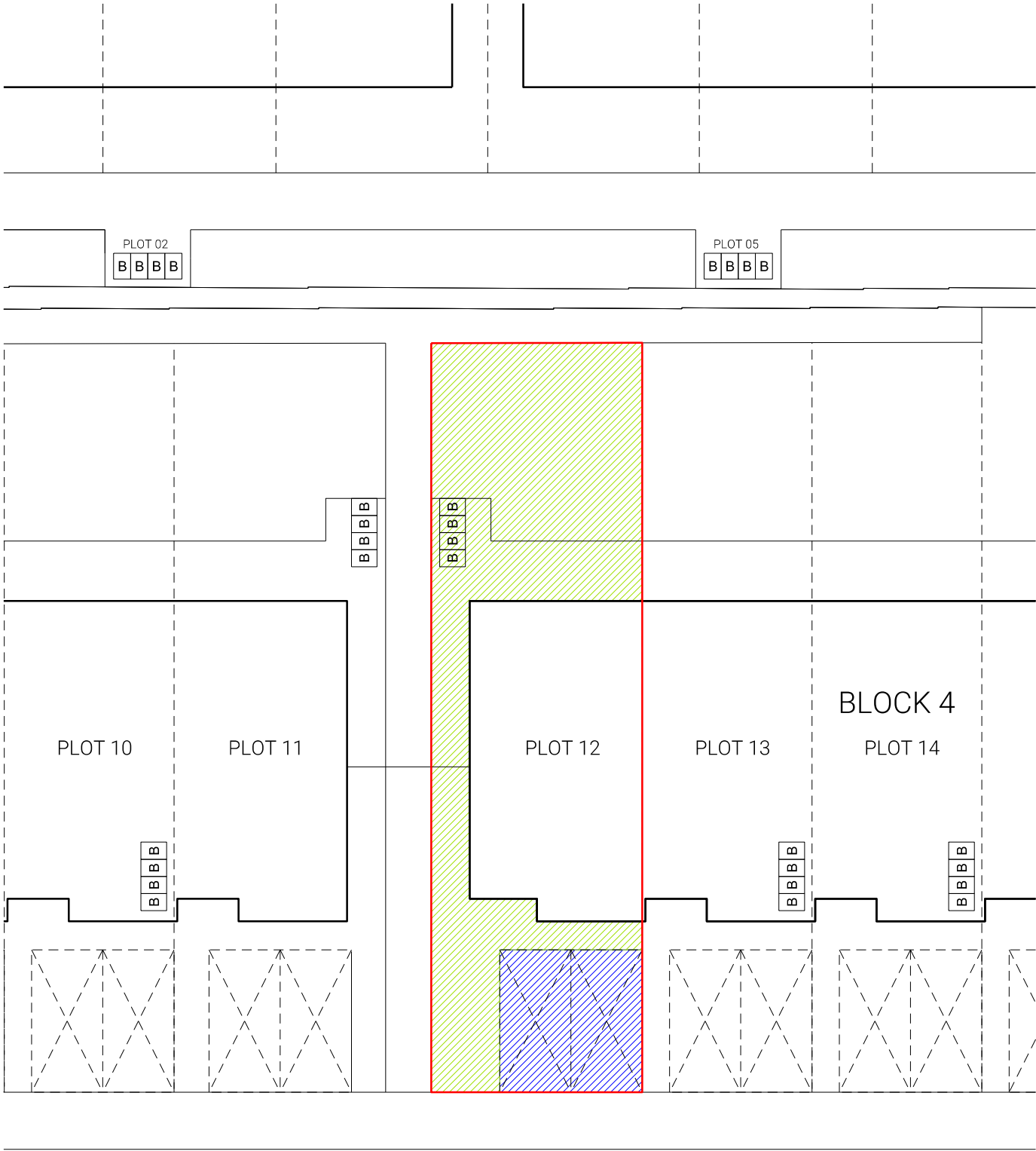

APPLICABLE REGULATIONS
CDM 2015 & HASAW ACT 1974 (and all amendments) - Applies at all times.
Working at height Regs 2005 - Applies at all times.
Workplace (Health, Safety and Welfare) Regs 1992 - Applies at all times.
Control of Asbestos Regs 2012 - Applies at all times.

Notes			
Rev	Description	Date	Issued
C2	Updated for rear path addition	Oct 24	RH



51 St Vincent Crescent
Glasgow
G3 8NQ

T 0141 221 6834
E mast@mastarchitects.co.uk
W mastarchitects.co.uk

MAST
ARCHITECTS

MASTARCH Ltd trading as MAST Architects registered in Scotland, company number SC447111, whose registered office is at 51 St Vincent Crescent, Glasgow, G3 8NQ

DO NOT SCALE FROM DRAWINGS
All dimensions to be checked on site by the Contractor and any discrepancies to be notified to the Architect prior to works being commenced. Use Figured dimensions only.

©All Rights Reserved. Copyright in all documents and drawings prepared by MAST Architects and in any work executed from those documents and drawings shall remain the property of MAST Architects.

Client

CCG Homes (Ltd)

Scale

1:200

Sheet Size

A3

Job No.

3333

Originator

RH

Checked

-

Date

Nov 23

Project

Madeira Street,
Greenock

Drawing Title

Plot 12 - Title Deed

Rev

A5-C2

Drawing No.

3333-MST-S1-
GF-D-A-PM_40_40_15-1732



- PLOT TITLE BOUNDARY
- PARKING SPACE TO PLOT (HATCHED BLUE)
- GARDEN AREA TO PLOT (HATCHED GREEN)

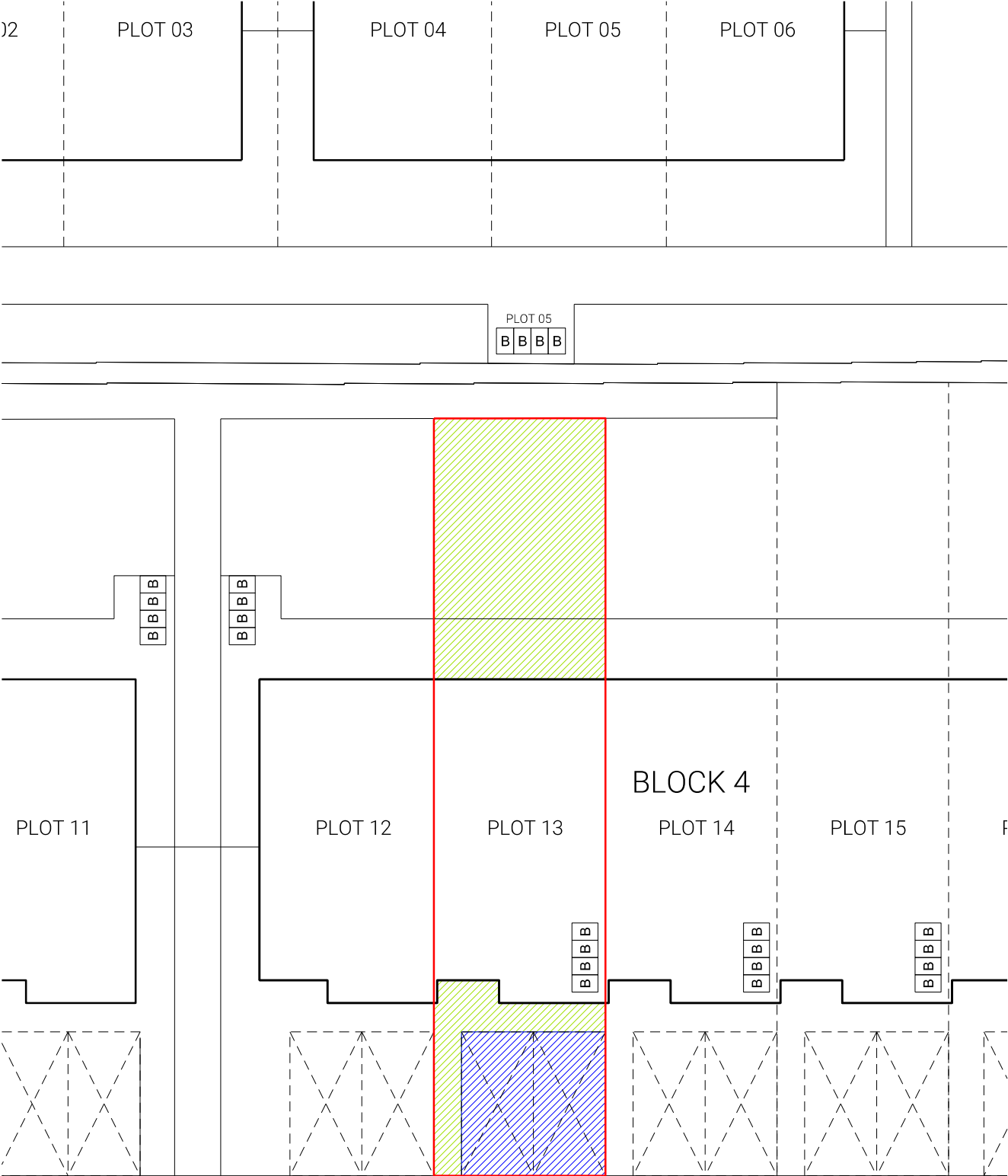

APPLICABLE REGULATIONS

CDM 2015 & HASAW ACT 1974 (and all amendments) - Applies at all times.
Working at height Regs 2005 - Applies at all times.
Workplace (Health, Safety and Welfare) Regs 1992 - Applies at all times.
Control of Asbestos Regs 2012 - Applies at all times.

Notes

Rev

Description

Date

Issued

C2

Updated for rear path addition

Oct 24

RH

012345678

SCALE (M)

1:200

51 St Vincent Crescent
Glasgow
G3 8NQ

T 0141 221 6834
E mast@mastarchitects.co.uk
W mastarchitects.co.uk

M

MAST
ARCHITECTS

MASTARCH Ltd trading as MAST Architects registered in Scotland, company number SC447111, whose registered office is at 51 St Vincent Crescent, Glasgow, G3 8NQ

DO NOT SCALE FROM DRAWINGS
All dimensions to be checked on site by the Contractor and any discrepancies to be notified to the Architect prior to works being commenced. Use Figured dimensions only.

©All Rights Reserved. Copyright in all documents and drawings prepared by MAST Architects and in any work executed from those documents and drawings shall remain the property of MAST Architects.

Client

CCG Homes (Ltd)

Scale

Sheet Size

Job No.

1:200

A3

3333

Originator

Checked

Date

RH

-

Nov 23

Project

Madeira Street,
Greenock

Drawing Title

Rev

Plot 13 - Title Deed

A5-C2

Drawing No.

3333-MST-S1-
GF-D-A-PM_40_40_15-1733



- PLOT TITLE BOUNDARY
- PARKING SPACE TO PLOT (HATCHED BLUE)
- GARDEN AREA TO PLOT (HATCHED GREEN)

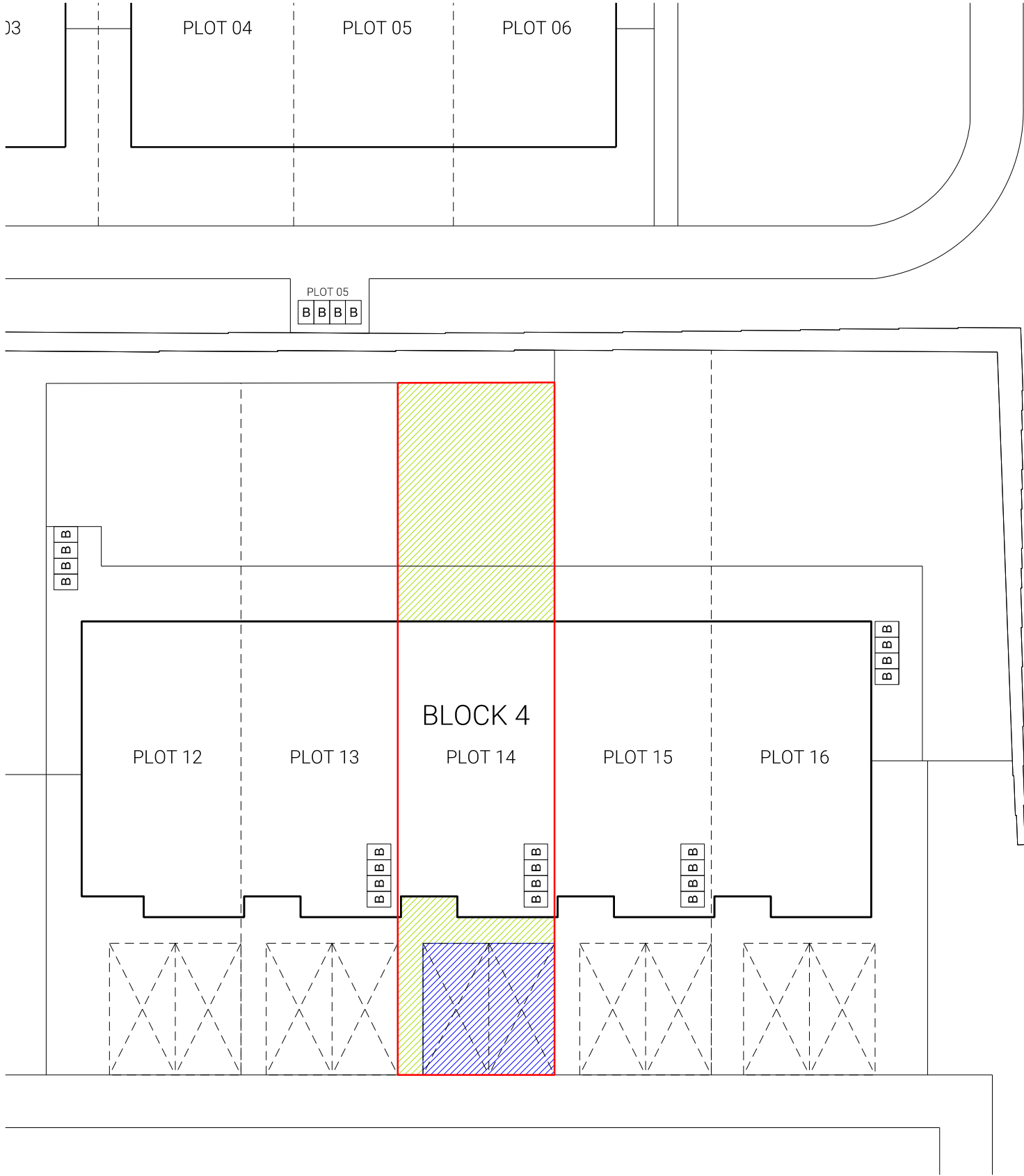

APPLICABLE REGULATIONS

CDM 2015 & HASAW ACT 1974 (and all amendments) - Applies at all times.
Working at height Regs 2005 - Applies at all times.
Workplace (Health, Safety and Welfare) Regs 1992 - Applies at all times.
Control of Asbestos Regs 2012 - Applies at all times.

Notes

Rev

Description

Date

Issued

C2

Updated for rear path addition

Oct 24

RH

0124

SCALE (M)

012468

1:200

51 St Vincent Crescent
Glasgow
G3 8NQ

T 0141 221 6834
E mast@mastarchitects.co.uk
W mastarchitects.co.uk

MAST

ARCHITECTS

MASTARCH Ltd trading as MAST Architects registered in Scotland, company number SC447111, whose registered office is at 51 St Vincent Crescent, Glasgow, G3 8NQ

DO NOT SCALE FROM DRAWINGS
All dimensions to be checked on site by the Contractor and any discrepancies to be notified to the Architect prior to works being commenced. Use Figured dimensions only.

©All Rights Reserved. Copyright in all documents and drawings prepared by MAST Architects and in any work executed from those documents and drawings shall remain the property of MAST Architects.

Client

CCG Homes (Ltd)

Scale

Sheet Size

Job No.

1:200

A3

3333

Originator

Checked

Date

RH

-

Nov 23

Project

Madeira Street,
Greenock

Drawing Title

Rev

Plot 14 - Title Deed

A5-C2

Drawing No.

3333-MST-S1-
GF-D-A-PM_40_40_15-1734



- PLOT TITLE BOUNDARY
- PARKING SPACE TO PLOT (HATCHED BLUE)
- GARDEN AREA TO PLOT (HATCHED GREEN)

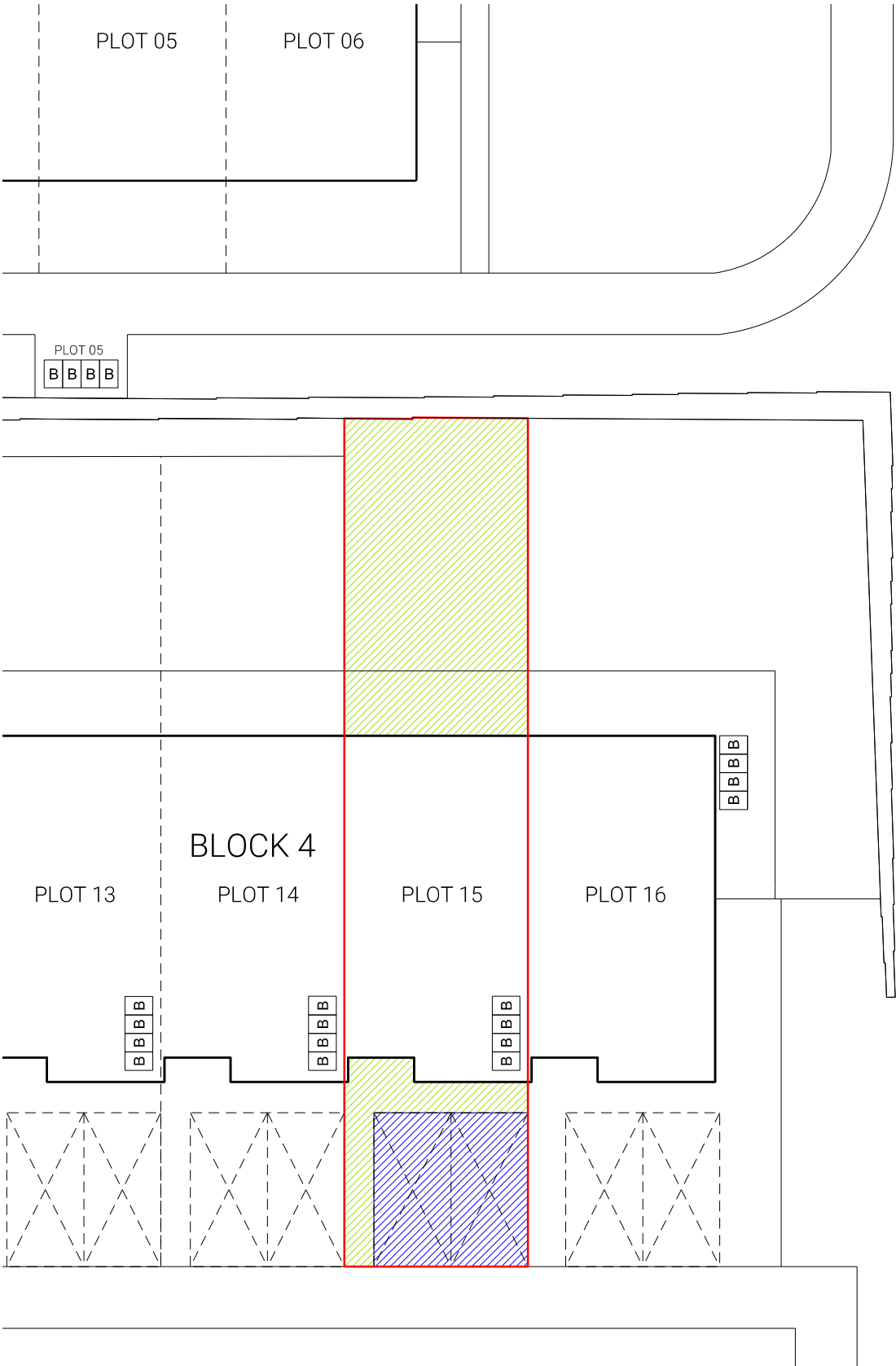

APPLICABLE REGULATIONS
CDM 2015 & HASAW ACT 1974 (and all amendments) - Applies at all times.
Working at height Regs 2005 - Applies at all times.
Workplace (Health, Safety and Welfare) Regs 1992 - Applies at all times.
Control of Asbestos Regs 2012 - Applies at all times.

Notes

Rev	Description	Date	Issued
C2	Updated for rear path addition	Oct 24	RH



51 St Vincent Crescent
Glasgow
G3 8NQ

T 0141 221 6834
E mast@mastarchitects.co.uk
W mastarchitects.co.uk

MAST
ARCHITECTS

MASTARCH Ltd trading as MAST Architects registered in Scotland, company number SC447111, whose registered office is at 51 St Vincent Crescent, Glasgow, G3 8NQ

DO NOT SCALE FROM DRAWINGS
All dimensions to be checked on site by the Contractor and any discrepancies to be notified to the Architect prior to works being commenced. Use Figured dimensions only.

©All Rights Reserved. Copyright in all documents and drawings prepared by MAST Architects and in any work executed from those documents and drawings shall remain the property of MAST Architects.

Client		
CCG Homes (Ltd)		
Scale	Sheet Size	Job No.
1:200	A3	3333
Originator	Checked	Date
RH	-	Nov 23
Project		
Madeira Street, Greenock		
Drawing Title	Rev	
Plot 15 - Title Deed	A5-C2	
Drawing No.		
3333-MST-S1- GF-D-A-PM_40_40_15-1735		



- PLOT TITLE BOUNDARY
- PARKING SPACE TO PLOT (HATCHED BLUE)
- GARDEN AREA TO PLOT (HATCHED GREEN)

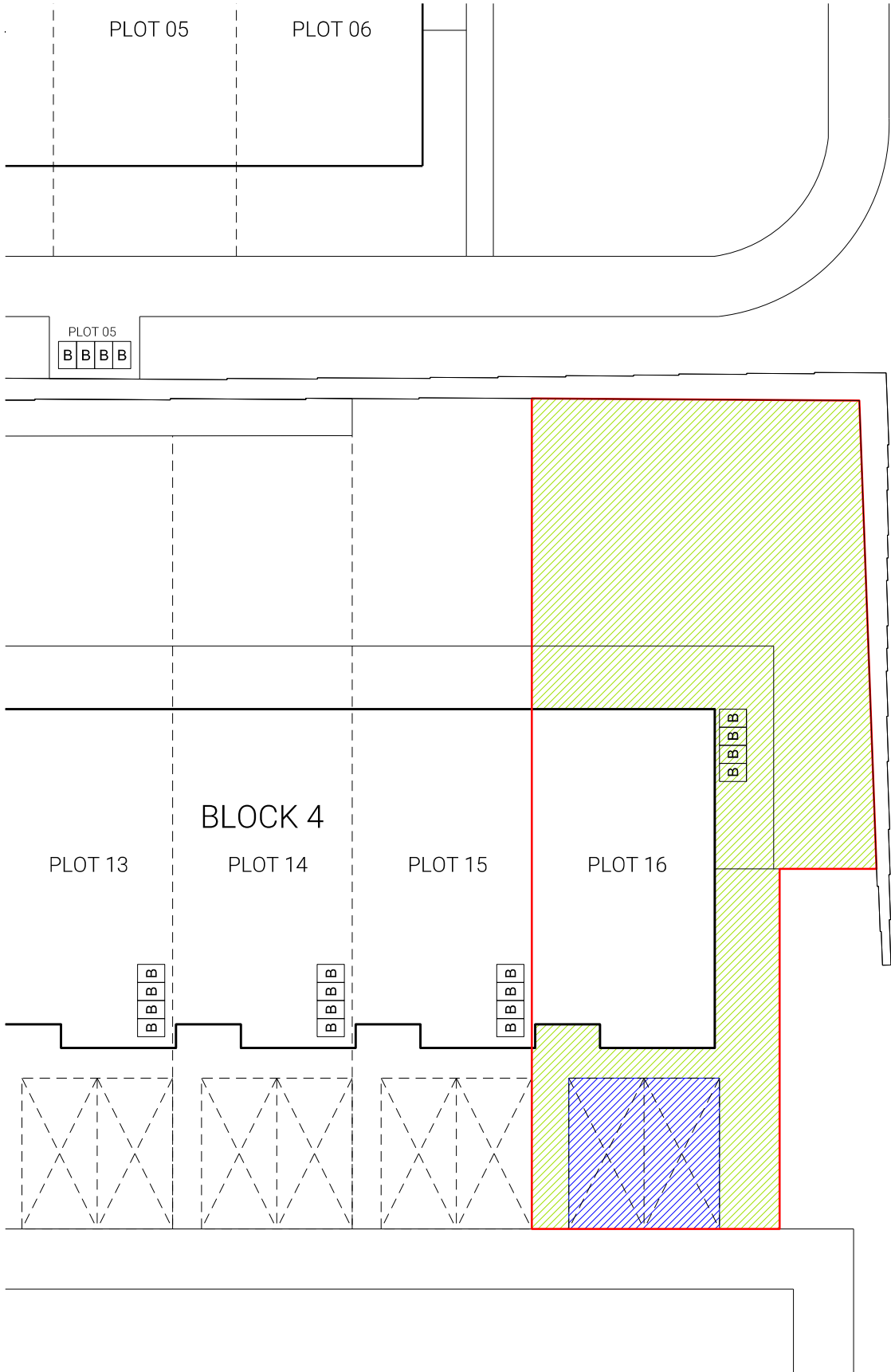

APPLICABLE REGULATIONS
CDM 2015 & HASAW ACT 1974 (and all amendments) - Applies at all times.
Working at height Regs 2005 - Applies at all times.
Workplace (Health, Safety and Welfare) Regs 1992 - Applies at all times.
Control of Asbestos Regs 2012 - Applies at all times.

Notes

Rev	Description	Date	Issued
C2	Updated for rear path addition	Oct 24	RH

0 1 2 4 6 8
SCALE (M) 1:200

51 St Vincent Crescent
Glasgow
G3 8NQ

T 0141 221 6834
E mast@mastarchitects.co.uk
W mastarchitects.co.uk



MASTARCH Ltd trading as MAST Architects registered in Scotland, company number SC447111, whose registered office is at 51 St Vincent Crescent, Glasgow, G3 8NQ

DO NOT SCALE FROM DRAWINGS
All dimensions to be checked on site by the Contractor and any discrepancies to be notified to the Architect prior to works being commenced. Use Figured dimensions only.

©All Rights Reserved. Copyright in all documents and drawings prepared by MAST Architects and in any work executed from those documents and drawings shall remain the property of MAST Architects.

Client

CCG Homes (Ltd)

Scale	Sheet Size	Job No.
1:200	A3	3333

Originator	Checked	Date
RH	-	Nov 23

Project
Madeira Street,
Greenock

Drawing Title	Rev
Plot 16 - Title Deed	A5-C2

Drawing No.
3333-MST-S1-
GF-D-A-PM_40_40_15-1736



- PLOT TITLE BOUNDARY
- PARKING SPACE TO PLOT (HATCHED BLUE)
- GARDEN AREA TO PLOT (HATCHED GREEN)

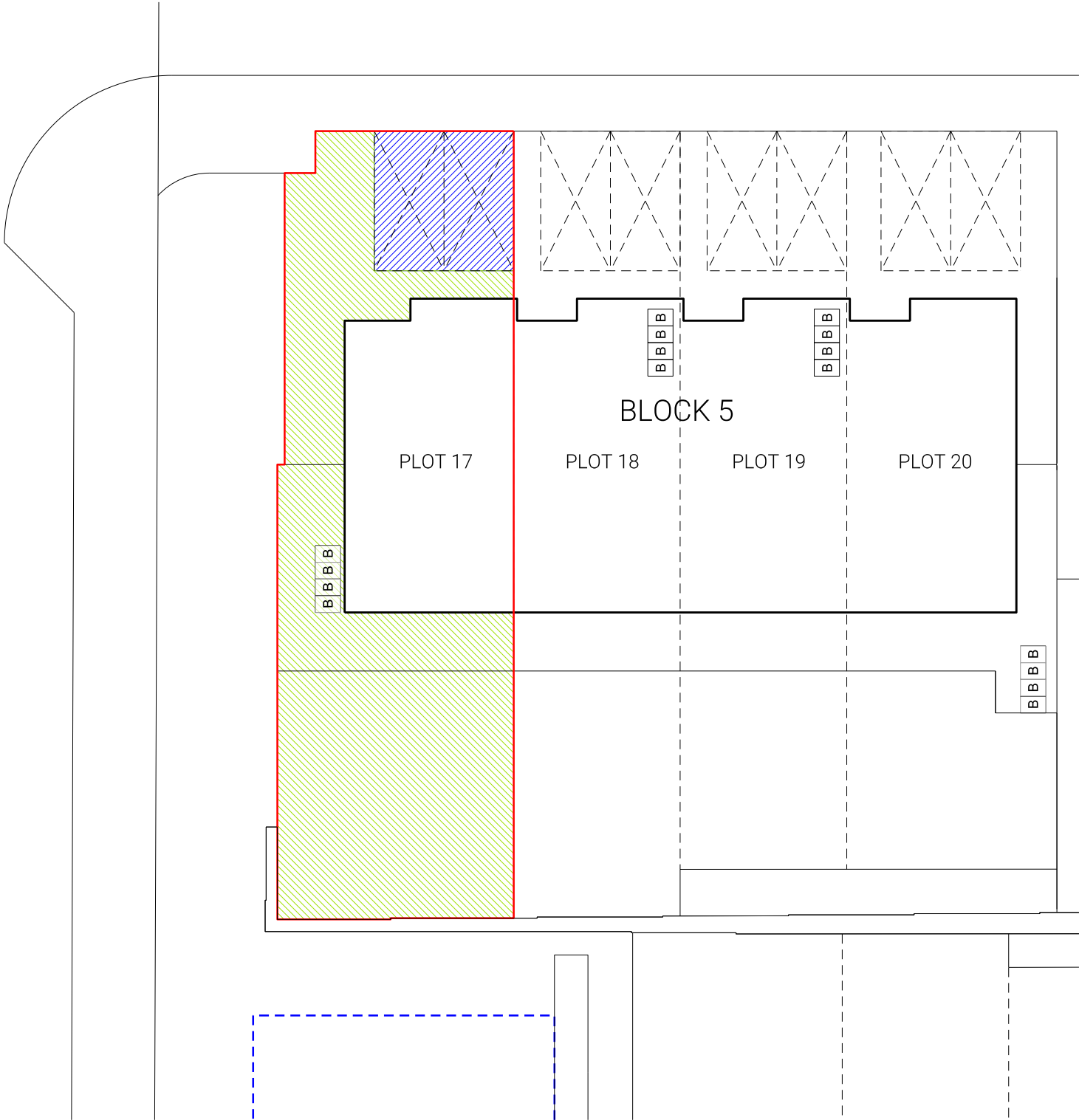

APPLICABLE REGULATIONS

CDM 2015 & HASAW ACT 1974 (and all amendments) - Applies at all times.
Working at height Regs 2005 - Applies at all times.
Workplace (Health, Safety and Welfare) Regs 1992 - Applies at all times.
Control of Asbestos Regs 2012 - Applies at all times.

Notes

Rev	Description	Date	Issued
C2	Updated for rear path addition	Oct 24	RH

0124
SCALE (M)

012468
1:200

51 St Vincent Crescent
Glasgow
G3 8NQ

T 0141 221 6834
E mast@mastarchitects.co.uk
W mastarchitects.co.uk

M

MAST
ARCHITECTS

MASTARCH Ltd trading as MAST Architects registered in Scotland, company number SC447111, whose registered office is at 51 St Vincent Crescent, Glasgow, G3 8NQ

DO NOT SCALE FROM DRAWINGS
All dimensions to be checked on site by the Contractor and any discrepancies to be notified to the Architect prior to works being commenced. Use Figured dimensions only.

©All Rights Reserved. Copyright in all documents and drawings prepared by MAST Architects and in any work executed from those documents and drawings shall remain the property of MAST Architects.

Client

CCG Homes (Ltd)

Scale	Sheet Size	Job No.
1:200	A3	3333

Originator	Checked	Date
RH	-	Nov 23

Project

Madeira Street,
Greenock

Drawing Title	Rev
Plot 17 - Title Deed	A5-C2

Drawing No.

3333-MST-S1-
GF-D-A-PM_40_40_15-1737



- PLOT TITLE BOUNDARY
- PARKING SPACE TO PLOT (HATCHED BLUE)
- GARDEN AREA TO PLOT (HATCHED GREEN)

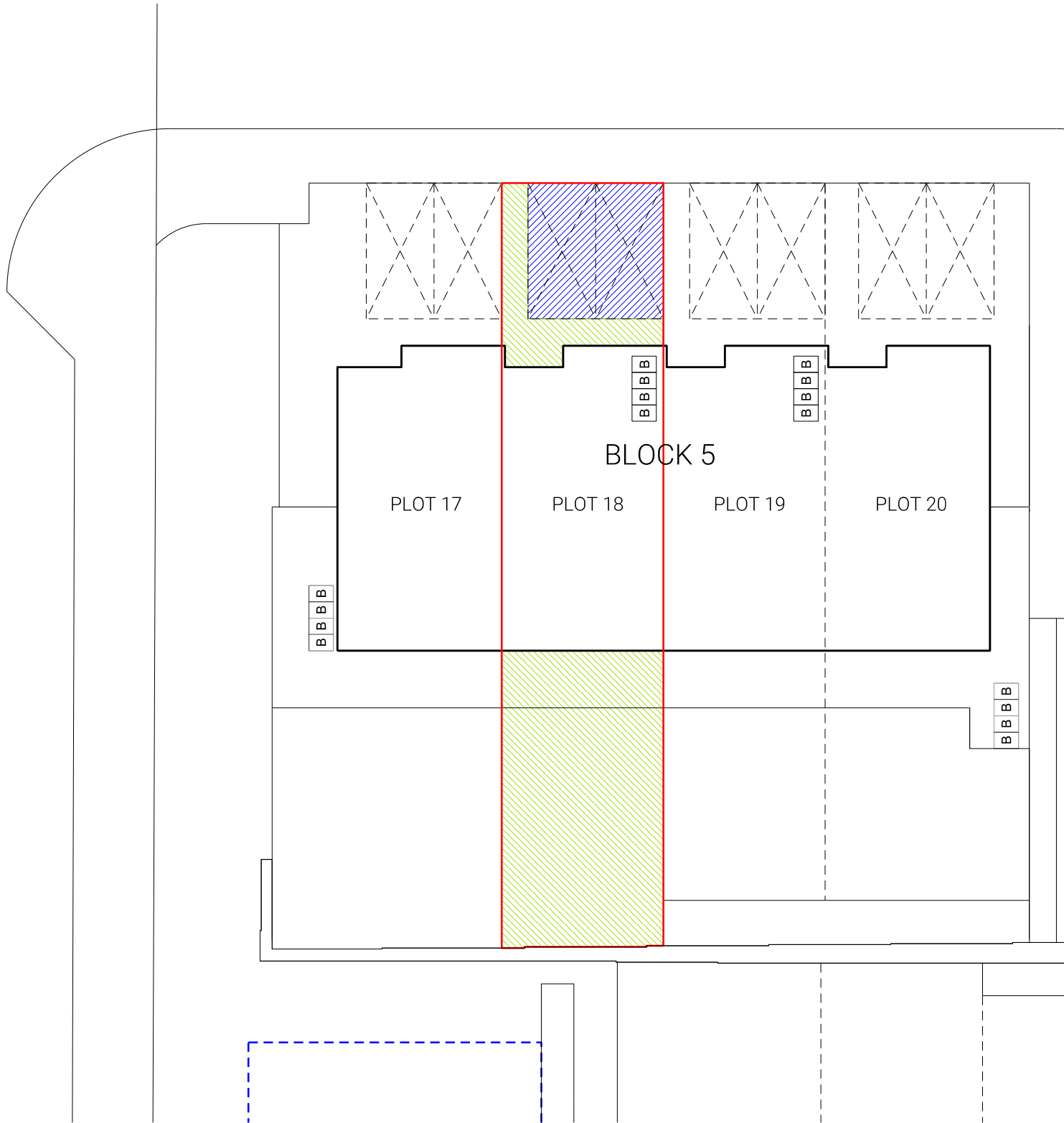

APPLICABLE REGULATIONS

CDM 2015 & HASAW ACT 1974 (and all amendments) - Applies at all times.

Working at height Regs 2005 - Applies at all times.

Workplace (Health, Safety and Welfare) Regs 1992 - Applies at all times.

Control of Asbestos Regs 2012 - Applies at all times.

Notes

Rev	Description	Date	Issued
C2	Updated for rear path addition	Oct 24	RH

0 1 2 4 6 8
SCALE (M) 1:200

51 St Vincent Crescent
Glasgow
G3 8NQ

T 0141 221 6834
E mast@mastarchitects.co.uk
W mastarchitects.co.uk



MASTARCH Ltd trading as MAST Architects registered in Scotland, company number SC447111, whose registered office is at 51 St Vincent Crescent, Glasgow, G3 8NQ

DO NOT SCALE FROM DRAWINGS
All dimensions to be checked on site by the Contractor and any discrepancies to be notified to the Architect prior to works being commenced. Use Figured dimensions only.

©All Rights Reserved. Copyright in all documents and drawings prepared by MAST Architects and in any work executed from those documents and drawings shall remain the property of MAST Architects.

Client

CCG Homes (Ltd)

Scale	Sheet Size	Job No.
1:200	A3	3333

Originator	Checked	Date
RH	-	Nov 23

Project
Madeira Street,
Greenock

Drawing Title	Rev
Plot 18 - Title Deed	A5-C2

Drawing No.
3333-MST-S1-
GF-D-A-PM_40_40_15-1738



- PLOT TITLE BOUNDARY
- PARKING SPACE TO PLOT (HATCHED BLUE)
- GARDEN AREA TO PLOT (HATCHED GREEN)

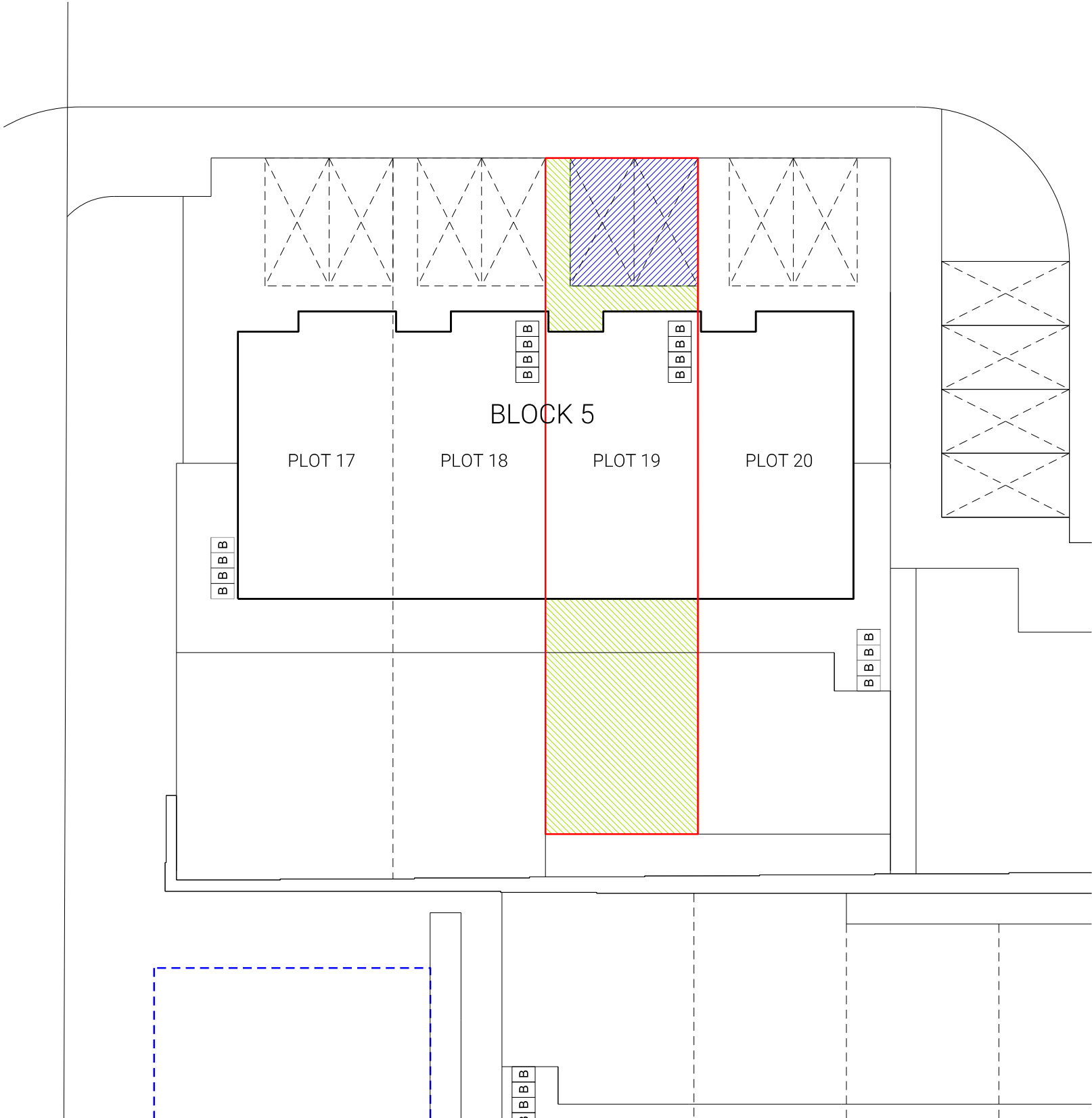

APPLICABLE REGULATIONS
CDM 2015 & HASAW ACT 1974 (and all amendments) - Applies at all times.
Working at height Regs 2005 - Applies at all times.
Workplace (Health, Safety and Welfare) Regs 1992 - Applies at all times.
Control of Asbestos Regs 2012 - Applies at all times.

Notes

Rev	Description	Date	Issued
C2	Updated for rear path addition	Oct 24	RH



51 St Vincent Crescent
Glasgow
G3 8NQ

T 0141 221 6834
E mast@mastarchitects.co.uk
W mastarchitects.co.uk



MASTARCH Ltd trading as MAST Architects registered in Scotland, company number SC447111, whose registered office is at 51 St Vincent Crescent, Glasgow, G3 8NQ

DO NOT SCALE FROM DRAWINGS
All dimensions to be checked on site by the Contractor and any discrepancies to be notified to the Architect prior to works being commenced. Use Figured dimensions only.

©All Rights Reserved. Copyright in all documents and drawings prepared by MAST Architects and in any work executed from those documents and drawings shall remain the property of MAST Architects.

Client		
CCG Homes (Ltd)		
Scale	Sheet Size	Job No.
1:200	A3	3333
Originator	Checked	Date
RH	-	Nov 23
Project		
Madeira Street, Greenock		
Drawing Title	Rev	
Plot 19 - Title Deed	A5-C2	
Drawing No.		
3333-MST-S1- GF-D-A-PM_40_40_15-1739		



- PLOT TITLE BOUNDARY
- PARKING SPACE TO PLOT (HATCHED BLUE)
- GARDEN AREA TO PLOT (HATCHED GREEN)

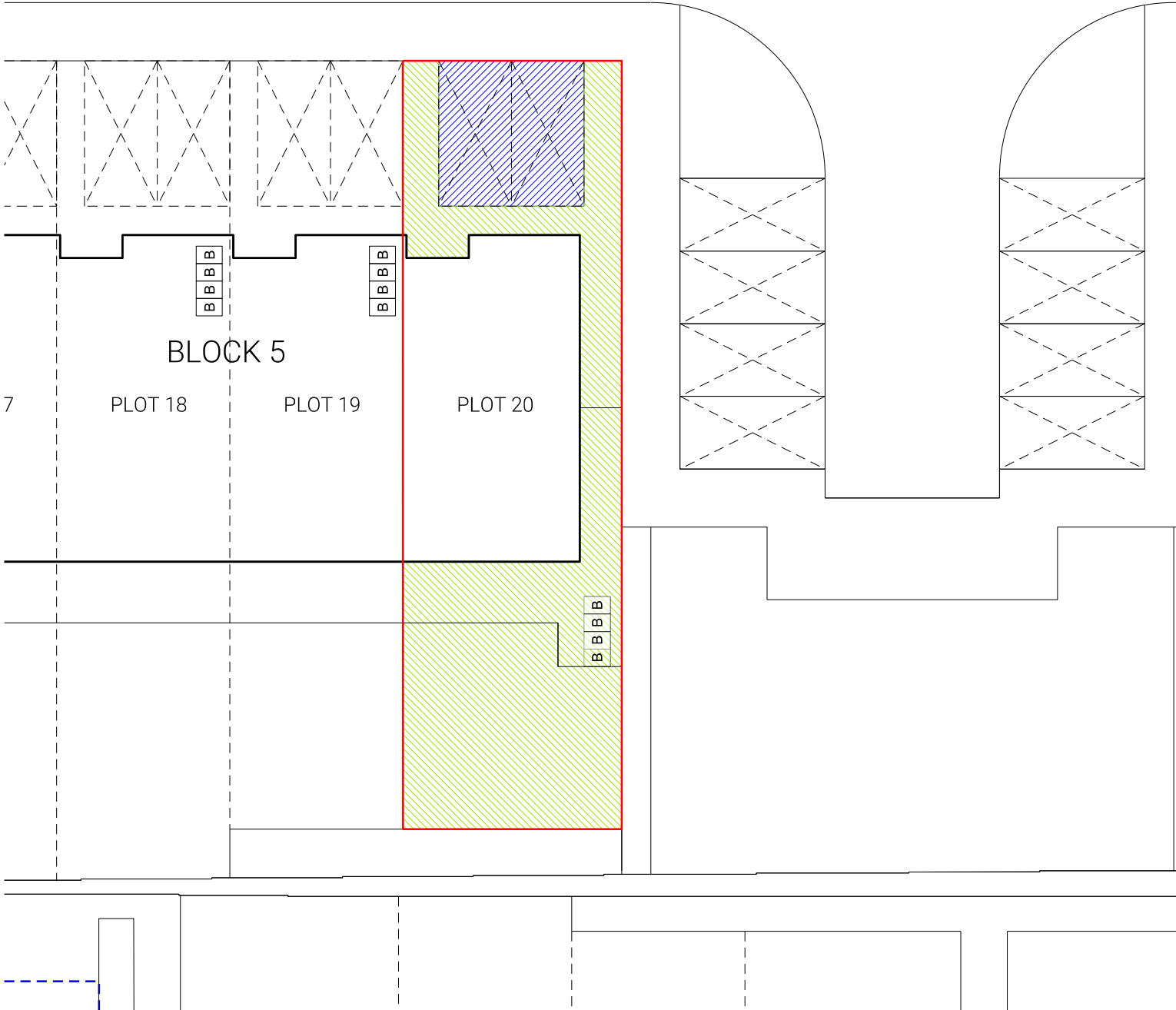
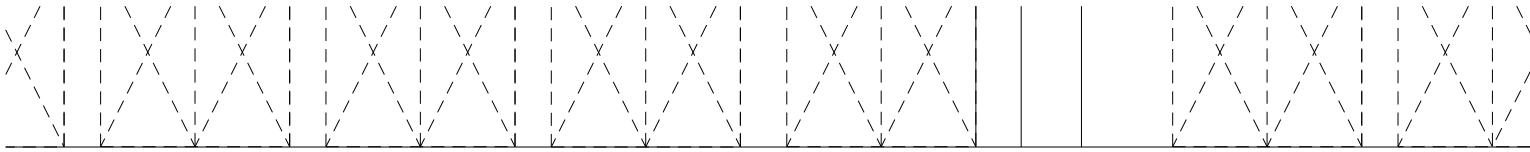

APPLICABLE REGULATIONS
CDM 2015 & HASAW ACT 1974 (and all amendments) - Applies at all times.
Working at height Regs 2005 - Applies at all times.
Workplace (Health, Safety and Welfare) Regs 1992 - Applies at all times.
Control of Asbestos Regs 2012 - Applies at all times.

Notes

Rev	Description	Date	Issued
C2	Updated for rear path addition	Oct 24	RH

0 1 2 4 6 8
SCALE (M) 1:200

51 St Vincent Crescent
Glasgow
G3 8NQ

T 0141 221 6834
E mast@mastarchitects.co.uk
W mastarchitects.co.uk



MASTARCH Ltd trading as MAST Architects registered in Scotland, company number SC447111, whose registered office is at 51 St Vincent Crescent, Glasgow, G3 8NQ

DO NOT SCALE FROM DRAWINGS
All dimensions to be checked on site by the Contractor and any discrepancies to be notified to the Architect prior to works being commenced. Use Figured dimensions only.

©All Rights Reserved. Copyright in all documents and drawings prepared by MAST Architects and in any work executed from those documents and drawings shall remain the property of MAST Architects.

Client		
CCG Homes (Ltd)		
Scale	Sheet Size	Job No.
1:200	A3	3333
Originator	Checked	Date
RH	-	Nov 23
Project		
Madeira Street, Greenock		
Drawing Title	Rev	
Plot 20 - Title Deed	A5-C2	
Drawing No.		
3333-MST-S1- GF-D-A-PM_40_40_15-1740		



- PLOT TITLE BOUNDARY
- PARKING SPACE TO PLOT (HATCHED BLUE)
- GARDEN AREA TO PLOT (HATCHED GREEN)

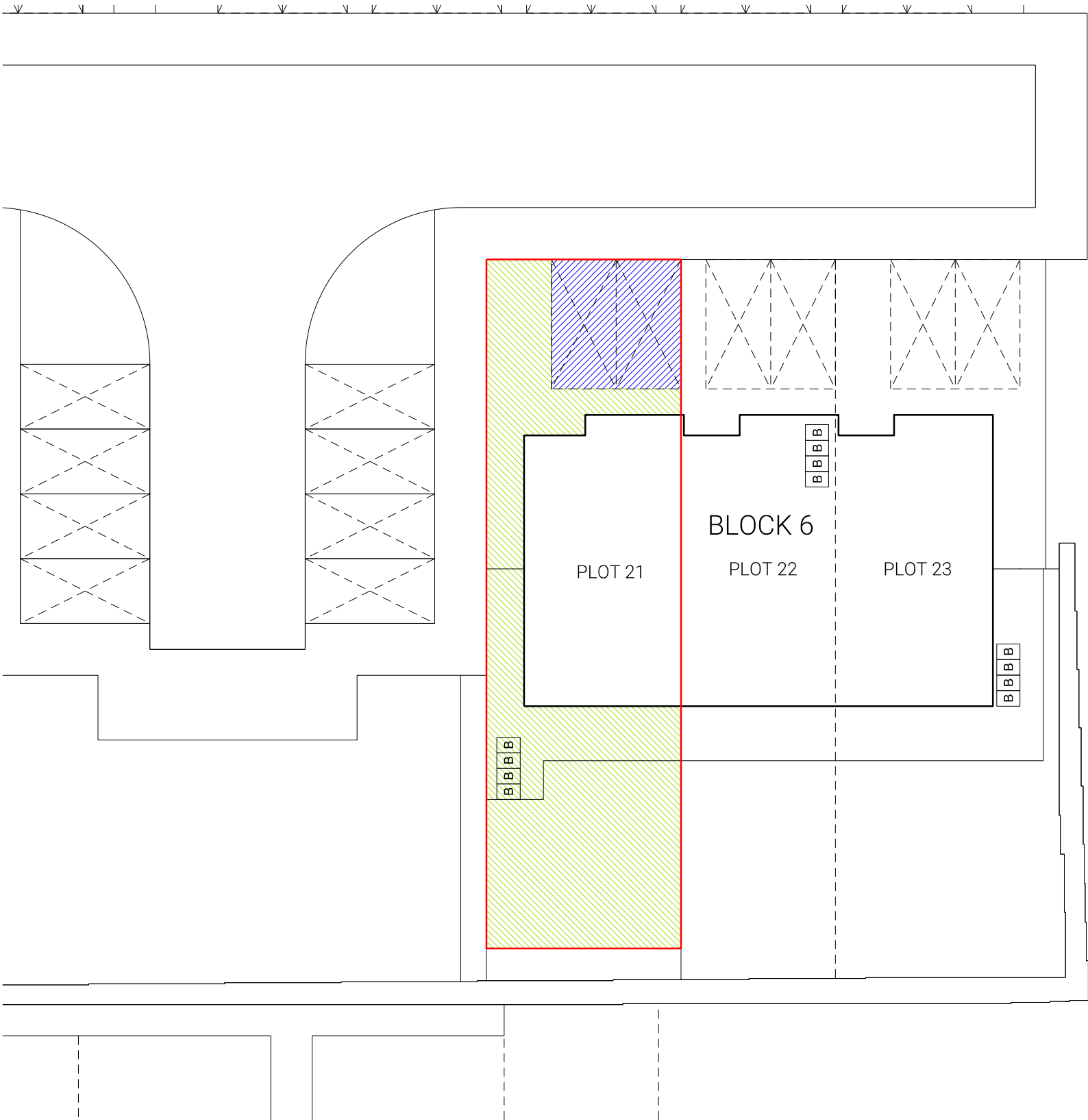

APPLICABLE REGULATIONS

CDM 2015 & HASAW ACT 1974 (and all amendments) - Applies at all times.

Working at height Regs 2005 - Applies at all times.

Workplace (Health, Safety and Welfare) Regs 1992 - Applies at all times.

Control of Asbestos Regs 2012 - Applies at all times.

Notes

Rev	Description	Date	Issued
C2	Updated for rear path addition	Oct 24	RH



51 St Vincent Crescent
Glasgow
G3 8NQ

T 0141 221 6834
E mast@mastarchitects.co.uk
W mastarchitects.co.uk



MASTARCH Ltd trading as MAST Architects registered in Scotland, company number SC447111, whose registered office is at 51 St Vincent Crescent, Glasgow, G3 8NQ

DO NOT SCALE FROM DRAWINGS
All dimensions to be checked on site by the Contractor and any discrepancies to be notified to the Architect prior to works being commenced. Use Figured dimensions only.

©All Rights Reserved. Copyright in all documents and drawings prepared by MAST Architects and in any work executed from those documents and drawings shall remain the property of MAST Architects.

Client
CCG Homes (Ltd)

Scale	Sheet Size	Job No.
1:200	A3	3333

Originator	Checked	Date
RH	-	Nov 23

Project
Madeira Street,
Greenock

Drawing Title	Rev
Plot 21 - Title Deed	A5-C2

Drawing No.
3333-MST-S1-
GF-D-A-PM_40_40_15-1741

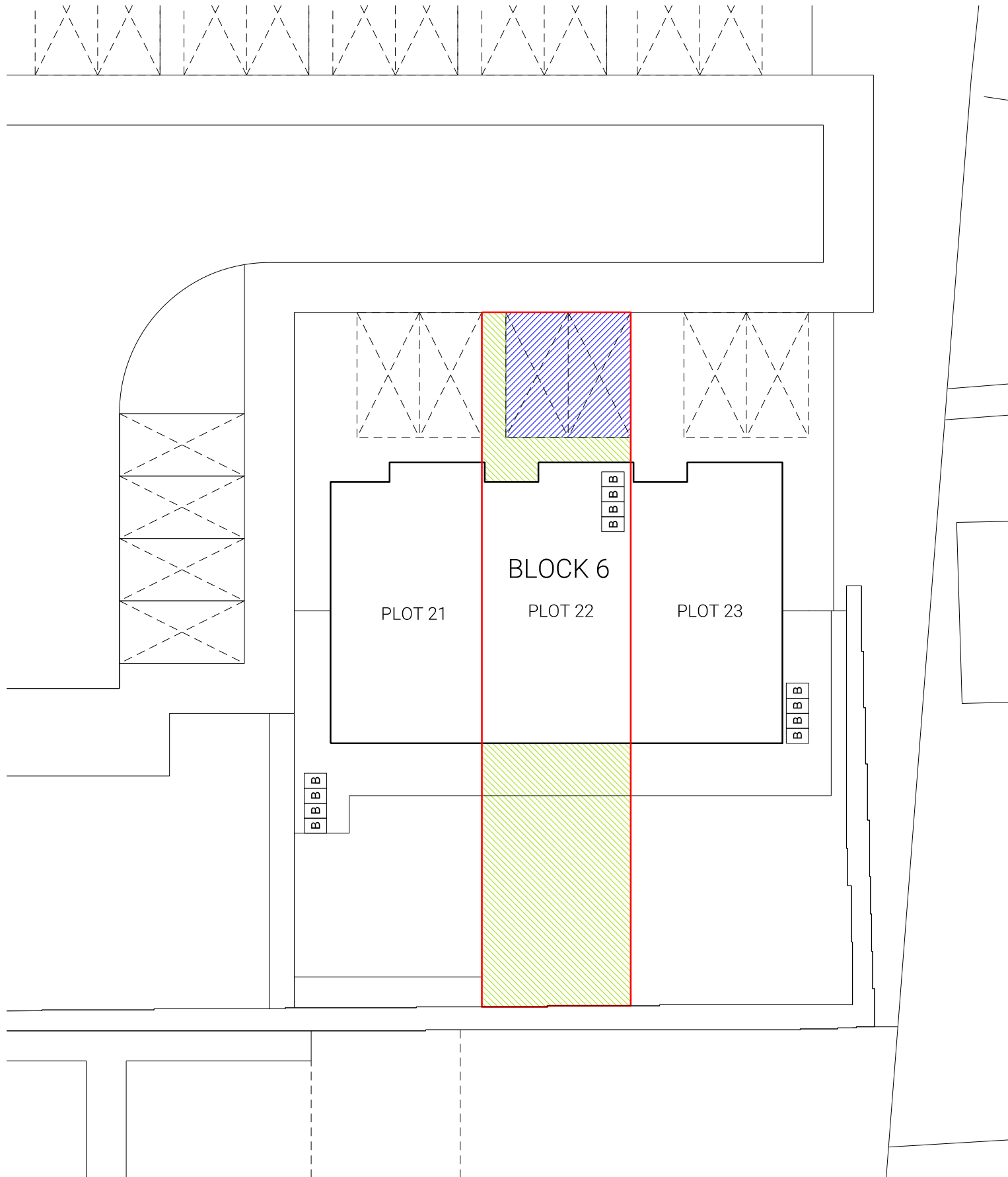

- PLOT TITLE BOUNDARY**
- PARKING SPACE TO PLOT (HATCHED BLUE)**
- GARDEN AREA TO PLOT (HATCHED GREEN)**

APPLICABLE REGULATIONS

CDM 2015 & HASAW ACT 1974 (and all amendments) - Applies at all times.
Working at height Regs 2005 - Applies at all times.
Workplace (Health, Safety and Welfare) Regs 1992 - Applies at all times.
Control of Asbestos Regs 2012 - Applies at all times.

Notes

Rev	Description	Date	Issued
C2	Updated for rear path addition	Oct 24	RH

0 1 2 4 6 8
SCALE (M) 1:200

51 St Vincent Crescent
Glasgow
G3 8NQ

T 0141 221 6834
E mast@mastarchitects.co.uk
W mastarchitects.co.uk



MASTARCH Ltd trading as MAST Architects registered in Scotland, company number SC447111, whose registered office is at 51 St Vincent Crescent, Glasgow, G3 8NQ

DO NOT SCALE FROM DRAWINGS
All dimensions to be checked on site by the Contractor and any discrepancies to be notified to the Architect prior to works being commenced. Use Figured dimensions only.

©All Rights Reserved. Copyright in all documents and drawings prepared by MAST Architects and in any work executed from those documents and drawings shall remain the property of MAST Architects.

Client

CCG Homes (Ltd)

Scale 1:200 Sheet Size A3 Job No. 3333

Originator RH Checked - Date Nov 23

Project
Madeira Street,
Greenock

Drawing Title Plot 22 - Title Deed Rev A5-C2

Drawing No.
3333-MST-S1-
GF-D-A-PM_40_40_15-1742



- PLOT TITLE BOUNDARY**
- PARKING SPACE TO PLOT (HATCHED BLUE)**
- GARDEN AREA TO PLOT (HATCHED GREEN)**

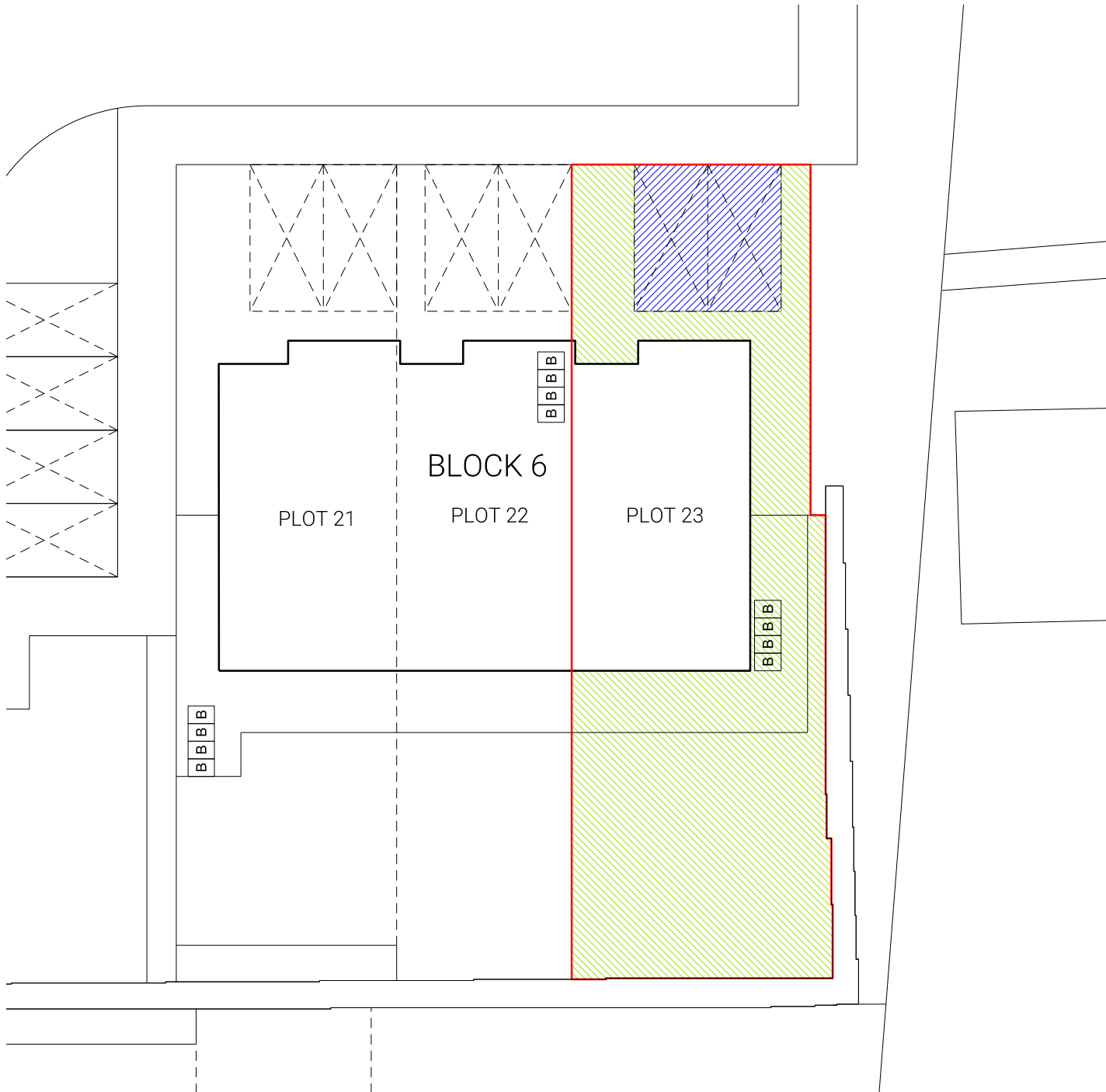

APPLICABLE REGULATIONS

CDM 2015 & HASAW ACT 1974 (and all amendments) - Applies at all times.
Working at height Regs 2005 - Applies at all times.
Workplace (Health, Safety and Welfare) Regs 1992 - Applies at all times.
Control of Asbestos Regs 2012 - Applies at all times.

Notes

Rev	Description	Date	Issued
C2	Updated for rear path addition	Oct 24	RH

0 1 2 4 6 8
SCALE (M) 1:200

51 St Vincent Crescent
Glasgow
G3 8NQ

T 0141 221 6834
E mast@mastarchitects.co.uk
W mastarchitects.co.uk



MASTARCH Ltd trading as MAST Architects registered in Scotland, company number SC447111, whose registered office is at 51 St Vincent Crescent, Glasgow, G3 8NQ

DO NOT SCALE FROM DRAWINGS
All dimensions to be checked on site by the Contractor and any discrepancies to be notified to the Architect prior to works being commenced. Use Figured dimensions only.

©All Rights Reserved. Copyright in all documents and drawings prepared by MAST Architects and in any work executed from those documents and drawings shall remain the property of MAST Architects.

Client

CCG Homes (Ltd)

Scale	Sheet Size	Job No.
1:200	A3	3333

Originator	Checked	Date
RH	-	Nov 23

Project
**Madeira Street,
Greenock**

Drawing Title	Rev
Plot 23 - Title Deed	A5-C2

Drawing No.
**3333-MST-S1-
GF-D-A-PM_40_40_15-1743**



- PLOT TITLE BOUNDARY
- PARKING SPACE TO PLOT (HATCHED BLUE)
- GARDEN AREA TO PLOT (HATCHED GREEN)

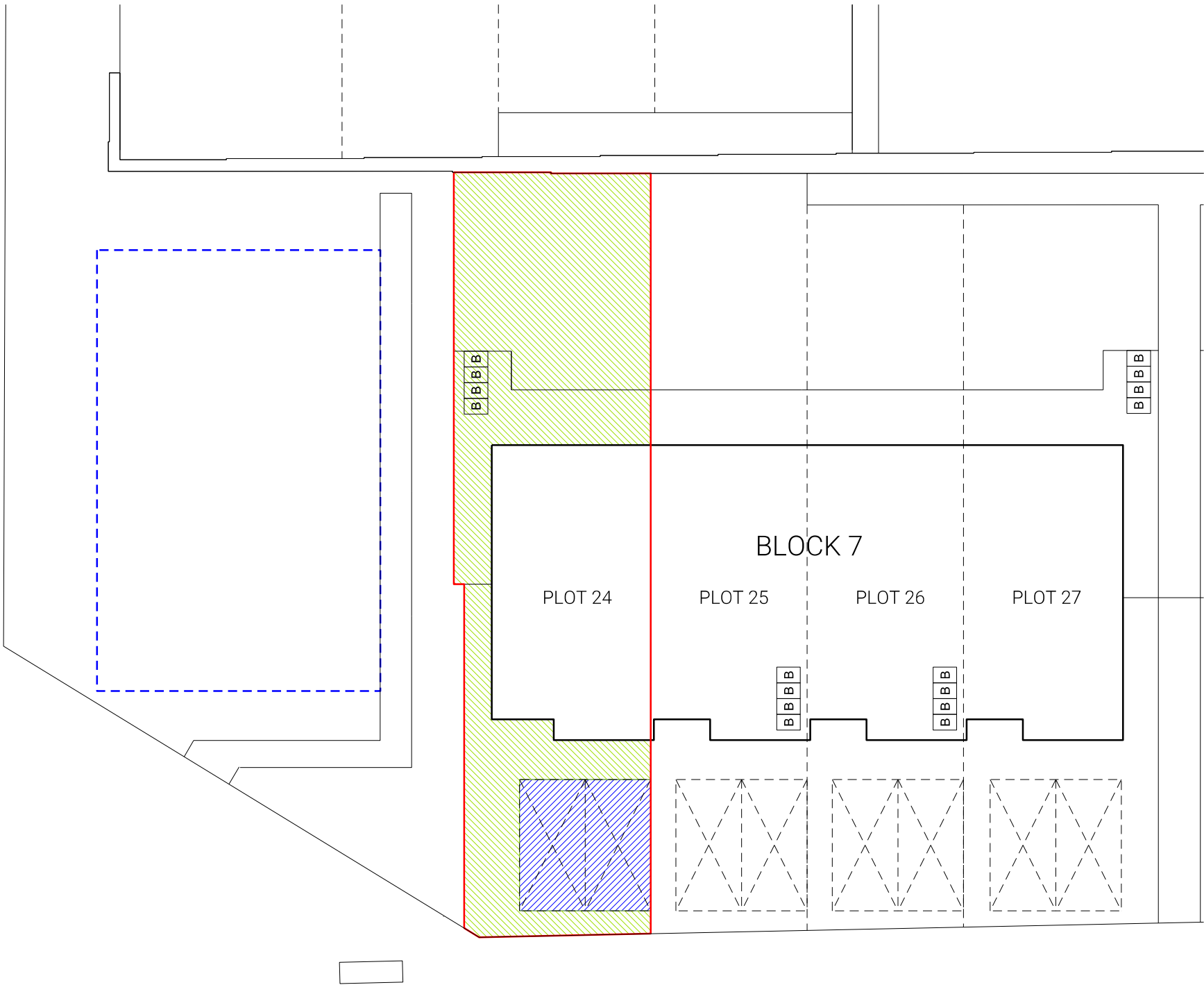

APPLICABLE REGULATIONS
CDM 2015 & HASAW ACT 1974 (and all amendments) - Applies at all times.
Working at height Regs 2005 - Applies at all times.
Workplace (Health, Safety and Welfare) Regs 1992 - Applies at all times.
Control of Asbestos Regs 2012 - Applies at all times.

Notes			
Rev	Description	Date	Issued
C2	Updated for rear path addition	Oct 24	RH



51 St Vincent Crescent
Glasgow
G3 8NQ

T 0141 221 6834
E mast@mastarchitects.co.uk
W mastarchitects.co.uk

MAST
ARCHITECTS

MASTARCH Ltd trading as MAST Architects registered in Scotland, company number SC447111, whose registered office is at 51 St Vincent Crescent, Glasgow, G3 8NQ

DO NOT SCALE FROM DRAWINGS
All dimensions to be checked on site by the Contractor and any discrepancies to be notified to the Architect prior to works being commenced. Use Figured dimensions only.

©All Rights Reserved. Copyright in all documents and drawings prepared by MAST Architects and in any work executed from those documents and drawings shall remain the property of MAST Architects.

Client		
CCG Homes (Ltd)		
Scale	Sheet Size	Job No.
1:200	A3	3333
Originator	Checked	Date
RH	-	Nov 23
Project		
Madeira Street, Greenock		
Drawing Title	Rev	
Plot 24 - Title Deed	A5-C2	
Drawing No.		
3333-MST-S1- GF-D-A-PM_40_40_15-1744		



- PLOT TITLE BOUNDARY
- PARKING SPACE TO PLOT (HATCHED BLUE)
- GARDEN AREA TO PLOT (HATCHED GREEN)

APPLICABLE REGULATIONS

CDM 2015 & HASAW ACT 1974 (and all amendments) - Applies at all times.
Working at height Regs 2005 - Applies at all times.
Workplace (Health, Safety and Welfare) Regs 1992 - Applies at all times.
Control of Asbestos Regs 2012 - Applies at all times.

Notes			
Rev	Description	Date	Issued
C2	Updated for rear path addition	Oct 24	RH



51 St Vincent Crescent
Glasgow
G3 8NQ

T 0141 221 6834
E mast@mastarchitects.co.uk
W mastarchitects.co.uk

MAST
ARCHITECTS

MASTARCH Ltd trading as MAST Architects registered in Scotland, company number SC447111, whose registered office is at 51 St Vincent Crescent, Glasgow, G3 8NQ

DO NOT SCALE FROM DRAWINGS
All dimensions to be checked on site by the Contractor and any discrepancies to be notified to the Architect prior to works being commenced. Use Figured dimensions only.

©All Rights Reserved. Copyright in all documents and drawings prepared by MAST Architects and in any work executed from those documents and drawings shall remain the property of MAST Architects.

Client		
CCG Homes (Ltd)		
Scale	Sheet Size	Job No.
1:200	A3	3333
Originator	Checked	Date
RH	-	Nov 23
Project		
Madeira Street, Greenock		
Drawing Title	Rev	
Plot 25 - Title Deed	A5-C2	
Drawing No.		
3333-MST-S1- GF-D-A-PM_40_40_15-1745		



- PLOT TITLE BOUNDARY
- PARKING SPACE TO PLOT (HATCHED BLUE)
- GARDEN AREA TO PLOT (HATCHED GREEN)

APPLICABLE REGULATIONS

CDM 2015 & HASAW ACT 1974 (and all amendments) - Applies at all times.

Working at height Regs 2005 - Applies at all times.

Workplace (Health, Safety and Welfare) Regs 1992 - Applies at all times.

Control of Asbestos Regs 2012 - Applies at all times.

Notes			
Rev	Description	Date	Issued
C2	Updated for rear path addition	Oct 24	RH



51 St Vincent Crescent
Glasgow
G3 8NQ

T 0141 221 6834
E mast@mastarchitects.co.uk
W mastarchitects.co.uk

MAST

ARCHITECTS

MASTARCH Ltd trading as MAST Architects registered in Scotland, company number SC447111, whose registered office is at 51 St Vincent Crescent, Glasgow, G3 8NQ

DO NOT SCALE FROM DRAWINGS
All dimensions to be checked on site by the Contractor and any discrepancies to be notified to the Architect prior to works being commenced. Use Figured dimensions only.

©All Rights Reserved. Copyright in all documents and drawings prepared by MAST Architects and in any work executed from those documents and drawings shall remain the property of MAST Architects.

Client		
CCG Homes (Ltd)		
Scale	Sheet Size	Job No.
1:200	A3	3333
Originator	Checked	Date
RH	-	Nov 23
Project		
Madeira Street, Greenock		
Drawing Title	Rev	
Plot 26 - Title Deed	A5-C2	
Drawing No.		
3333-MST-S1- GF-D-A-PM_40_40_15-1746		



- PLOT TITLE BOUNDARY**
- PARKING SPACE TO PLOT (HATCHED BLUE)**
- GARDEN AREA TO PLOT (HATCHED GREEN)**

APPLICABLE REGULATIONS

CDM 2015 & HASAW ACT 1974 (and all amendments) - Applies at all times.

Working at height Regs 2005 - Applies at all times.

Workplace (Health, Safety and Welfare) Regs 1992 - Applies at all times.

Control of Asbestos Regs 2012 - Applies at all times.

Notes			
Rev	Description	Date	Issued
C2	Updated for rear path addition	Oct 24	RH



51 St Vincent Crescent
Glasgow
G3 8NQ

T 0141 221 6834
E mast@mastarchitects.co.uk
W mastarchitects.co.uk

MAST
ARCHITECTS

MASTARCH Ltd trading as MAST Architects registered in Scotland, company number SC447111, whose registered office is at 51 St Vincent Crescent, Glasgow, G3 8NQ

DO NOT SCALE FROM DRAWINGS
All dimensions to be checked on site by the Contractor and any discrepancies to be notified to the Architect prior to works being commenced. Use Figured dimensions only.

©All Rights Reserved. Copyright in all documents and drawings prepared by MAST Architects and in any work executed from those documents and drawings shall remain the property of MAST Architects.

Client		
CCG Homes (Ltd)		
Scale	Sheet Size	Job No.
1:200	A3	3333
Originator	Checked	Date
RH	-	Nov 23
Project		
Madeira Street, Greenock		
Drawing Title	Rev	
Plot 27 - Title Deed	A5-C2	
Drawing No.		
3333-MST-S1- GF-D-A-PM_40_40_15-1747		



- PLOT TITLE BOUNDARY
- PARKING SPACE TO PLOT (HATCHED BLUE)
- GARDEN AREA TO PLOT (HATCHED GREEN)

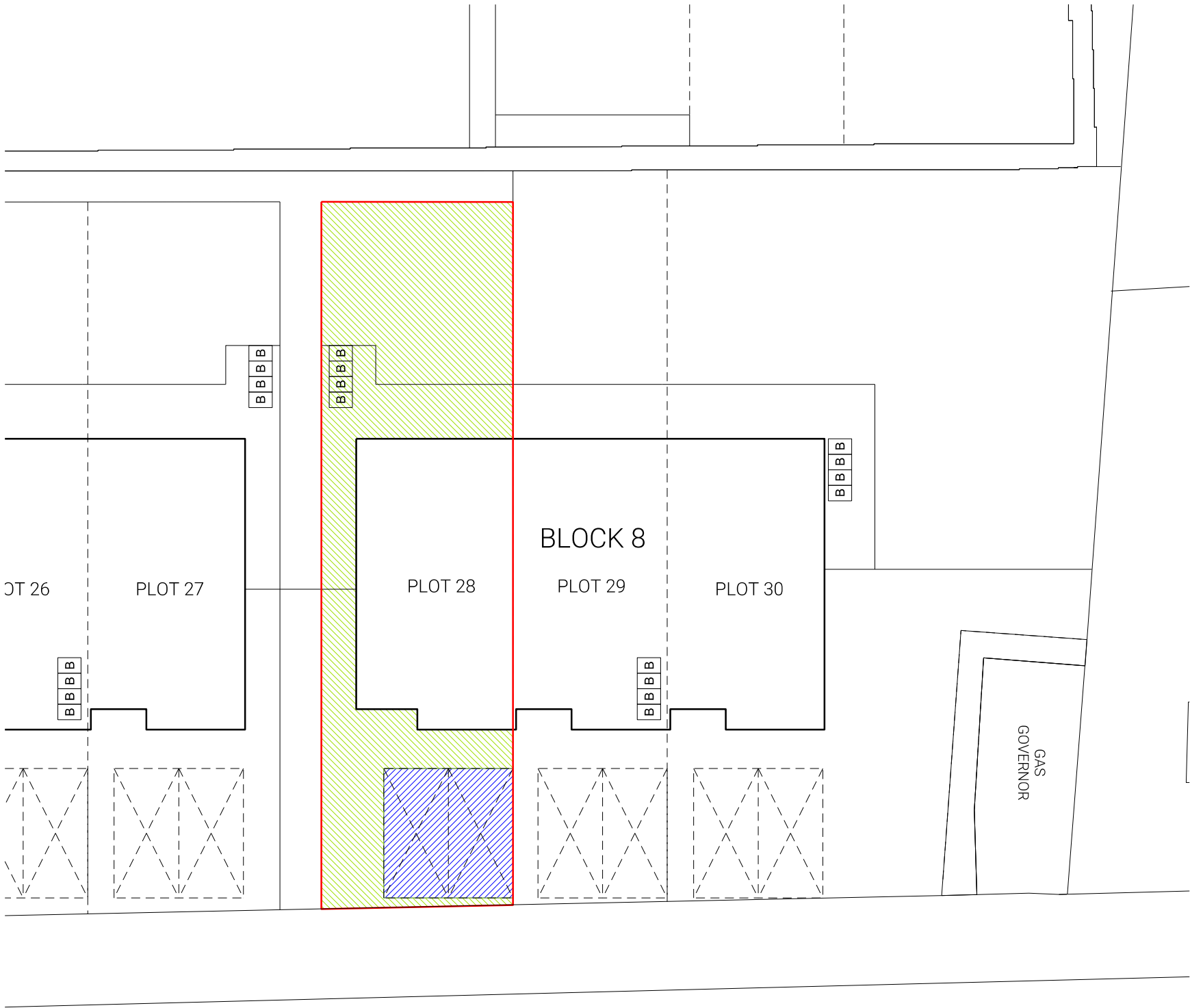

APPLICABLE REGULATIONS
CDM 2015 & HASAW ACT 1974 (and all amendments) - Applies at all times.
Working at height Regs 2005 - Applies at all times.
Workplace (Health, Safety and Welfare) Regs 1992 - Applies at all times.
Control of Asbestos Regs 2012 - Applies at all times.

Notes

Rev	Description	Date	Issued
C2	Updated for rear path addition	Oct 24	RH



51 St Vincent Crescent
Glasgow
G3 8NQ

T 0141 221 6834
E mast@mastarchitects.co.uk
W mastarchitects.co.uk

MAST
ARCHITECTS

MASTARCH Ltd trading as MAST Architects registered in Scotland, company number SC447111, whose registered office is at 51 St Vincent Crescent, Glasgow, G3 8NQ

DO NOT SCALE FROM DRAWINGS
All dimensions to be checked on site by the Contractor and any discrepancies to be notified to the Architect prior to works being commenced. Use Figured dimensions only.

©All Rights Reserved. Copyright in all documents and drawings prepared by MAST Architects and in any work executed from those documents and drawings shall remain the property of MAST Architects.

Client

CCG Homes (Ltd)

Scale

1:200

Sheet Size

A3

Job No.

3333

Originator

RH

Checked

-

Date

Nov 23

Project

Madeira Street,
Greenock

Drawing Title

Plot 28 - Title Deed

Rev

A5-C2

Drawing No.

3333-MST-S1-
GF-D-A-PM_40_40_15-1748



- PLOT TITLE BOUNDARY
- PARKING SPACE TO PLOT (HATCHED BLUE)
- GARDEN AREA TO PLOT (HATCHED GREEN)

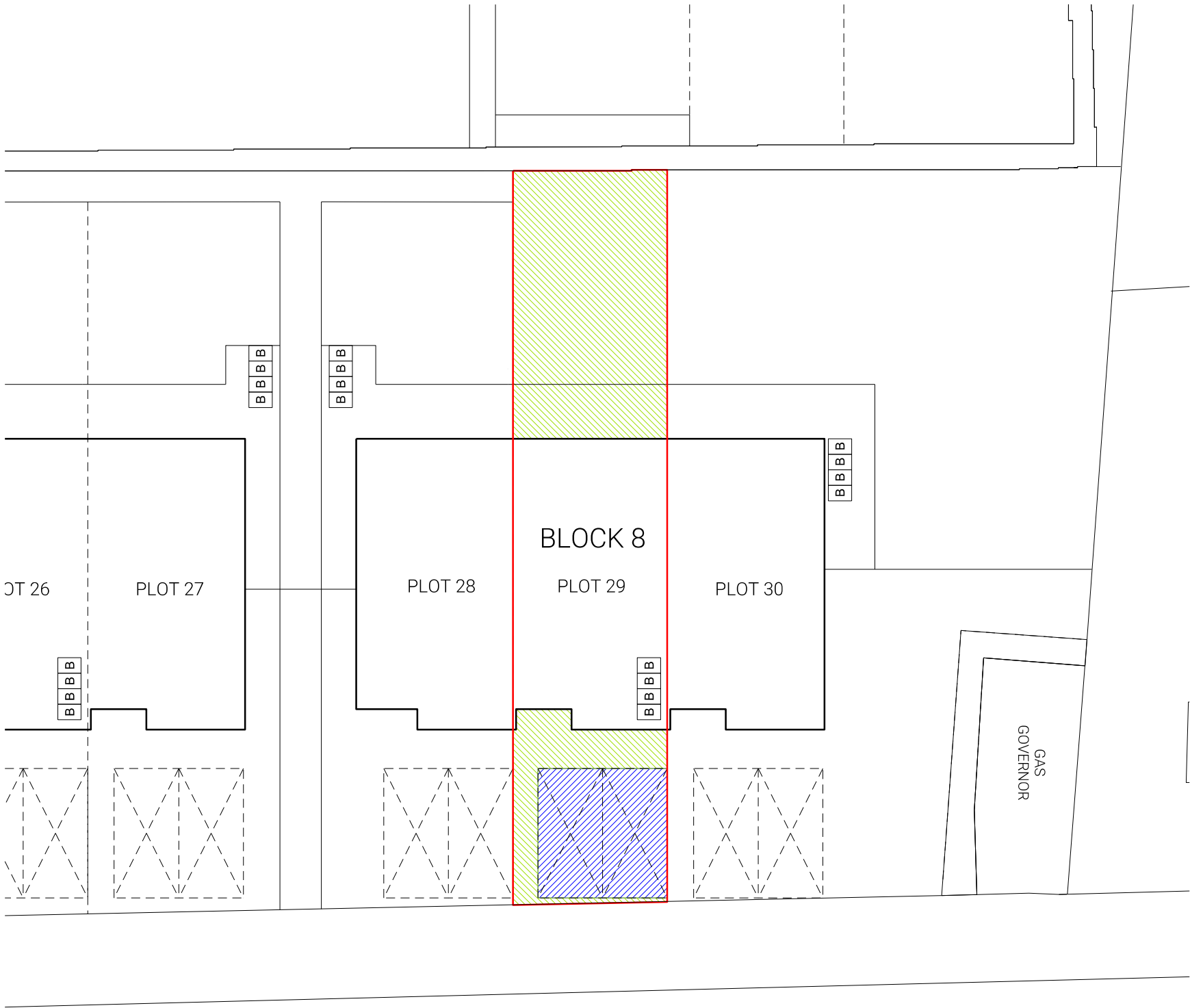

APPLICABLE REGULATIONS
CDM 2015 & HASAW ACT 1974 (and all amendments) - Applies at all times.
Working at height Regs 2005 - Applies at all times.
Workplace (Health, Safety and Welfare) Regs 1992 - Applies at all times.
Control of Asbestos Regs 2012 - Applies at all times.

Notes			
Rev	Description	Date	Issued
C2	Updated for rear path addition	Oct 24	RH



51 St Vincent Crescent
Glasgow
G3 8NQ

T 0141 221 6834
E mast@mastarchitects.co.uk
W mastarchitects.co.uk

MAST

ARCHITECTS

MASTARCH Ltd trading as MAST Architects registered in Scotland, company number SC447111, whose registered office is at 51 St Vincent Crescent, Glasgow, G3 8NQ

DO NOT SCALE FROM DRAWINGS
All dimensions to be checked on site by the Contractor and any discrepancies to be notified to the Architect prior to works being commenced. Use Figured dimensions only.

©All Rights Reserved. Copyright in all documents and drawings prepared by MAST Architects and in any work executed from those documents and drawings shall remain the property of MAST Architects.

Client

CCG Homes (Ltd)

Scale

1:200

Sheet Size

A3

Job No.

3333

Originator

RH

Checked

-

Date

Nov 23

Project

Madeira Street,
Greenock

Drawing Title

Plot 29 - Title Deed

Rev

A5-C2

Drawing No.

3333-MST-S1-
GF-D-A-PM_40_40_15-1749



- PLOT TITLE BOUNDARY
- PARKING SPACE TO PLOT (HATCHED BLUE)
- GARDEN AREA TO PLOT (HATCHED GREEN)

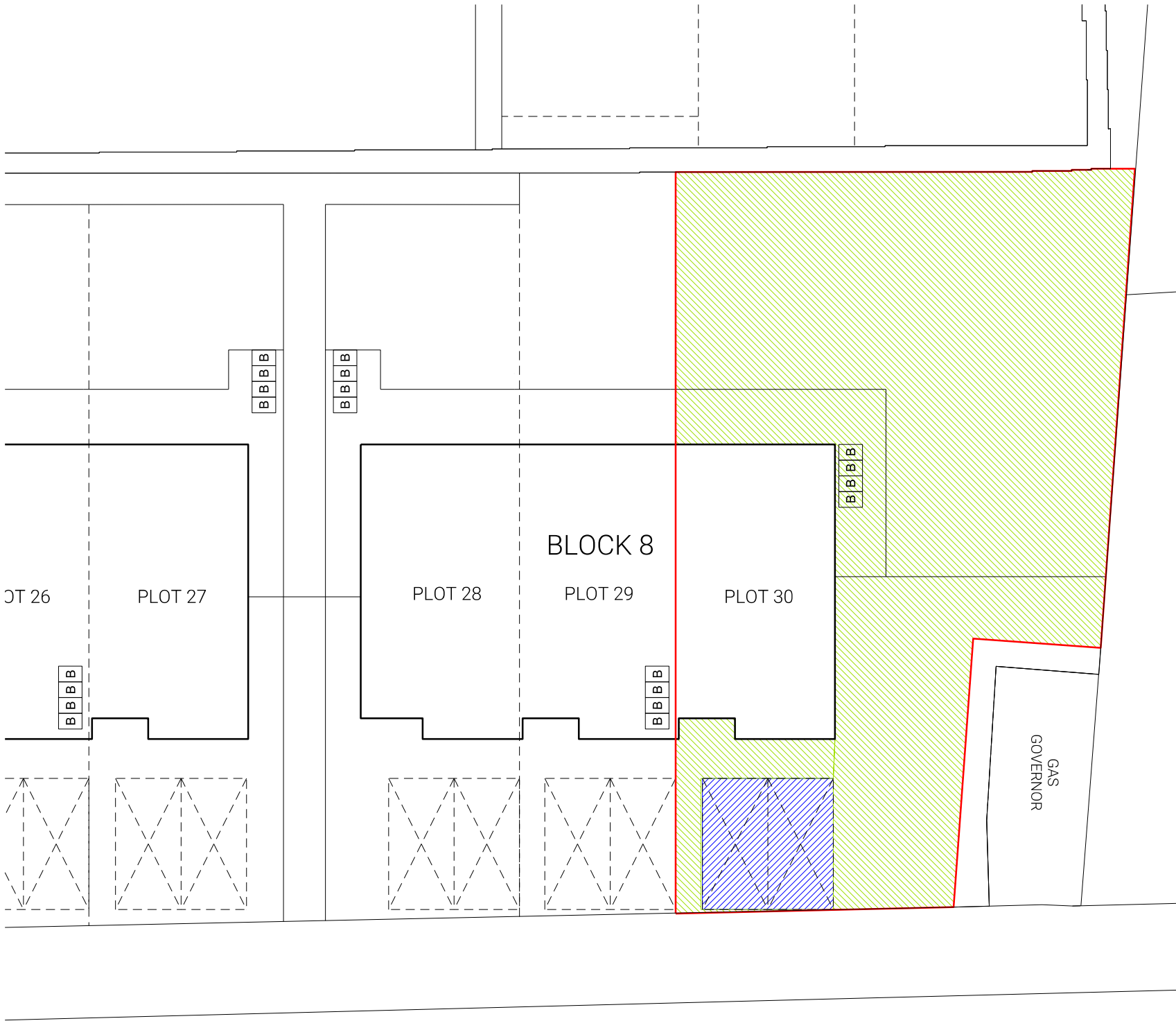

APPLICABLE REGULATIONS
CDM 2015 & HASAW ACT 1974 (and all amendments) - Applies at all times.
Working at height Regs 2005 - Applies at all times.
Workplace (Health, Safety and Welfare) Regs 1992 - Applies at all times.
Control of Asbestos Regs 2012 - Applies at all times.

Notes			
Rev	Description	Date	Issued
C2	Updated for rear path addition	Oct 24	RH



51 St Vincent Crescent
Glasgow
G3 8NQ

T 0141 221 6834
E mast@mastarchitects.co.uk
W mastarchitects.co.uk

MAST
ARCHITECTS

MASTARCH Ltd trading as MAST Architects registered in Scotland, company number SC447111, whose registered office is at 51 St Vincent Crescent, Glasgow, G3 8NQ

DO NOT SCALE FROM DRAWINGS
All dimensions to be checked on site by the Contractor and any discrepancies to be notified to the Architect prior to works being commenced. Use Figured dimensions only.

©All Rights Reserved. Copyright in all documents and drawings prepared by MAST Architects and in any work executed from those documents and drawings shall remain the property of MAST Architects.

Client

CCG Homes (Ltd)

Scale
1:200

Sheet Size
A3

Job No.
3333

Originator
RH

Checked
-

Date
Nov 23

Project

Madeira Street,
Greenock

Drawing Title

Plot 30 - Title Deed

Rev
A5-C2

Drawing No.

3333-MST-S1-
GF-D-A-PM_40_40_15-1750