

- 1
- SHARED DRIVEWAY SHARED  
BETWEEN PLOTS 1 - 2 ONLY
- 2
- SHARED DRIVEWAY SHARED  
BETWEEN PLOTS 78 - 83 ONLY
- 3
- SHARED DRIVEWAY SHARED  
BETWEEN PLOTS 54 - 55 ONLY
- 4
- SHARED DRIVEWAY SHARED  
BETWEEN PLOTS 50 - 53 ONLY
- 5
- SHARED DRIVEWAY SHARED  
BETWEEN PLOTS 28 - 29 ONLY

DEED OF CONDITIONS -  
LEGEND

- ADOPTED ROADS / PATHS / PARKING  
NORTH AYRSHIRE COUNCIL MAINTAINED
- ADOPTED VERGE  
FACTOR MAINTAINED
- XX

PRIVATE PARKING COURT / DRIVEWAY. PLOT SPECIFIC -  
FACTOR MAINTAINED
- XX

PRIVATE PARKING SPACE
- SHARED FOOTPATH  
FACTOR MAINTAINED
- KEEPMOAT LEGAL BOUNDARY
- FEU BOUNDARY (PLOT & PARKING)
- PUBLIC OPEN SPACE  
FACTOR MAINTAINED
- VP

NON-ADOPTED VISITOR PARKING SPACE  
FACTOR MAINTAINED
- HARD STANDING FOR BIN COLLECTION  
FACTOR MAINTAINED
- PUMPING STATION  
TRANSFERRED TO & VESTED WITH SCOTTISH WATER
- SUDS POND  
TRANSFERRED TO & VESTED WITH SCOTTISH WATER  
LANDSCAPING FACTOR MAINTAINED
- ACCESS TO SUDS POND & PUMPING STATION.  
FACTOR MAINTAINED
- EXISTING DRAINAGE SERVITUDE OVER PLOTS 25-27.  
TO REMAIN IN PLACE.

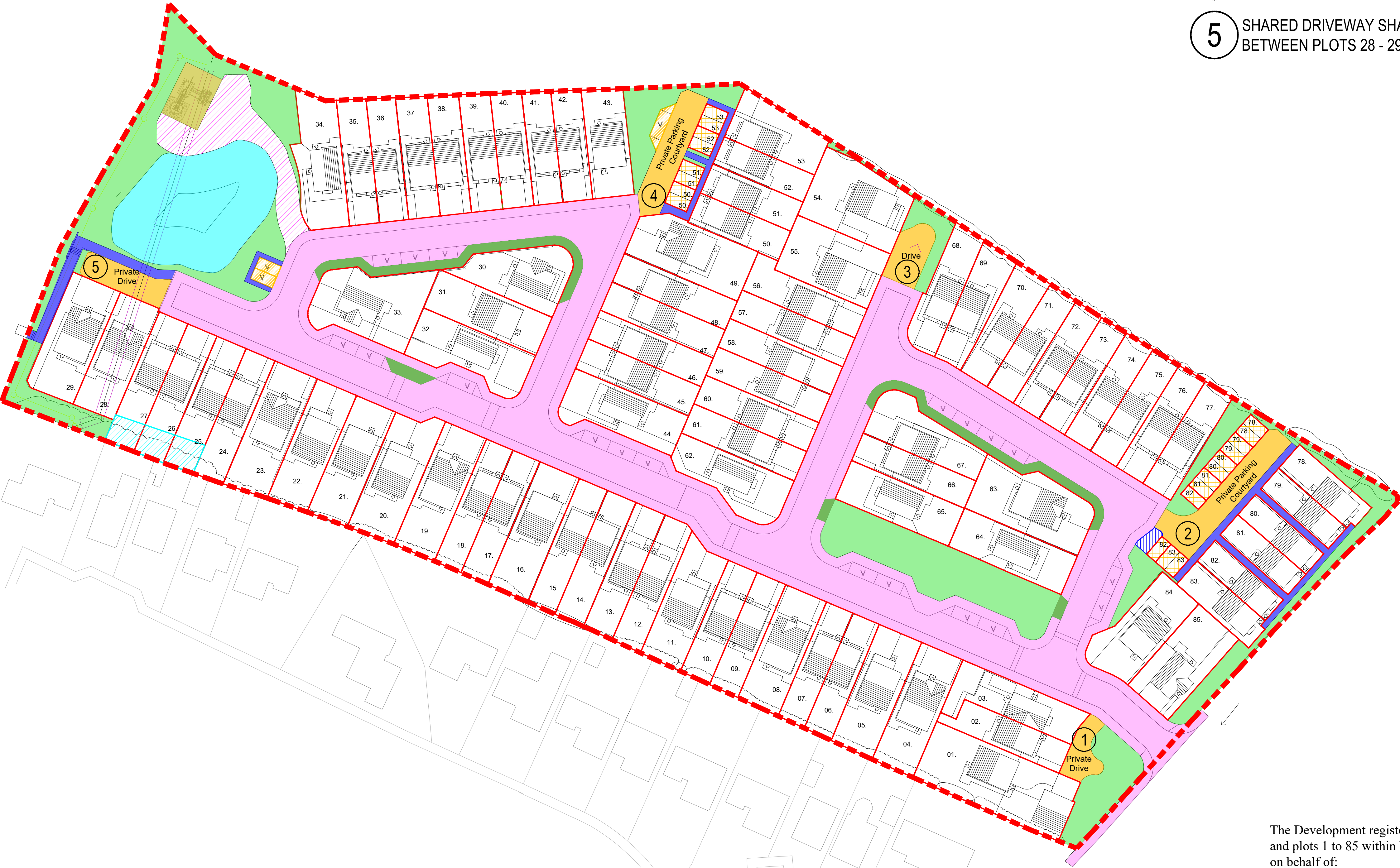

The Development registered under title AYR80831 and plots 1 to 85 within have been DPA approved on behalf of:

*The Keeper – 06 May 2025*

Keeper for the Registers of Scotland

N

1:500

0m 5m 10m 15m 20m 25m 30m

AMENDMENTS:

I	25.04.25	Parking bays reverted to plot ownership - JH
H	25.03.25	Layout amended to reflect ROC approval. Minor changes to road pattern and junctions. Grass verge shown for clarity - JH
G	30.01.25	Parking bay hatch changed for clarity - JH
F	12.10.24	Site boundary updated to reflect KM land ownership. Minor adjustment to plot red lines - JH
E	24.09.24	Site boundary updated to reflect KM land ownership. Plot 85 boundary adjusted to ensure site frontage included within common areas - JH
D	20.09.24	Updated to reflect Site Layout Rev BBB. Boundary of Plot 01 changed to ensure site frontage maintained by factor
C	16.08.24	Plots 50-53, 78-83 parking spaces changed from Plot owned to Factored with rights over - JS
B	10.06.24	Updated to reflect Site Layout Rev ZZ & Existing Drainage Servitude added over Plots 25-27 - LM
A	07.06.24	Updated to reflect Site Layout Rev WW
Issue:	Date:	Description:

Keepmoat  
Homes

Keepmoat, The Waterfront, Lakeside  
Boulevard, Doncaster, DN4 5PL.  
Tel: 01302 347605 [www.keepmoat.com](http://www.keepmoat.com)

Project:

Mosculloch Farm,  
Kilwinning,  
North Ayrshire

Drawing:

**Keepmoat Homes**  
Deed of Conditions

Scale:  
1:500 @ A1

Date:  
25/01/24

Drawn:  
LM

Drawing No.  
887-KMH-LGL-DR-A-001

Rev.  
1