



Key

- Overall Site Boundary
- Shared Common Areas Within Flatted Blocks
- Shared Private Driveways (see ownership schedule)
- Shared Private Courtyards (see ownership schedule)



Cairnlee House, Callendar Business Park
 Callendar Road, Falkirk, FK1 1XE.
 Tel 01324 600000 Fax 01324 600001
 www.cala.co.uk

JOB TITLE
Edinburgh, West Criags

DRAWING TITLE
**DPA Site Plan
 Ground Level**

SCALE: 1:750 SHEET SIZE: A1 DATE: Jul 23

DRAWN BY: DM	PRELIMINARY	FINAL
CHECKED BY:	CENTRAL MASTERED	DEVELOPMENT MASTERED
SITE: EA00213	MCCOSKER	VER MOD DRG No. REV PLOT
		DPA(00) L

Copyright Cala Management Limited

OWNERSHIP SCHEDULE

- SHARED PRIVATE DRIVE (1) - between Plots 130 and 131
- SHARED PRIVATE COURTYARD (1) - between Plots 168 through 213
- SHARED PRIVATE COURTYARD (2) - between Plots 143 through 155
- SHARED PRIVATE COURTYARD (3) - between Plots 214 through 232
- SHARED PRIVATE COURTYARD (4) - between Plots 233 through 251
- SHARED PRIVATE COURTYARD (5) - between Plots 85 through 96
- SHARED PRIVATE COURTYARD (6) - between Plots 51 through 66
- SHARED PRIVATE COURTYARD (7) - between Plots 276 through 285
- SHARED PRIVATE COURTYARD (8) - between Plots 269 through 275
- SHARED PRIVATE COURTYARD (9) - between Plots 32 through 39
- SHARED PRIVATE COURTYARD (10) - between Plots 253 through 267
- SHARED PRIVATE COURTYARD (11) - between Plots 1 through 10

- EXTERNAL REFUSE STORE (1) - between Plots 168-179, 180, 181, 183, 185
- EXTERNAL REFUSE STORE (2) - between Plots 182, 184, 186 through 198
- EXTERNAL REFUSE STORE (3) - between Plots 276 through 285
- EXTERNAL REFUSE STORE (4) - between Plots 268 through 275
- EXTERNAL REFUSE STORE (5) - between Plots 253 through 261
- EXTERNAL REFUSE STORE (6) - between Plots 1 through 10
- INTERNAL REFUSE STORE (1) - between Plots 199 through 213
- INTERNAL REFUSE STORE (2) - between 214 through 232
- INTERNAL REFUSE STORE (3) - between 233 through 252
- INTERNAL REFUSE STORE (4) - between 233 through 252
- INTERNAL BIKE STORE (1) - between Plots 168 through 198
- INTERNAL BIKE STORE (2) - between Plots 199 through 213
- INTERNAL BIKE STORE (3) - between Plots 214 through 232
- INTERNAL BIKE STORE (4) - between Plots 233 through 252

The Development registered under title MID234914 and plots 001 to 73, 78 to 94, 98, 99, 110, 124, 125, 165 to 168, 202, 204, 205, 208, 210, 212, 214 to 285 within have been DPA approved.

The Keeper - 04 March 2026

Keeper of the Registers of Scotland

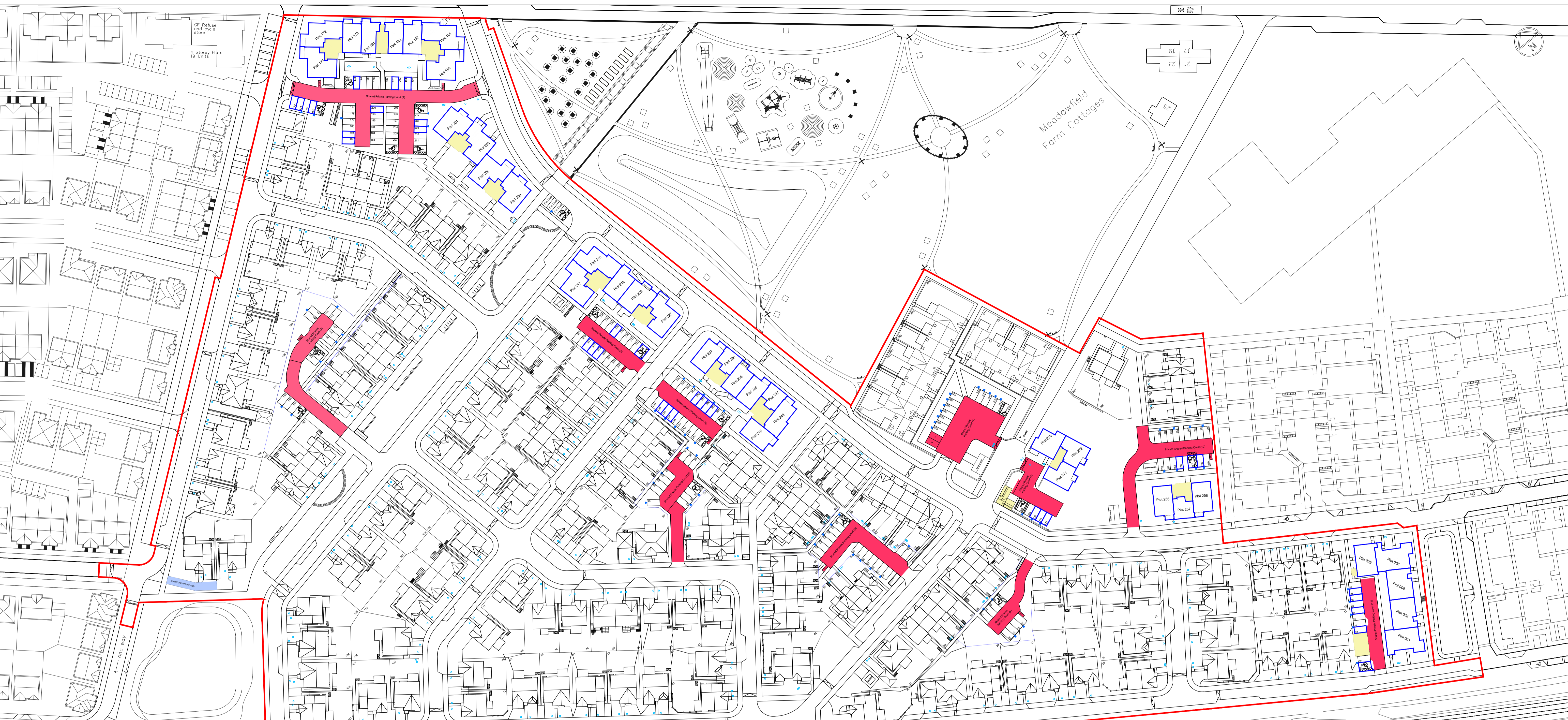

OWNERSHIP SCHEDULE

SHARED PRIVATE DRIVE (1) - between Plots 130 and 131

SHARED PRIVATE COURTYARD (1) - between Plots 168 through 213

SHARED PRIVATE COURTYARD (2) - between Plots 143 through 155

SHARED PRIVATE COURTYARD (3) - between Plots 214 through 232

SHARED PRIVATE COURTYARD (4) - between Plots 233 through 251

SHARED PRIVATE COURTYARD (5) - between Plots 85 through 96

SHARED PRIVATE COURTYARD (6) - between Plots 51 through 66

SHARED PRIVATE COURTYARD (7) - between Plots 276 through 285

SHARED PRIVATE COURTYARD (8) - between Plots 269 through 275

SHARED PRIVATE COURTYARD (9) - between Plots 32 through 39

SHARED PRIVATE COURTYARD (10) - between Plots 253 through 267

SHARED PRIVATE COURTYARD (11) - between Plots 1 through 10

EXTERNAL REFUSE STORE (1) - between Plots 168-179, 180,181,183,185

EXTERNAL REFUSE STORE (2) - between Plots 182,184,186 through 198

EXTERNAL REFUSE STORE (3) - between Plots 276 through 285

EXTERNAL REFUSE STORE (4) - between Plots 268 through 275

EXTERNAL REFUSE STORE (5) - between Plots 253 through 261

EXTERNAL REFUSE STORE (6) - between Plots 1 through 10

INTERNAL REFUSE STORE (1) - between Plots 199 through 213

INTERNAL REFUSE STORE (2) - between 214 through 232

INTERNAL REFUSE STORE (3) - between 233 through 252

INTERNAL REFUSE STORE (4) - between 233 through 252

INTERNAL BIKE STORE (1) - between Plots 168 through 198

INTERNAL BIKE STORE (2) - between Plots 199 through 213

INTERNAL BIKE STORE (3) - between Plots 214 through 232

INTERNAL BIKE STORE (4) - between Plots 233 through 252

Key

- Overall Site Boundary
- Shared Common Areas Within Flatted Blocks
- Shared Private Driveways (see ownership schedule)
- Shared Private Courtyards (see ownership schedule)



Cairnlee House, Callendar Business Park
 Callendar Road, Falkirk, FK1 1XE,
 Tel 01324 600000 Fax 01324 600001
 www.cala.co.uk

JOB TITLE
Edinburgh, West Criags

DRAWING TITLE
**DPA Site Plan
 1st Floor Level**

SCALE:1:750	SHEET SIZE:A1	DATE: Jul 23				
DRAWN BY: DM	PRELIMINARY	FINAL				
CHECKED BY:	CENTRAL MASTERED	DEVELOPMENT MASTERED				
SITE	McCOSKER	VER	MOD	DRG No.	REV	PLOT
EA00213				DPA(01)	L	

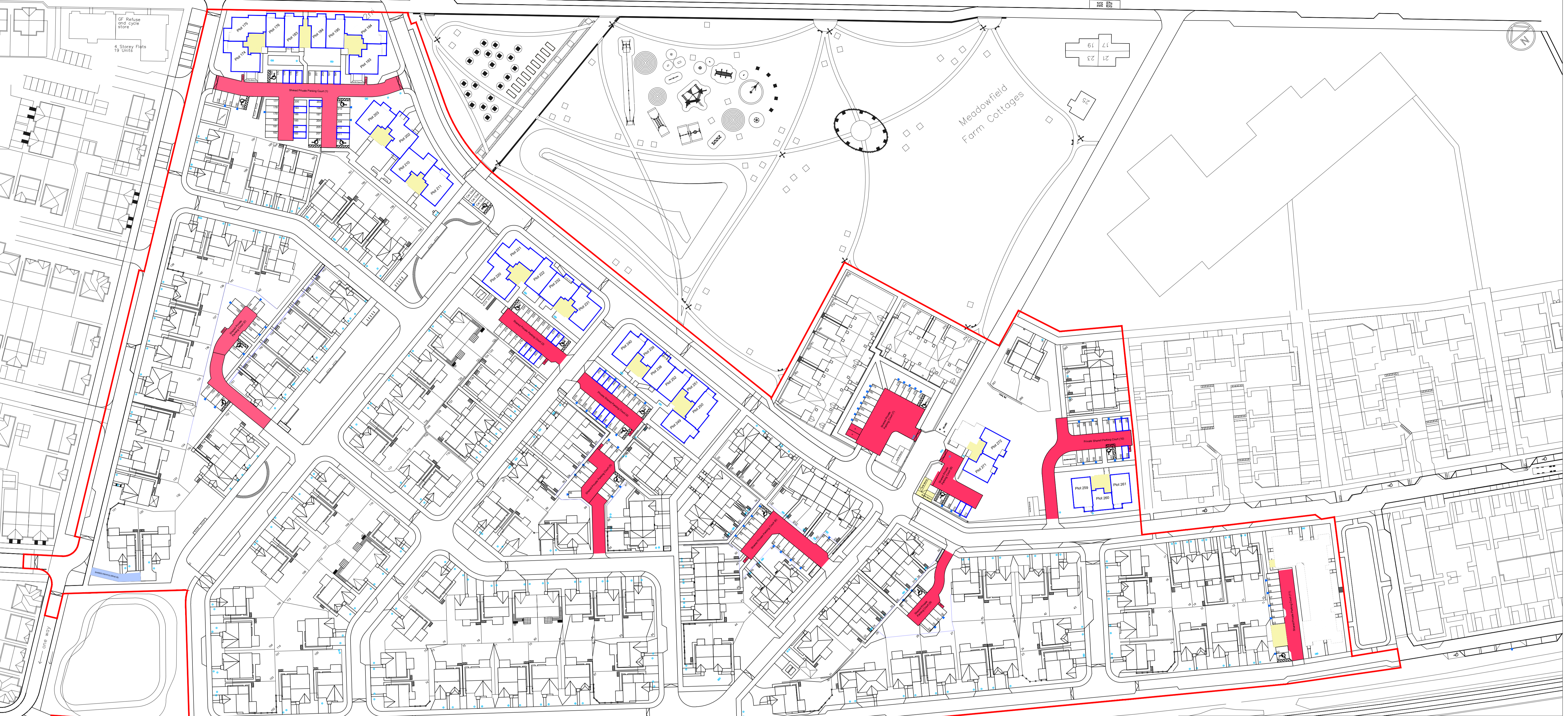
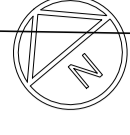

OWNERSHIP SCHEDULE

- SHARED PRIVATE DRIVE (1) - between Plots 130 and 131
- SHARED PRIVATE DRIVE (2) - between Plots 132 and 133
- SHARED PRIVATE DRIVE (3) - between Plots 134 and 135
- SHARED PRIVATE DRIVE (4) - between Plots 136 and 137
- SHARED PRIVATE DRIVE (5) - between Plots 138 and 139
- SHARED PRIVATE DRIVE (6) - between Plots 140 and 141
- SHARED PRIVATE DRIVE (7) - between Plots 142 and 143
- SHARED PRIVATE DRIVE (8) - between Plots 144 and 145
- SHARED PRIVATE DRIVE (9) - between Plots 146 and 147
- SHARED PRIVATE DRIVE (10) - between Plots 148 and 149
- SHARED PRIVATE DRIVE (11) - between Plots 150 and 151

- EXTERNAL REFUSE STORE (1) - between Plots 168-179, 180,181,183,185
- EXTERNAL REFUSE STORE (2) - between Plots 182,184,186 through 198
- EXTERNAL REFUSE STORE (3) - between Plots 276 through 285
- EXTERNAL REFUSE STORE (4) - between Plots 268 through 275
- EXTERNAL REFUSE STORE (5) - between Plots 253 through 261
- EXTERNAL REFUSE STORE (6) - between Plots 1 through 10
- INTERNAL REFUSE STORE (1) - between Plots 199 through 213
- INTERNAL REFUSE STORE (2) - between 214 through 232
- INTERNAL REFUSE STORE (3) - between 233 through 252
- INTERNAL REFUSE STORE (4) - between 233 through 252
- INTERNAL BIKE STORE (1) - between Plots 168 through 198
- INTERNAL BIKE STORE (2) - between Plots 199 through 213
- INTERNAL BIKE STORE (3) - between Plots 214 through 232
- INTERNAL BIKE STORE (4) - between Plots 233 through 252

Key

- Overall Site Boundary
- Shared Common Areas Within Flatted Blocks
- Shared Private Driveways (see ownership schedule)
- Shared Private Courtyards (see ownership schedule)



Cairnlee House, Callendar Business Park
 Callendar Road, Falkirk, FK1 1XE,
 Tel 01324 600000 Fax 01324 600001
 www.cala.co.uk

JOB TITLE
Edinburgh, West Criags

DRAWING TITLE
**DPA Site Plan
 2nd Floor Level**

SCALE:1:750 SHEET SIZE:A1 DATE: Jul 23

DRAWN BY: DM	PRELIMINARY	FINAL				
CHECKED BY:	CENTRAL MASTERED	DEVELOPMENT MASTERED				
SITE	MECOSKER	VER	MOD	DRG No.	REV	PLOT
EA00213				DPA(02)	L	

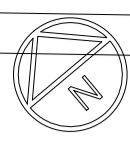

Meadowfield Farm Cottages

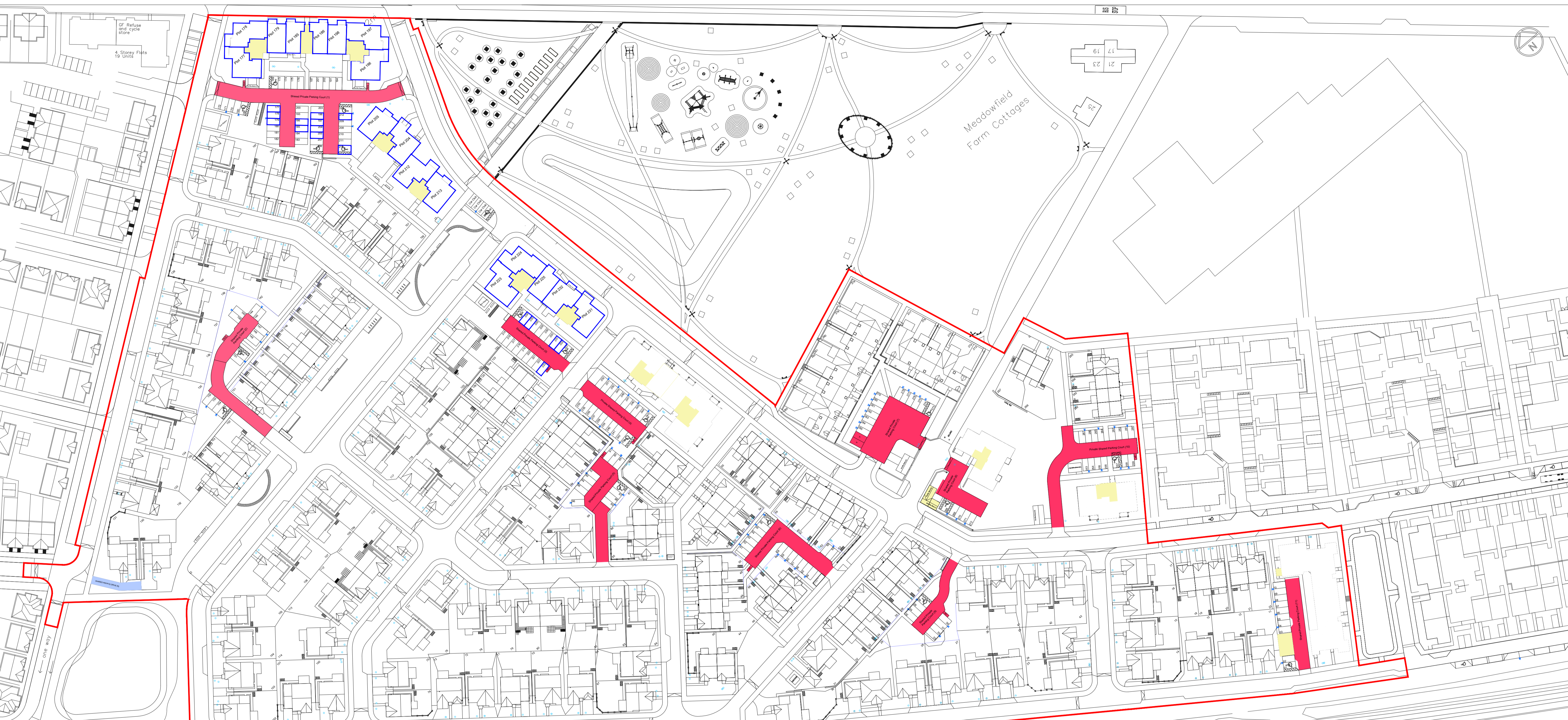

Key

- Overall Site Boundary
- Shared Common Areas Within Flatted Blocks
- Shared Private Driveways (see ownership schedule)
- Shared Private Courtyards (see ownership schedule)



Cairnlee House, Callendar Business Park
Callendar Road, Falkirk, FK1 1XE,
Tel 01324 600000 Fax 01324 600001
www.cala.co.uk

JOB TITLE
Edinburgh, West Criags

DRAWING TITLE
**DPA Site Plan
3rd Floor Level**

SCALE: 1:1000 SHEET SIZE: A1 DATE: Jul 23

DRAWN BY: DM	PRELIMINARY	FINAL
CHECKED BY:	CENTRAL MASTERED	DEVELOPMENT MASTERED
SITE: EA00213	MECOSKER	VER MOD DRG No. REV PLOT
		DPA(03) L

Copyright Cala Management Limited

OWNERSHIP SCHEDULE

- SHARED PRIVATE DRIVE (1) - between Plots 130 and 131
- SHARED PRIVATE COURTYARD (1) - between Plots 168 through 213
- SHARED PRIVATE COURTYARD (2) - between Plots 143 through 155
- SHARED PRIVATE COURTYARD (3) - between Plots 214 through 232
- SHARED PRIVATE COURTYARD (4) - between Plots 233 through 251
- SHARED PRIVATE COURTYARD (5) - between Plots 85 through 96
- SHARED PRIVATE COURTYARD (6) - between Plots 51 through 66
- SHARED PRIVATE COURTYARD (7) - between Plots 276 through 285
- SHARED PRIVATE COURTYARD (8) - between Plots 269 through 275
- SHARED PRIVATE COURTYARD (9) - between Plots 32 through 39
- SHARED PRIVATE COURTYARD (10) - between Plots 253 through 267
- SHARED PRIVATE COURTYARD (11) - between Plots 1 through 10

- EXTERNAL REFUSE STORE (1) - between Plots 168-179, 180,181,183,185
- EXTERNAL REFUSE STORE (2) - between Plots 182,184,186 through 198
- EXTERNAL REFUSE STORE (3) - between Plots 276 through 285
- EXTERNAL REFUSE STORE (4) - between Plots 268 through 275
- EXTERNAL REFUSE STORE (5) - between Plots 253 through 261
- EXTERNAL REFUSE STORE (6) - between Plots 1 through 10
- INTERNAL REFUSE STORE (1) - between Plots 199 through 213
- INTERNAL REFUSE STORE (2) - between 214 through 232
- INTERNAL REFUSE STORE (3) - between 233 through 252
- INTERNAL REFUSE STORE (4) - between 233 through 252
- INTERNAL BIKE STORE (1) - between Plots 168 through 198
- INTERNAL BIKE STORE (2) - between Plots 199 through 213
- INTERNAL BIKE STORE (3) - between Plots 214 through 232
- INTERNAL BIKE STORE (4) - between Plots 233 through 252