

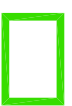

-  DENOTES DEVELOPMENT SUBJECTS
-  DENOTES PHASE 10 SUBJECTS
-  DENOTES FLAT BLOCK BOUNDARY
-  DENOTES ROADS & FOOTPATHS ADOPTED / TO BE ADOPTED BY THE LOCAL AUTHORITY
-  DENOTES COMMON STAIR (COMMUNALLY OWNED) AND MAINTAINED BY FACTOR
-  OPEN SPACE (COMMUNALLY OWNED) AND MAINTAINED BY FACTOR
-  DENOTES ROADS, FOOTPATHS AND HARDSTANDINGS MAINTAINED BY FACTOR
-  DENOTES WAYLEAVE
-  DENOTES ALLOCATED PARKING
-  DENOTES SUB-STATION OWNED AND MAINTAINED BY SCOTTISH POWER
-  DENOTES PATIO/BALCONY

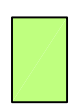

PHASE 10 SITE PLAN 1:500

OVERALL SITE PLAN  
1:2000

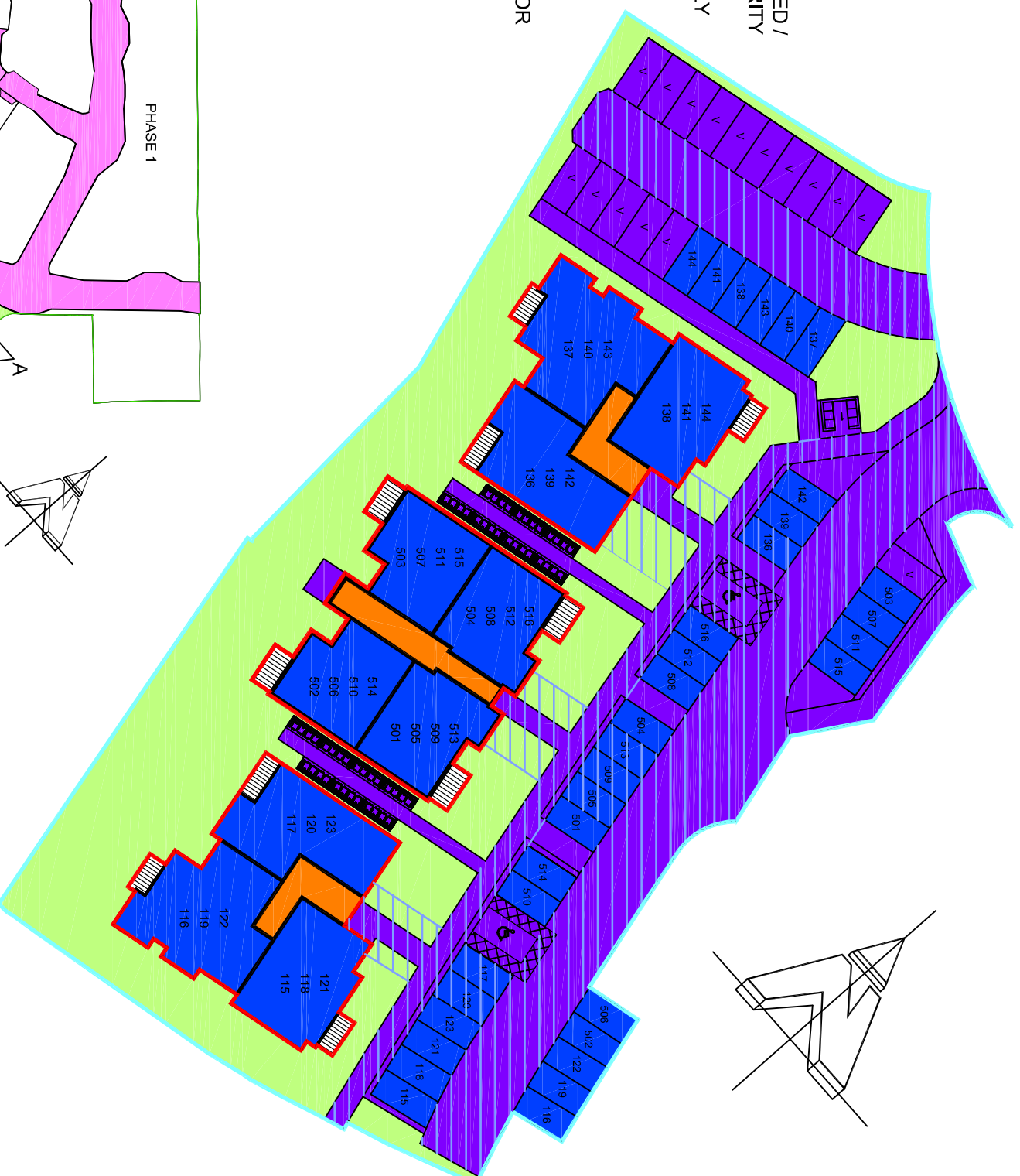

**Notes**

**DO NOT SCALE DRAWINGS**

The Development registered under Title STG60102 and Plots 115 to 123 (inclusive), Plots 136 to 144 (inclusive) and Plots 501 to 516 (inclusive) within have been DPA

approved by:

*I MacLaren – 2nd November 2016*

Iain MacLaren (DPA Officer)

REV	DATE	KEY UPDATED	HD
REV E	01-10-16	KEY UPDATED	HD
REV D	27-09-16	UPDATED FOLLOWING LAND REGISTERS	HD
COMMENTS			HD
REV C	14-06-16	UPDATED FOLLOWING H&R COMMENTS	HD
REV B	10-06-16	UPDATED FOLLOWING H&R COMMENTS	HD
REV A	23-05-16	UPDATED FOLLOWING H&R COMMENTS	HD

PRELIMINARY/APPROVED DRAWING

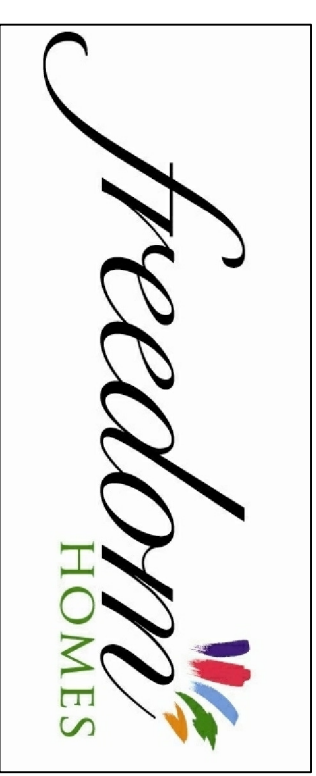

Project  
**STIRLING HIGH SCHOOL**

Drawing  
**MASTER DEED PLAN  
PHASE 10**

Scale  
**1:500, 1:2000**

Date	Job No.	Drawing No.	Rev.
05/16	69	MDOC-10	E
Drawn By	HD		