

The Development registered under title STG22696 and plots 1 to 7 within
have been DPA approved by:

Craig McFadden - 3 November 2016

Craig McFadden (DPA Officer)

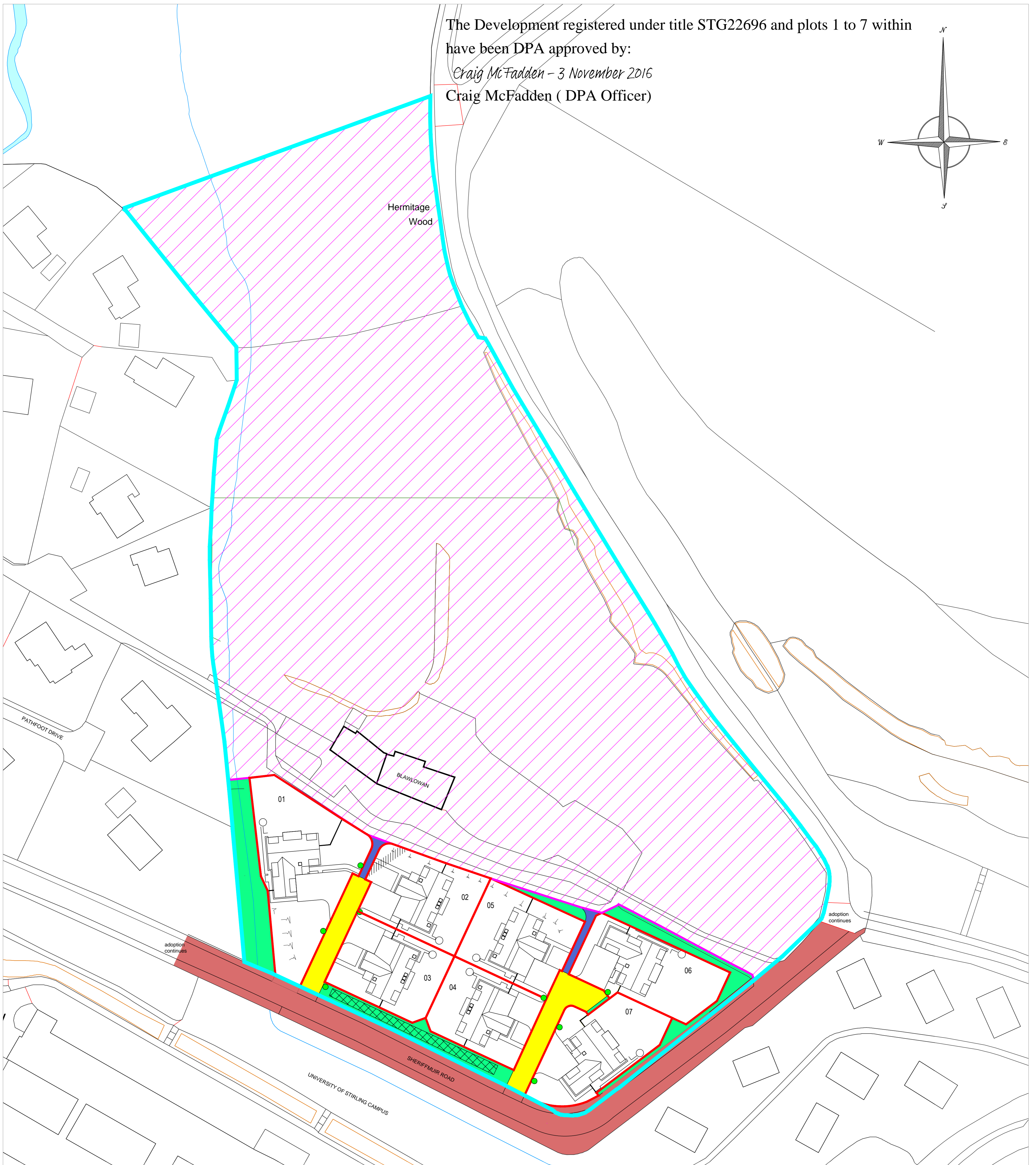
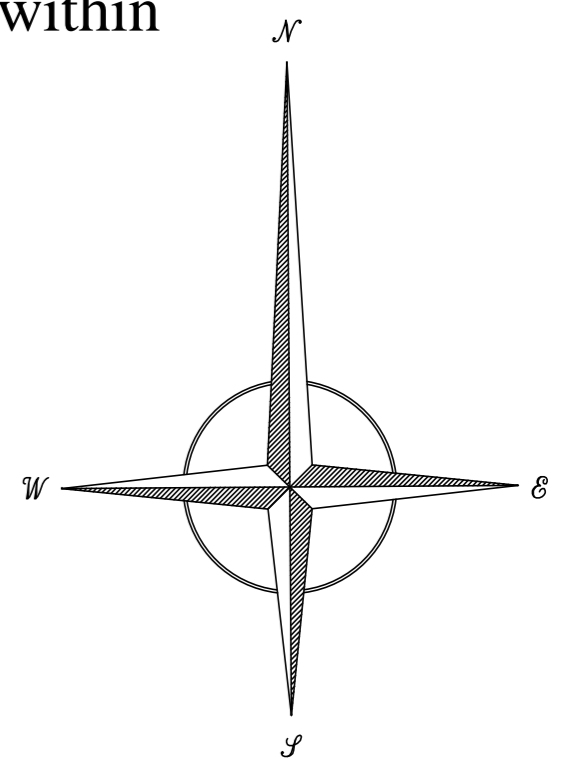

- DENOTES OPEN SPACE AREA TO BE OWNED BY THE RESIDENTS AND MAINTAINED BY THE APPOINTED FACTOR
- DENOTES PRIVATE PATH TO BE OWNED BY THE RESIDENTS AND MAINTAINED BY THE APPOINTED FACTOR
- DENOTES SHARED DRIVEWAY OWNED BY THE RESIDENTS AND MAINTAINED BY THE APPOINTED FACTOR
- DENOTES ROADS/FOOTPATHS/VERGE ADOPTED BY STIRLING COUNCIL
- DENOTES AREA WITHIN 'BLAWLOWAN' TITLE.
- DENOTES UNDERGROUND SUDS ATTENUATION MAINTAINED BY THE FACTOR.
- DENOTES AREA OF SERVITUDE RIGHTS
- DENOTES INDIVIDUAL PLOT BOUNDARY
- DENOTES CALA OWNERSHIP BOUNDARY
- DENOTES PRIVATE BOLLARD LIGHTING TO BE OWNED BY THE RESIDENTS AND MAINTAINED BY THE APPOINTED FACTOR (FEE PAYABLE TO FACTOR)



Cairnlee House, Callendar Business Park
Callendar Road, Falkirk, FK1 1XE,
tel 01324 600000 fax 01324 600101
www.cala.co.uk

Project Title :
Residential Development
Sheriffmuir Road, Bridge of Allan

Drawing Title :
Master Deed Plan

Scale : 1:500 @ A1 Date : JUN16 Drawn By : BT

Drawing Network Location :

Drawing Number :
0183_DP_00M