

## Inverkeithing

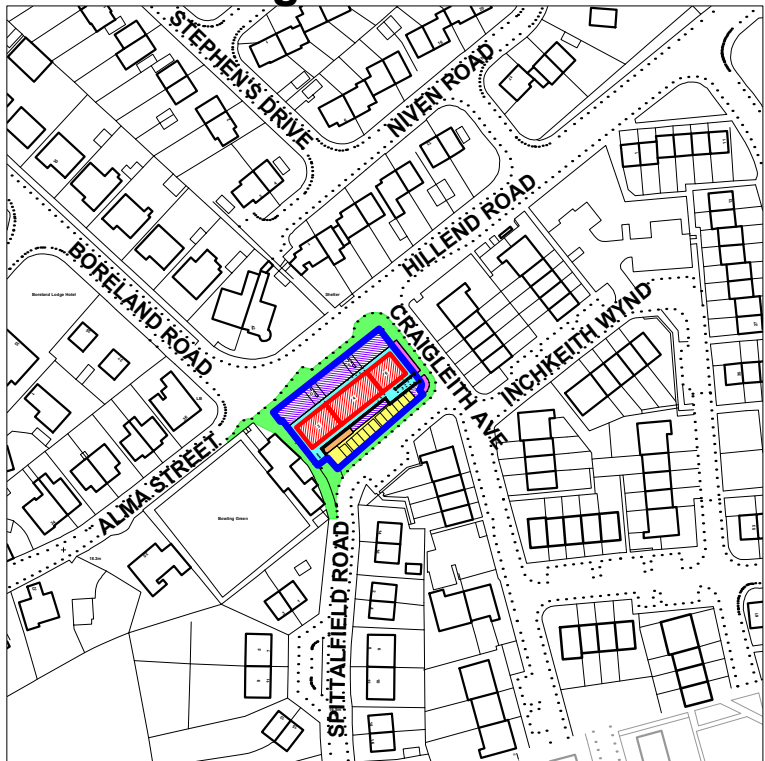

Location Plan Scale 1:2,500

Area hatched red: Extent of development.

- Area outlined dark blue: Extent of retail site.
- Area coloured light blue: Communal footpath areas held in common by 2, 4 & 6 Hillend Road.
- Areas hatched purple: Communal landscaped areas held in common by 2, 4 & 6 Hillend Road.
- Bins A, B & C and benches D & E are included within the landscaped areas hatched purple.
- Area coloured orange: Plant enclosure held in common by 2, 4 & 6 Hillend Road.
- Area coloured yellow: Associated car parking held in common by 2, 4 & 6 Hillend Road.
- Areas coloured pink: Service strip areas to be retained by Fife Council.
- Area coloured green: Footpaths adjacent to development adopted/to be adopted by Fife Council.
- Retaining walls marked X, Y & Z are held in common by 2, 4 & 6 Hillend Road.

Name Arran Swanson

Scale 1:250 @ A3

Deed of Conditions  
Development, Hillend Road  
Inverkeithing

Dwg No W19IK005 D

Rev No 01

Date 27/05/2019

Department

Property Services - Estates



This map is based upon Ordnance Survey material with the permission of Ordnance Survey on behalf of the Controller of Her Majesty's Stationery Office (c) Crown copyright. Unauthorised reproduction infringes Crown copyright and may lead to prosecution or civil proceedings. Fife Council 100023385 (2016)

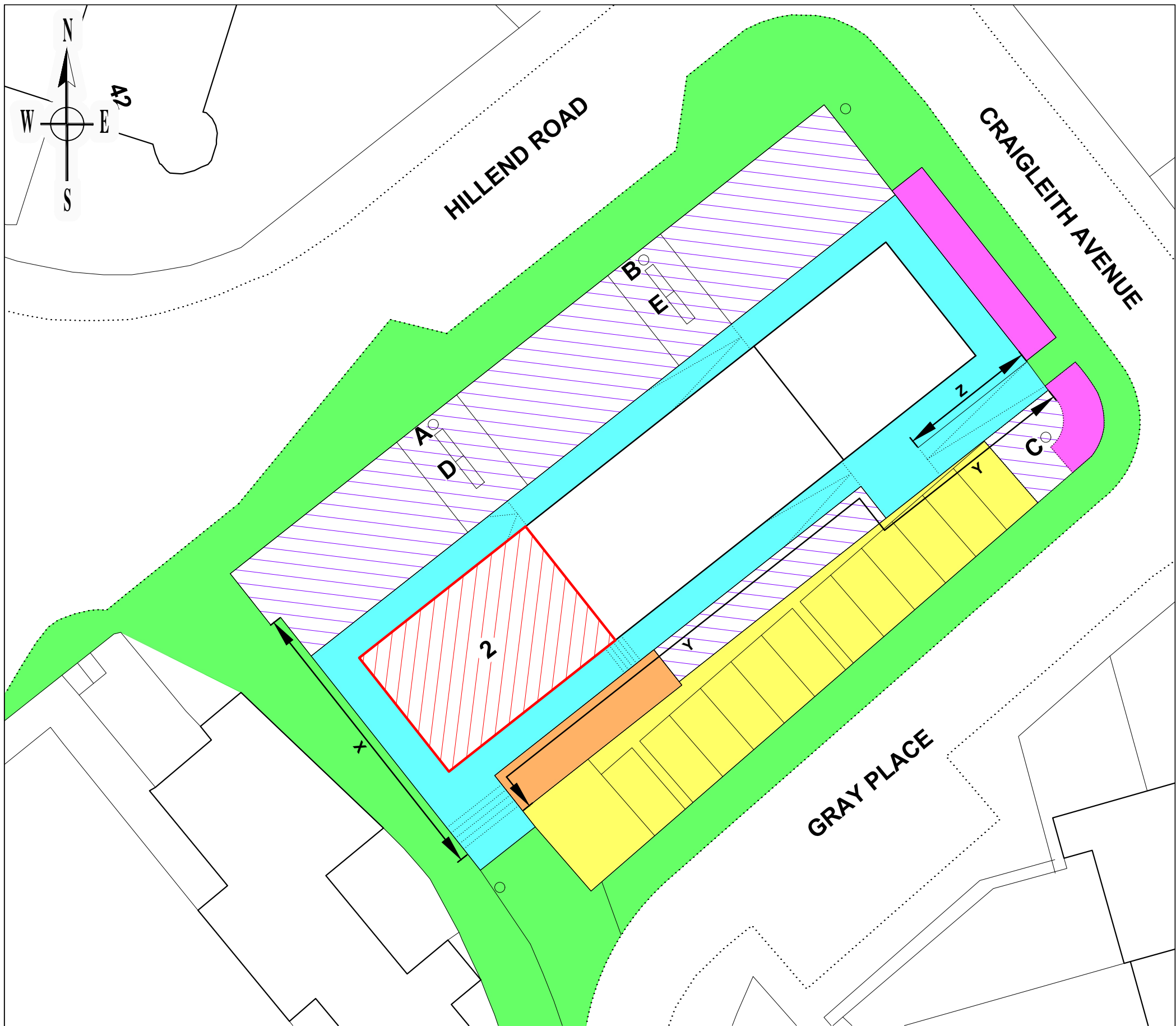

## Inverkeithing

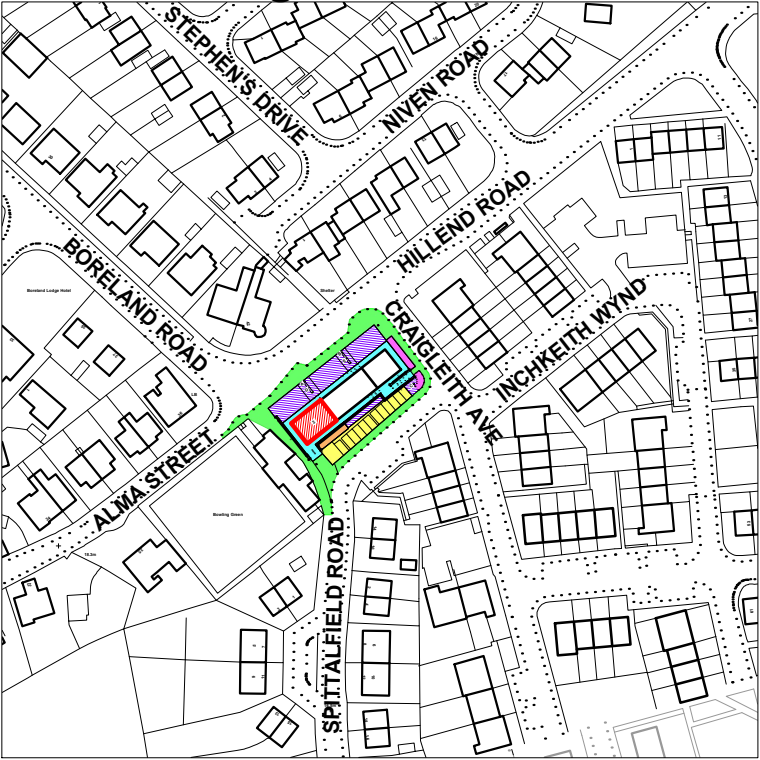

Location Plan Scale 1:2,500

- Area hatched red extends to 107m<sup>2</sup> or thereby.
- Area coloured light blue: Communal footpath areas held in common by 2, 4 & 6 Hillend Road.
- Areas hatched purple: Communal landscaped areas held in common by 2, 4 & 6 Hillend Road.
- Bins A, B & C and benches D & E are included within the landscaped areas hatched purple.
- Area coloured orange: Plant enclosure held in common by 2, 4 & 6 Hillend Road.
- Area coloured yellow: Associated car parking held in common by 2, 4 & 6 Hillend Road.
- Areas coloured pink: Service strip areas to be retained by Fife Council.
- Area coloured green: Footpaths adjacent to development adopted/to be adopted by Fife Council.
- Retaining walls marked X, Y & Z are held in common by 2, 4 & 6 Hillend Road.

Name Arran Swanson  
Scale 1:250 @ A3  
Deed Plan  
Retail Unit, 2 Hillend Road  
Inverkeithing

Dwg No W19IK005 C  
Rev No 01  
Date 27/05/2019

Department  
Property Services - Estates



This map is based upon Ordnance Survey material with the permission of Ordnance Survey on behalf of the Controller of Her Majesty's Stationery Office (c) Crown copyright. Unauthorised reproduction infringes Crown copyright and may lead to prosecution or civil proceedings. Fife Council 100023385 (2016)



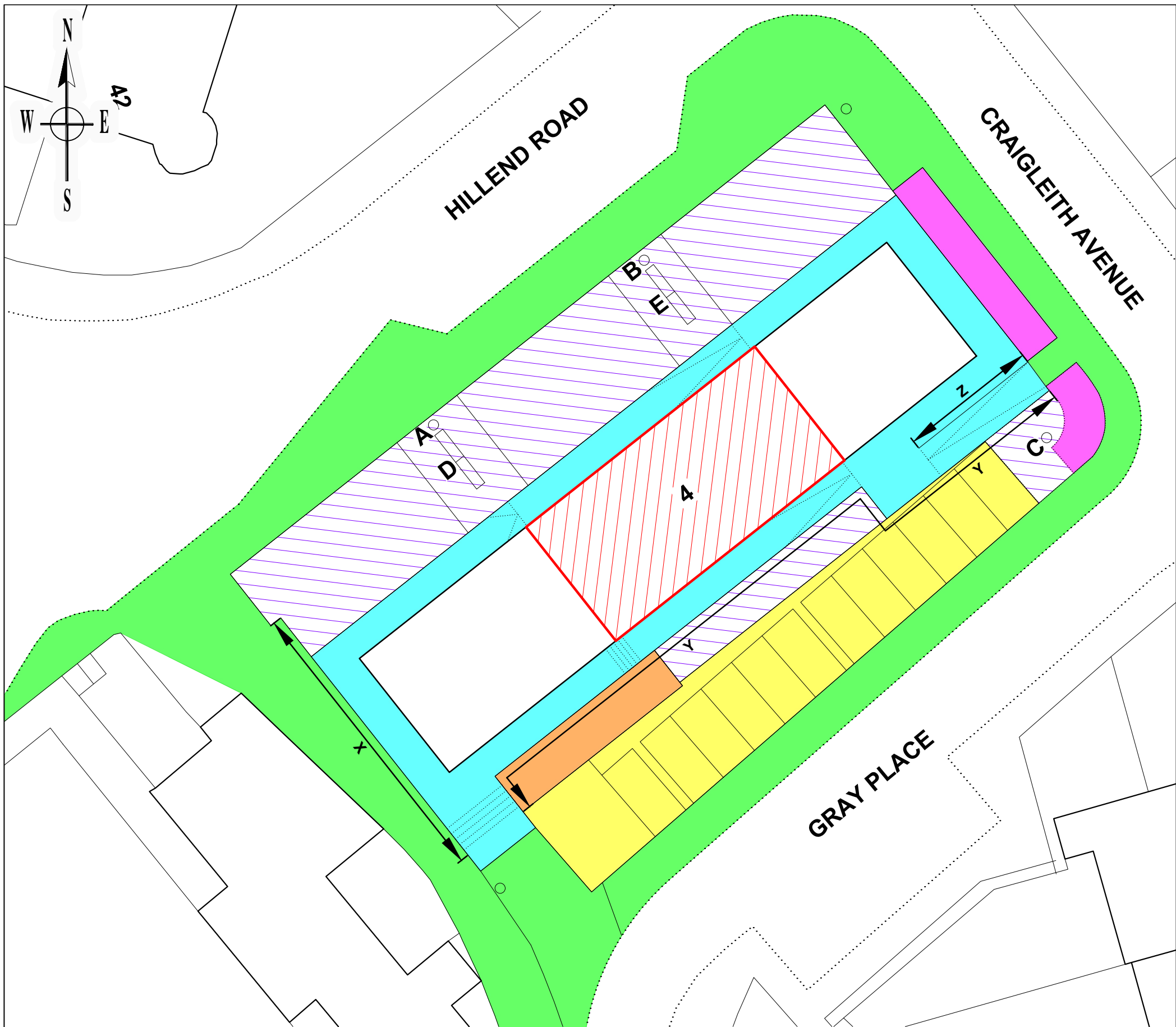

## Inverkeithing



Location Plan Scale 1:2,500

- Area hatched red extends to 147m<sup>2</sup> or thereby.
- Area coloured light blue: Communal footpath areas held in common by 2, 4 & 6 Hillend Road.
- Areas hatched purple: Communal landscaped areas held in common by 2, 4 & 6 Hillend Road.
- Bins A, B & C and benches D & E are included within the landscaped areas hatched purple.
- Area coloured orange: Plant enclosure held in common by 2, 4 & 6 Hillend Road.
- Area coloured yellow: Associated car parking held in common by 2, 4 & 6 Hillend Road.
- Areas coloured pink: Service strip areas to be retained by Fife Council.
- Area coloured green: Footpaths adjacent to development adopted/to be adopted by Fife Council.
- Retaining walls marked X, Y & Z are held in common by 2, 4 & 6 Hillend Road.

Name	Arran Swanson	Dwg No W19IK005 B	Department Property Services - Estates	
Scale	1:250 @ A3			
Deed Plan Retail Unit, 4 Hillend Road Inverkeithing				
		Rev No 01		
		Date 27/05/2019	<small>This map is based upon Ordnance Survey material with the permission of Ordnance Survey on behalf of the Controller of Her Majesty's Stationery Office (c) Crown copyright. Unauthorised reproduction infringes Crown copyright and may lead to prosecution or civil proceedings. Fife Council 100023385 (2016)</small>	

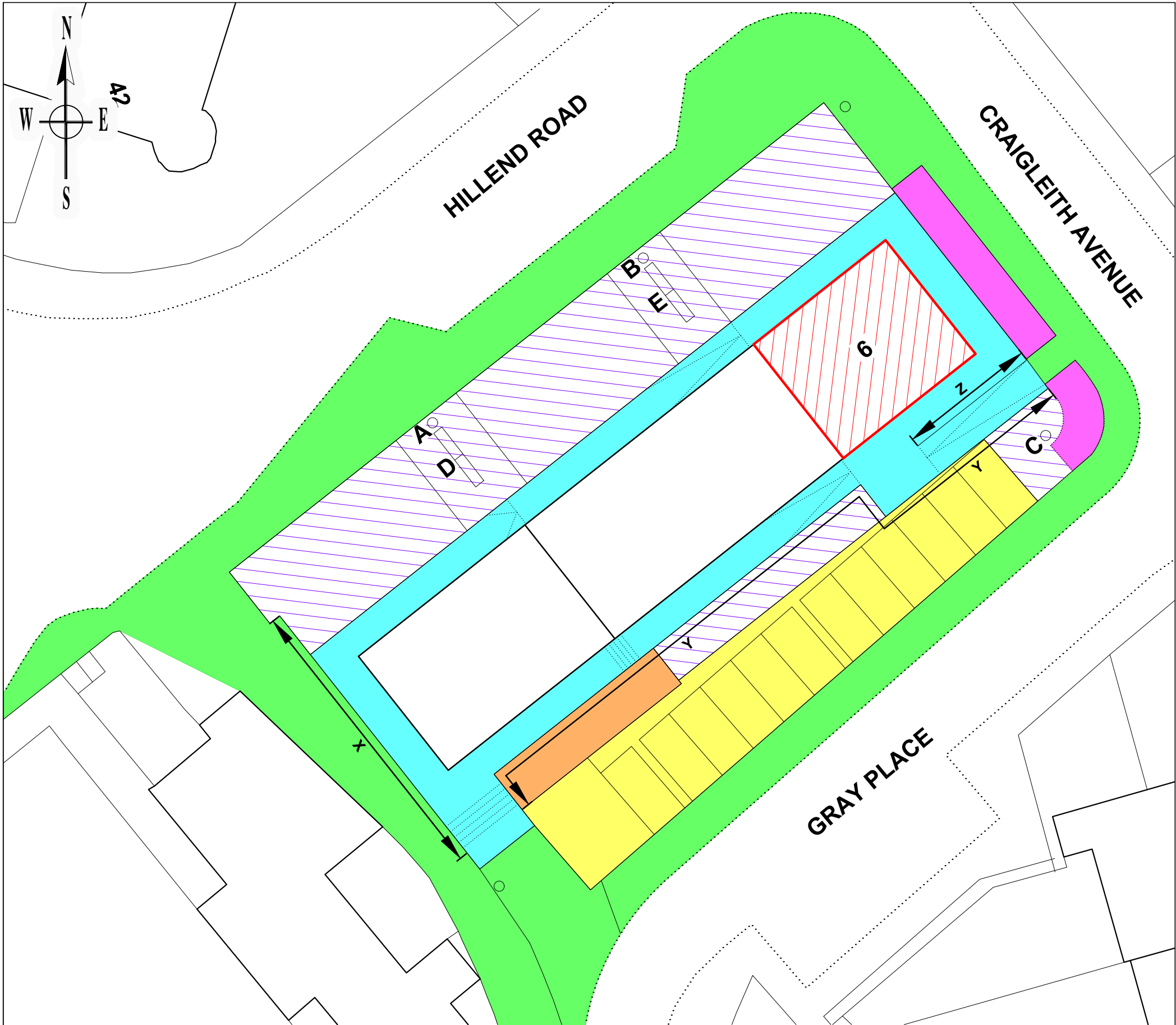

## Inverkeithing



Location Plan Scale 1:2,500

- Area hatched red extends to 85m<sup>2</sup> or thereby.
- Area coloured light blue: Communal footpath areas held in common by 2, 4 & 6 Hillend Road.
- Areas hatched purple: Communal landscaped areas held in common by 2, 4 & 6 Hillend Road.
- Bins A, B & C and benches D & E are included within the landscaped areas hatched purple.
- Area coloured orange: Plant enclosure held in common by 2, 4 & 6 Hillend Road.
- Area coloured yellow: Associated car parking held in common by 2, 4 & 6 Hillend Road.
- Areas coloured pink: Service strip areas to be retained by Fife Council.
- Area coloured green: Footpaths adjacent to development adopted/to be adopted by Fife Council.
- Retaining walls marked X, Y & Z are held in common by 2, 4 & 6 Hillend Road.

Name Arran Swanson

Scale 1:250 @ A3

Deed Plan

Retail Unit, 6 Hillend Road

Inverkeithing

Dwg No W19IK005 A

Rev No 01

Date 27/05/2019

Department

Property Services - Estates



This map is based upon Ordnance Survey material with the permission of Ordnance Survey on behalf of the Controller of Her Majesty's Stationery Office (c) Crown copyright. Unauthorised reproduction infringes Crown copyright and may lead to prosecution or civil proceedings. Fife Council 100023385 (2016)