

- Water Tank Room
- Gas
- Plant Room
- B1 Bin Store 1
- B2 Bin Store 2
- B3 Bin Store 3
- Carpark undercroft
- Pend
- Parking
- Landlord's storage Close F
- Close A Flats
- Close A
- Close B Flats
- Close B
- Close C Flats
- Close C
- Close D Flats
- Close D
- Close E Flats
- Close E
- Close E Existing
- Link access 3rd Floor
- Link access Ground Floor
- Close F
- Close F Close
- Raised Deck Walkway

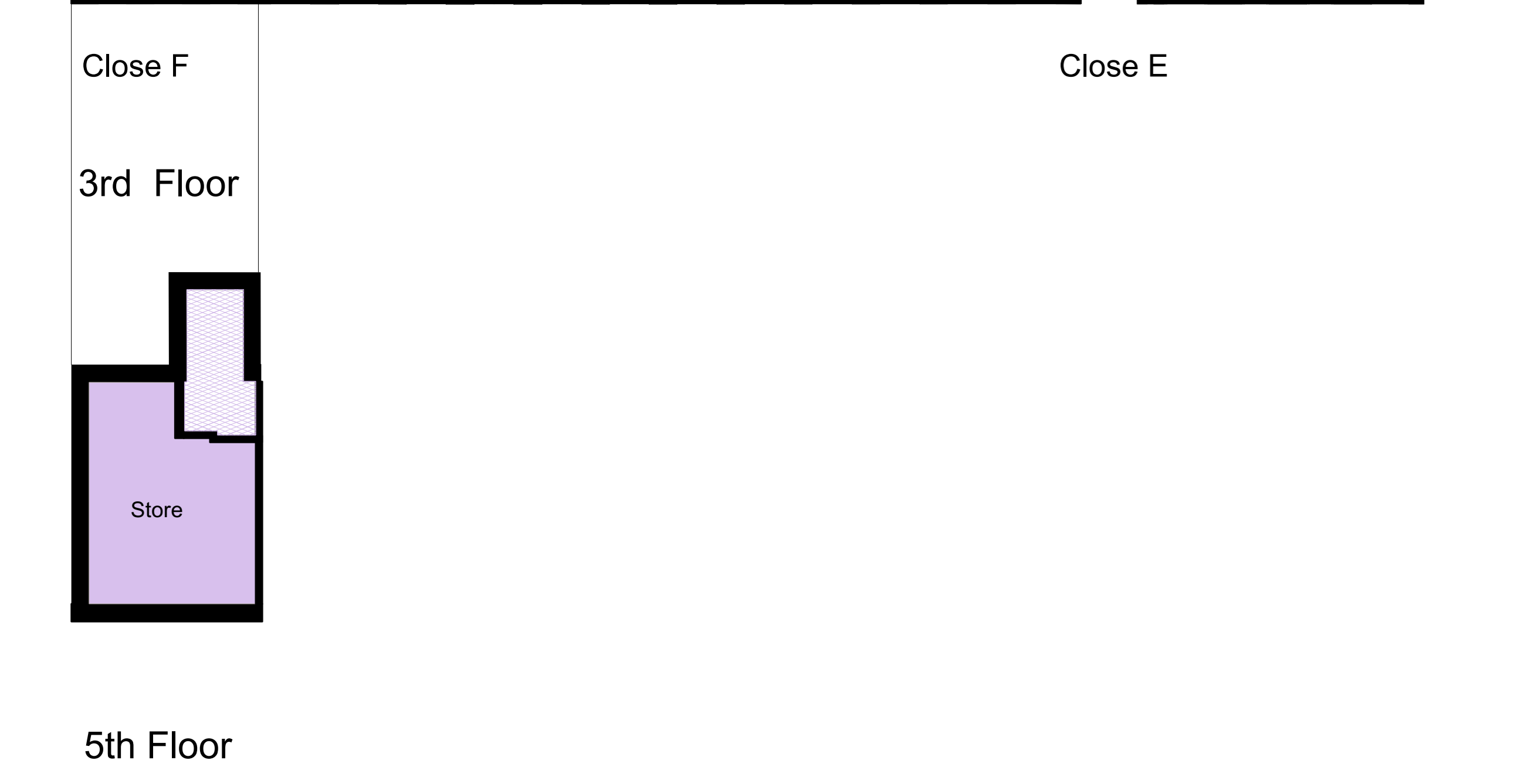

The development registered under title GLA221722 and plots 1 to 60 within have been DPA approved by:

D Mac Donald - 22nd December 2021

David MacDonald (DPA Officer)

No.	Date	By	Revision Notes
B	Jan 2022	CM	Pend zone identified
A	April 2020	CM	Car parking numbers and bin store identification notes added

<p>NOTES</p> <p>DO NOT SCALE FROM DRAWING</p> <p>ALL DIMENSIONS TO BE CHECKED ON SITE PRIOR TO THE START OF ANY WORK AND ANY DISCREPANCIES NOTIFIED IN WRITING.</p> <p>REFER TO ENGINEER'S DRAWINGS FOR ALL STRUCTURAL, HEATING, LIGHTING, POWER, EXTERNAL, AND UNDERGROUND DRAINAGE AND VENTILATION INFORMATION.</p> <p>ALL BUILDING WORKS TO COMPLY IN ALL RESPECTS TO CURRENT BUILDING STANDARDS FOR COUNTRY IN WHICH SITE IS LOCATED.</p>	<p>KEY</p>	<p>CLIENT:</p> <p>Partia Housing Association</p> <p>PROJECT:</p> <p>St Peter's, School</p> <p>DRAWING:</p> <p>Deed of Condition Plans</p> <p>DATE:</p> <p>09/09/19</p> <p>JV:</p> <p>CM</p> <p>SCALE:</p> <p>1:500</p> <p>WEEK:</p> <p>1408</p> <p>CHKD:</p> <p>SKA</p>	<p>SCALE BAR</p>	<p>REPRODUCED FROM THE 1956 ORDNANCE SURVEY 1:1250 MAP WITH THE PERMISSION OF THE CONTROLLER OF HER MAJESTY'S STATIONERY OFFICE. Crown Copyright.</p> <p>Sheet reference: m55666w Product Spec: LSPS_1.1</p> <p>Translated by: cff2staf First distributed: 23/05/94 Copyright Date: 1995 Last full rev date: N/A</p> <p>Translation date: 21/02/95 Content indicator: A Contour interval: N/A Boundary date: 01/1990</p> <p>Translator version: 1.0 House unit count: 93 Map spec number: N/A Orig survey date(s): N/A</p> <p>Storage scale: 1:1250 Dig update count: N/A Edge match status: N/E S/W Low water date(s): N/A</p> <p>Databank supply: 200/195 Dig update date: 23/01/95 Check values: 0NE3RUZU High water date(s): N/A</p> <p>OSM marker: N/A</p>