

The development registered under title ARG13484 and plots 1 to 5, 7, 9 and 11 within have been DPA approved by:

*D MacDonald - 8 Aug 2019*

David MacDonald (DPA Officer)



KEY

- outline of title
- septic tank
- open spaces landscaped areas
- surface water drainage system and outfall
- roadway right of access
- service strip
- access area
- track access area

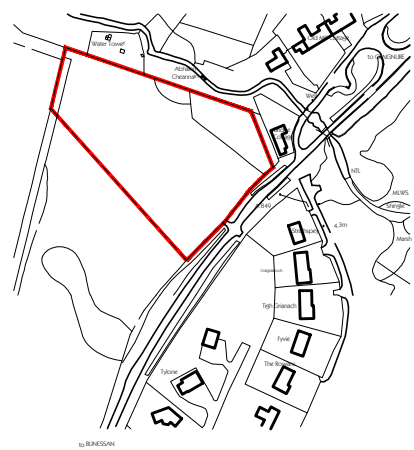

LOCATION PLAN 1:5000

**Beaton + McMurphy**  
 architects  
 tigh na glaic, taynuilt, argyll. pa35 1jw  
 tel - 01866 892350 fax - 01866 892320 www.bmarchitects.co.uk

COMMON AREAS & SERVITUDE PLAN  
 AT SWAN DRIVE, LOCHDON, ISLE OF MULL, ARGYLL

SCALE 1:500 @ A3 DATE: JULY 2019

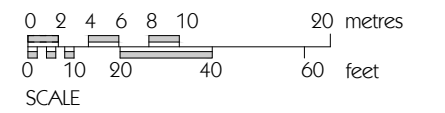
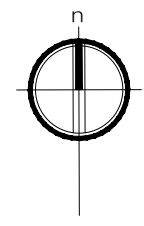

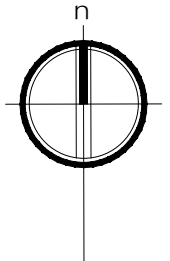
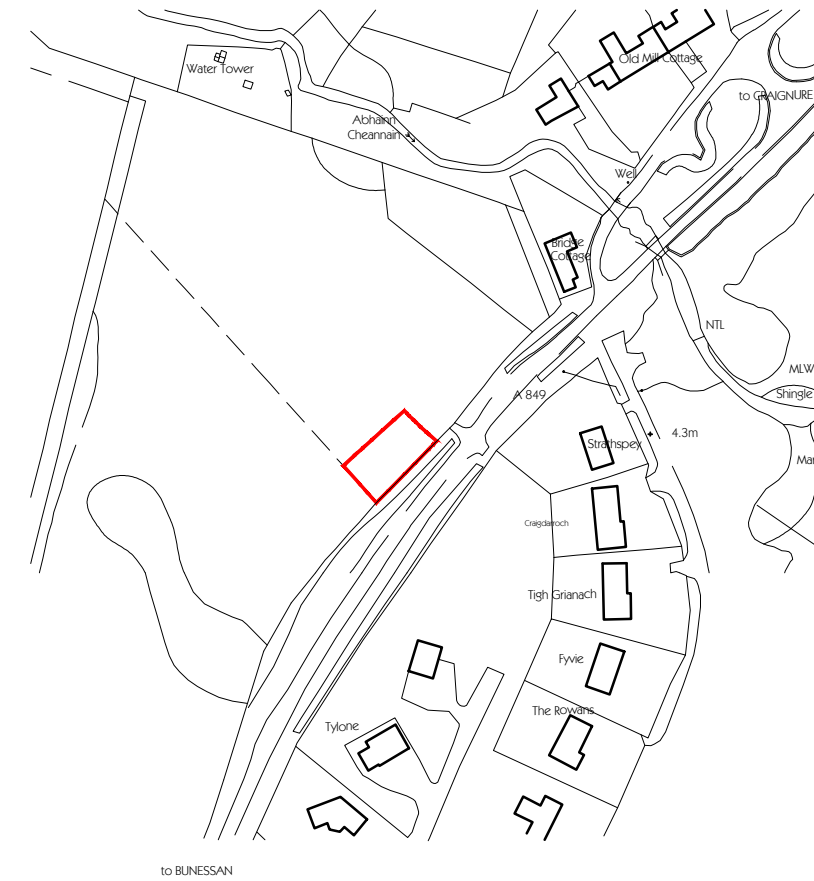

LOCATION PLAN 1:2500

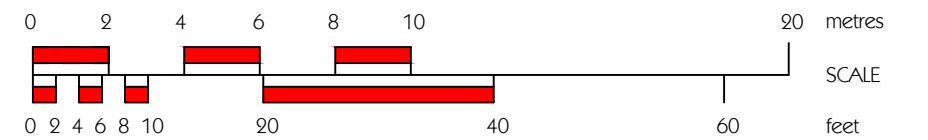

Note: No site survey by this practice undertaken.

**Beaton + McMurchy**  
architects

tigh na glaic, taynuilt, argyll. pa35 1jw  
tel - 01866 892350 fax - 01866 892320 www.bmarchitects.co.uk

SUBJECTS AT 1 SWAN DRIVE, LOCHDON,  
ISLE OF MULL, ARGYLL, PA64 6AP

DATE: JULY 2019

SCALE 1:200

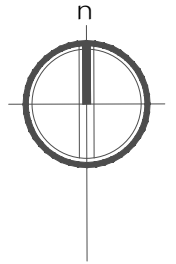
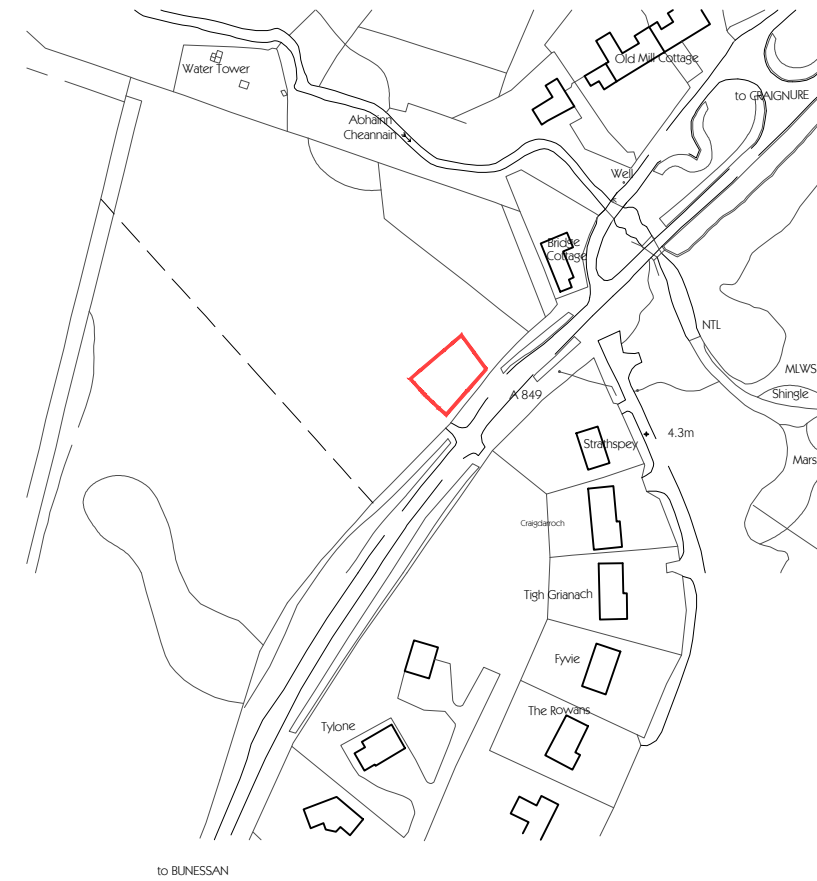
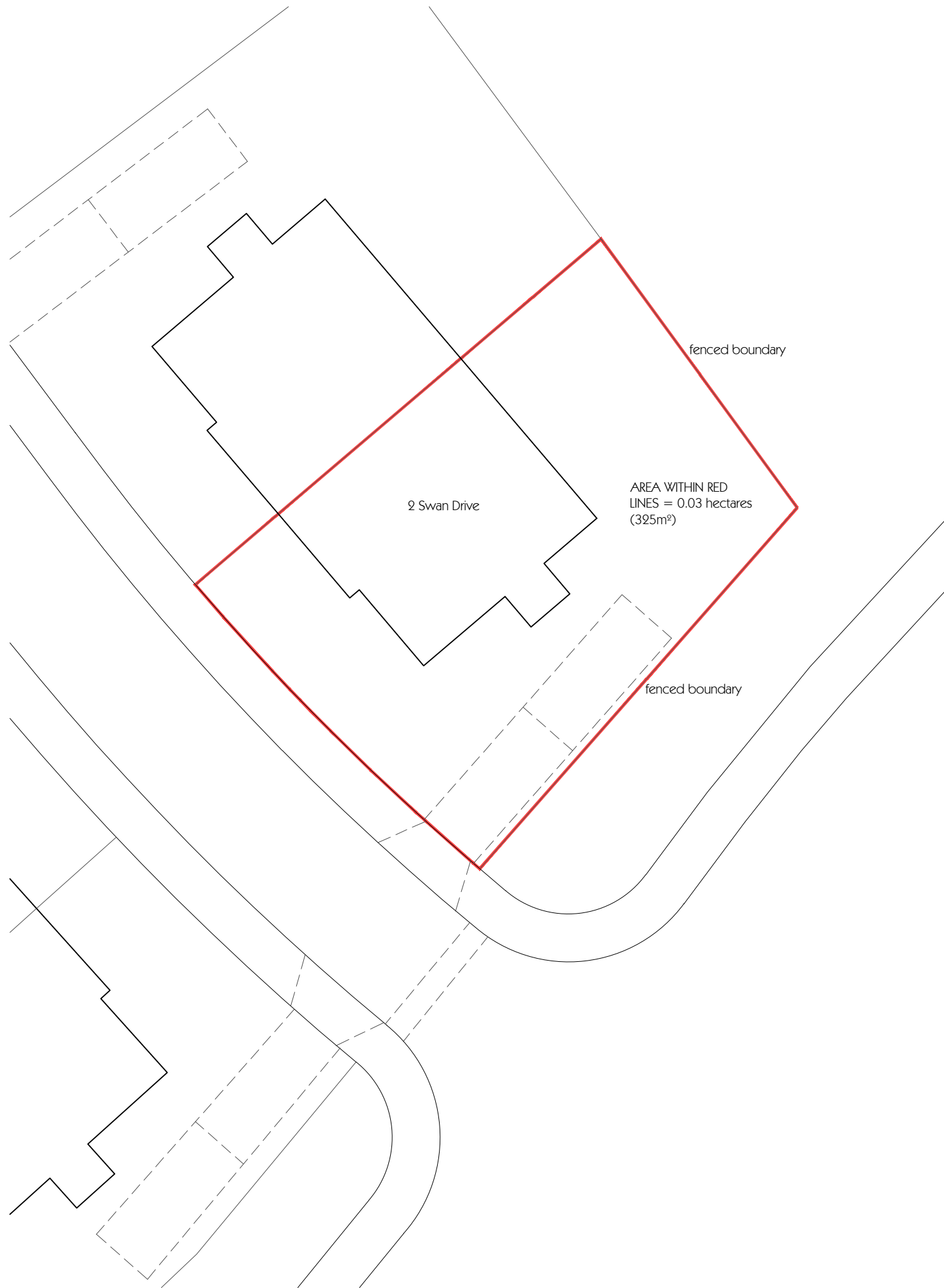

LOCATION PLAN 1:2500

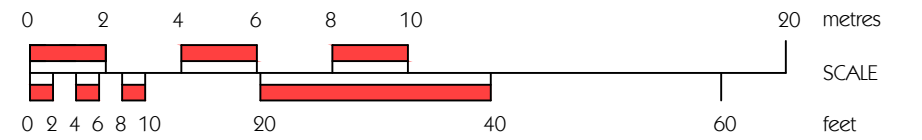

Note: No site survey by this practice undertaken.

**Beaton + McMurchy**  
architects

tigh na glaic, taynuilt, argyll. pa35 1jw  
tel - 01866 892350 fax - 01866 892320 www.bmarchitects.co.uk

SUBJECTS AT 2 SWAN DRIVE, LOCHDON,  
ISLE OF MULL, ARGYLL, PA64 6AP

DATE: FEB 2019

SCALE 1:200

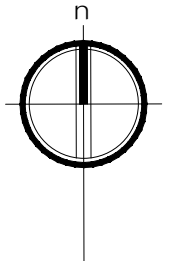
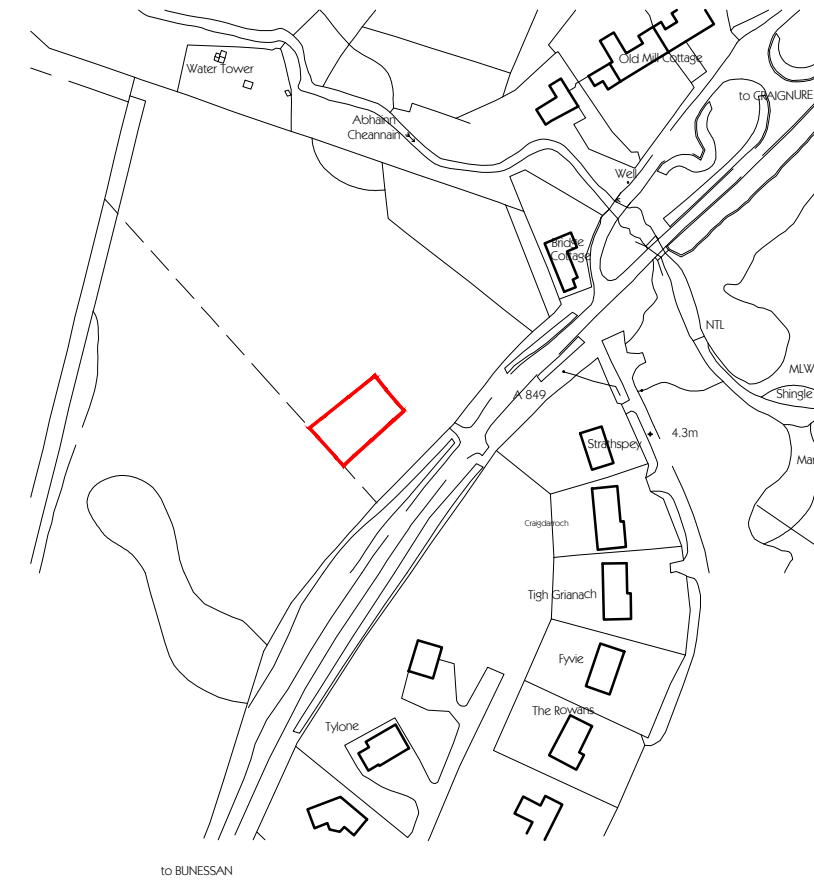

LOCATION PLAN 1:2500

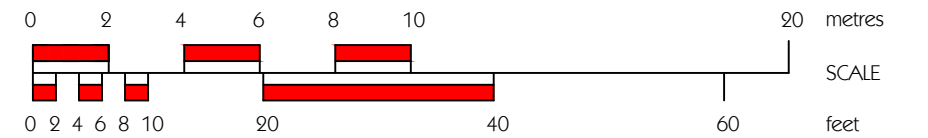

Note: No site survey by this practice undertaken.

**Beaton + McMurchy**  
architects

tigh na glaic, taynuilt, argyll. pa35 1jw  
tel - 01866 892350 fax - 01866 892320 www.bmarchitects.co.uk

SUBJECTS AT 3 SWAN DRIVE, LOCHDON,  
ISLE OF MULL, ARGYLL, PA64 6AP

DATE: JULY 2019

SCALE 1:200

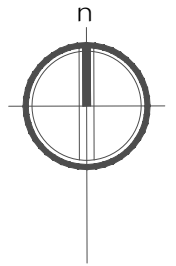
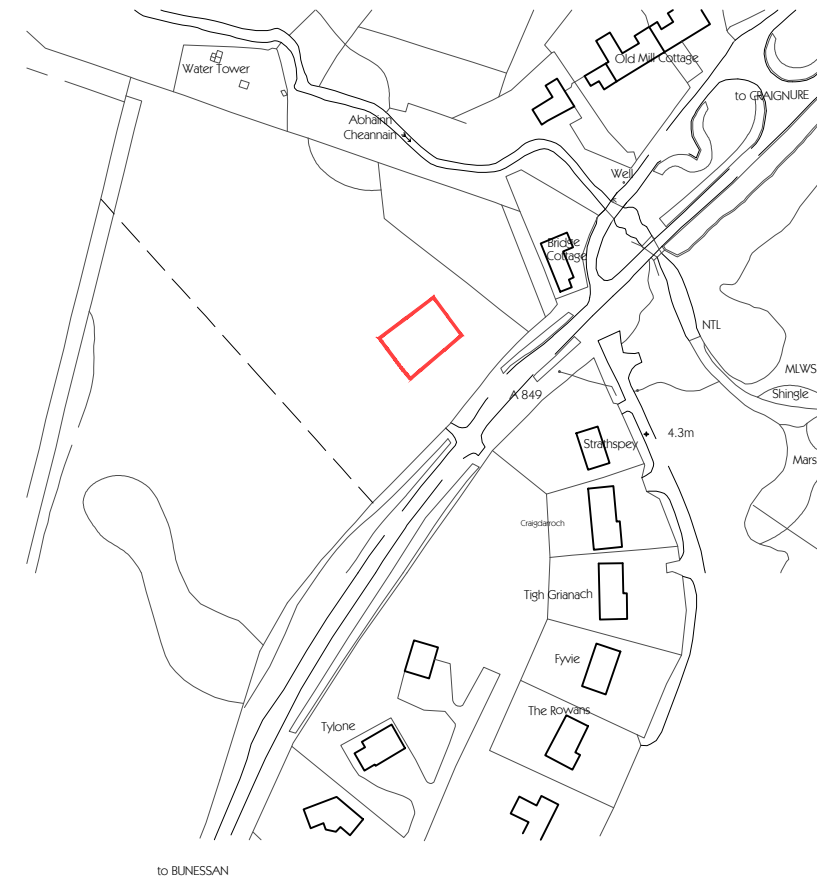

LOCATION PLAN 1:2500

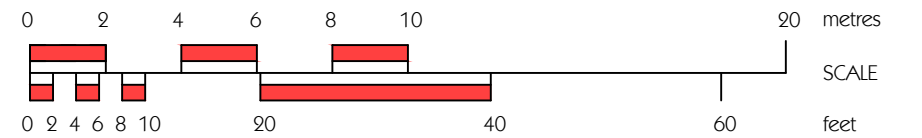

Note: No site survey by this practice undertaken.

**Beaton + McMurchy**  
architects

tigh na glaic, taynuilt, argyll. pa35 1jw  
tel - 01866 892350 fax - 01866 892320 www.bmarchitects.co.uk

SUBJECTS AT 4 SWAN DRIVE, LOCHDON,  
ISLE OF MULL, ARGYLL, PA64 6AP

DATE: FEB 2019

SCALE 1:200

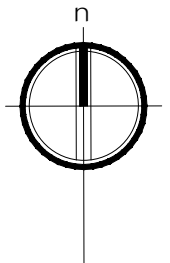
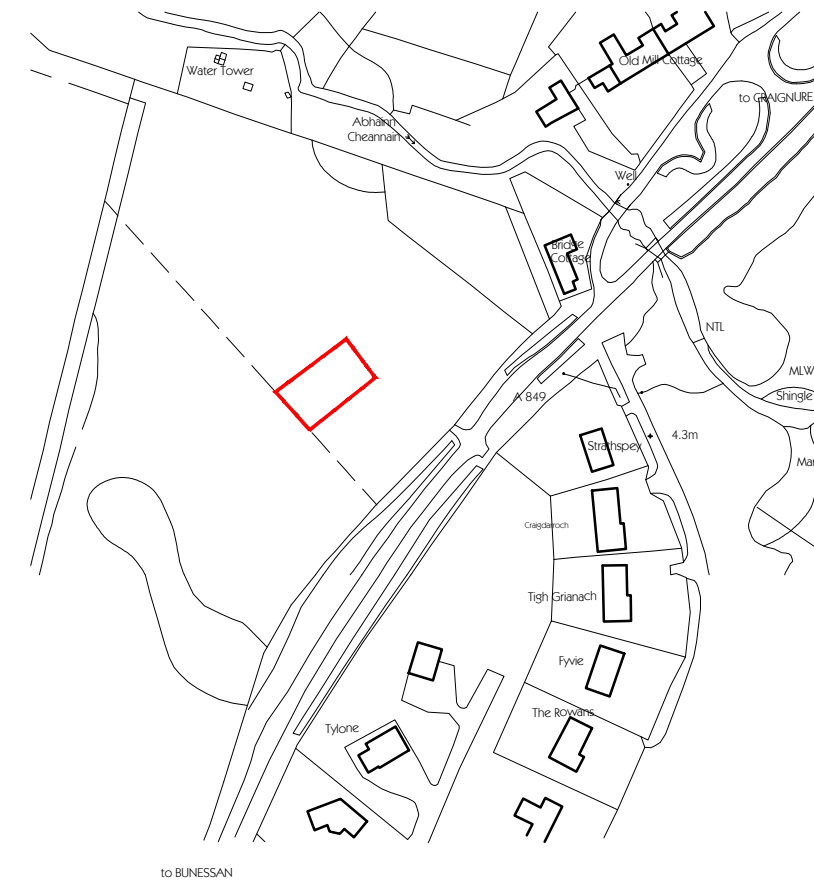

LOCATION PLAN 1:2500

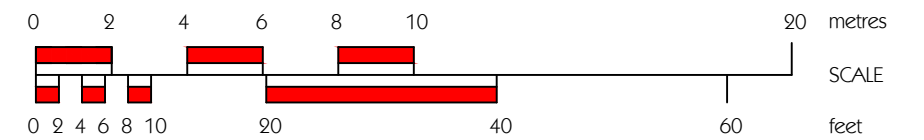

Note: No site survey by this practice undertaken.

**Beaton + McMurchy**  
architects

tigh na glaic, taynuilt, argyll. pa35 1jw  
tel - 01866 892350 fax - 01866 892320 www.bmarchitects.co.uk

SUBJECTS AT 5 SWAN DRIVE, LOCHDON,  
ISLE OF MULL, ARGYLL, PA64 6AP

DATE: JULY 2019

SCALE 1:200

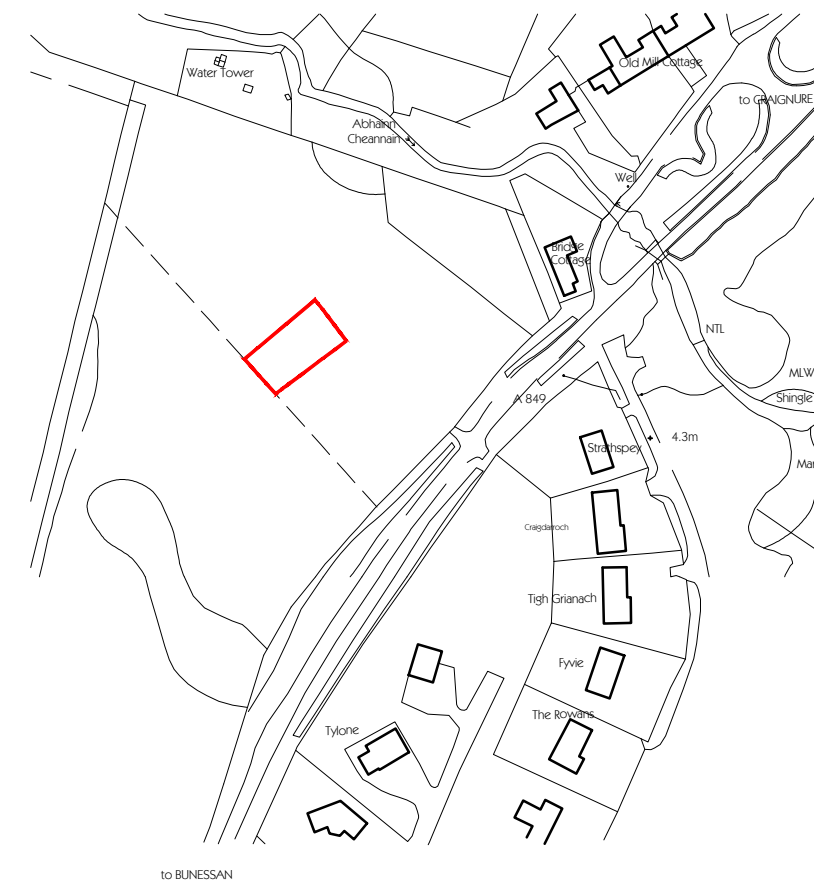

LOCATION PLAN 1:2500

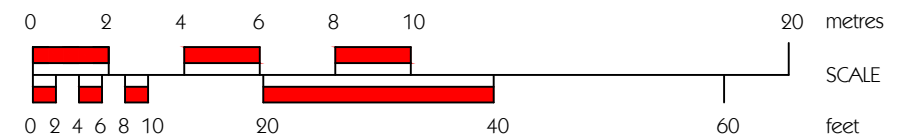

Note: No site survey by this practice undertaken.

**Beaton + McMurchy**  
architects

tigh na glaic, taynuilt, argyll. pa35 1jw  
tel - 01866 892350 fax - 01866 892320 www.bmarchitects.co.uk

SUBJECTS AT 7 SWAN DRIVE, LOCHDON,  
ISLE OF MULL, ARGYLL, PA64 6AP

DATE: JULY 2019

SCALE 1:200

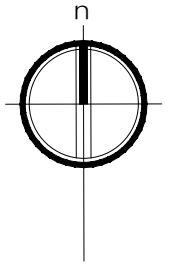
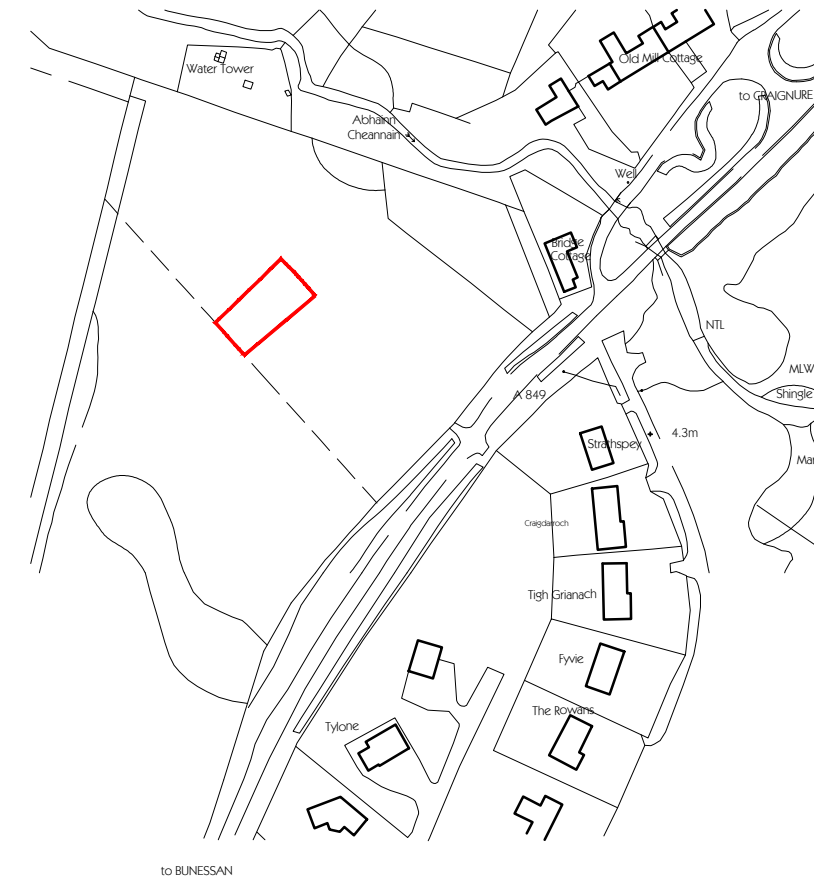

LOCATION PLAN 1:2500

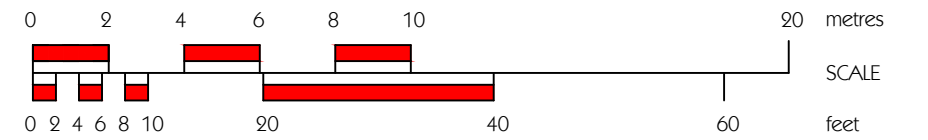

Note: No site survey by this practice undertaken.

**Beaton + McMurchy**  
architects

tigh na glaic, taynuilt, argyll. pa35 1jw  
tel - 01866 892350 fax - 01866 892320 www.bmarchitects.co.uk

SUBJECTS AT 9 SWAN DRIVE, LOCHDON,  
ISLE OF MULL, ARGYLL, PA64 6AP

DATE: JULY 2019

SCALE 1:200



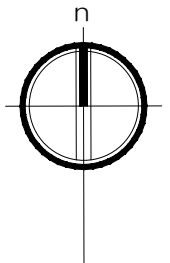
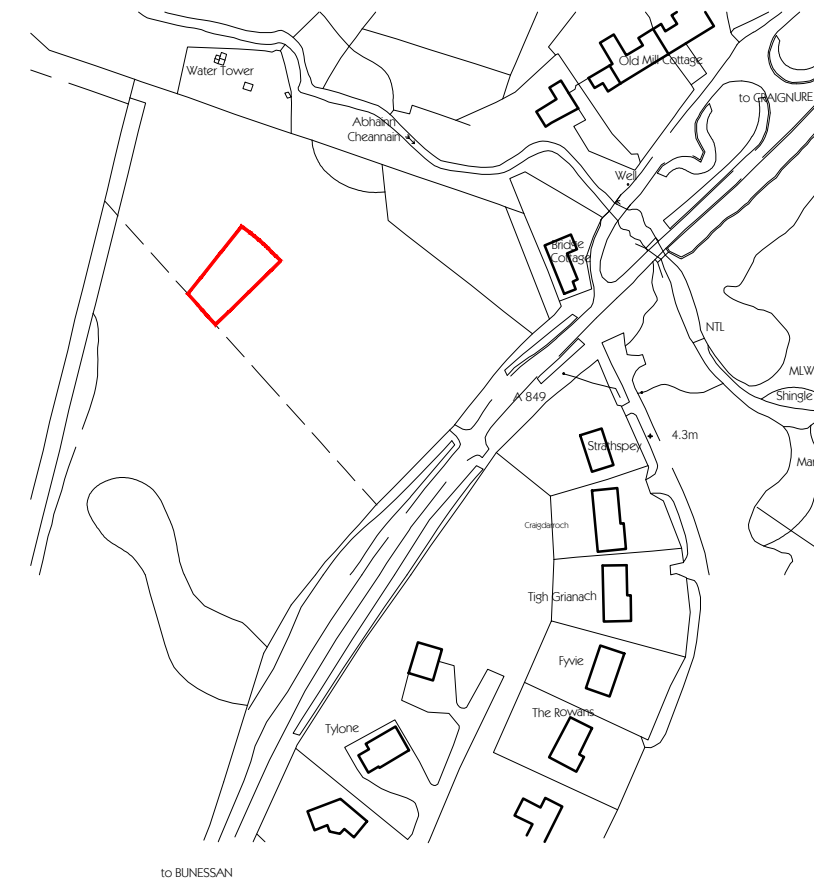

LOCATION PLAN 1:2500

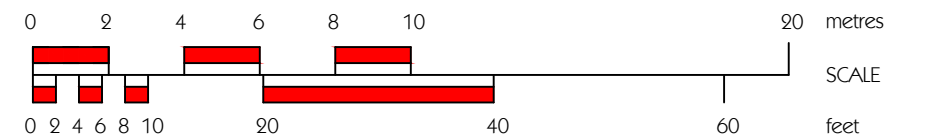

Note: No site survey by this practice undertaken.

**Beaton + McMurchy**  
architects

tigh na glaic, taynuilt, argyll. pa35 1jw  
tel - 01866 892350 fax - 01866 892320 www.bmarchitects.co.uk

SUBJECTS AT 11 SWAN DRIVE, LOCHDON,  
ISLE OF MULL, ARGYLL, PA64 6AP

DATE: JULY 2019

SCALE 1:200