

The development registered under title GLA180649 and plots 1142, 1143, 1145 to 1200, 1203 to 1210 and 1213 to 1218 have been DPA approved by:

*D MacDonald - 03 Oct 2019*

David MacDonald (DPA Officer)

SHADING LEGEND

- HARD AND SOFT LANDSCAPED AREAS MAINTAINED BY THE FACTOR ON BEHALF OF RESIDENTIAL APARTMENTS
- ROADS AND FOOTPATHS AREAS MAINTAINED BY THE FACTOR ON BEHALF OF RESIDENTIAL DWELLINGS AND APARTMENTS
- COMMON STAIR TO BE MAINTAINED BY FACTOR ON BEHALF OF RESPECTIVE RESIDENTIAL DWELLING
- DENOTES BLOCK BOUNDARY LINES.
- DENOTES AREA BOUNDARY LINE.
- DENOTES EXTENT OF AREA V1-4 UNITS
- AREA OF SCOTTISH WATER WAYLEAVE

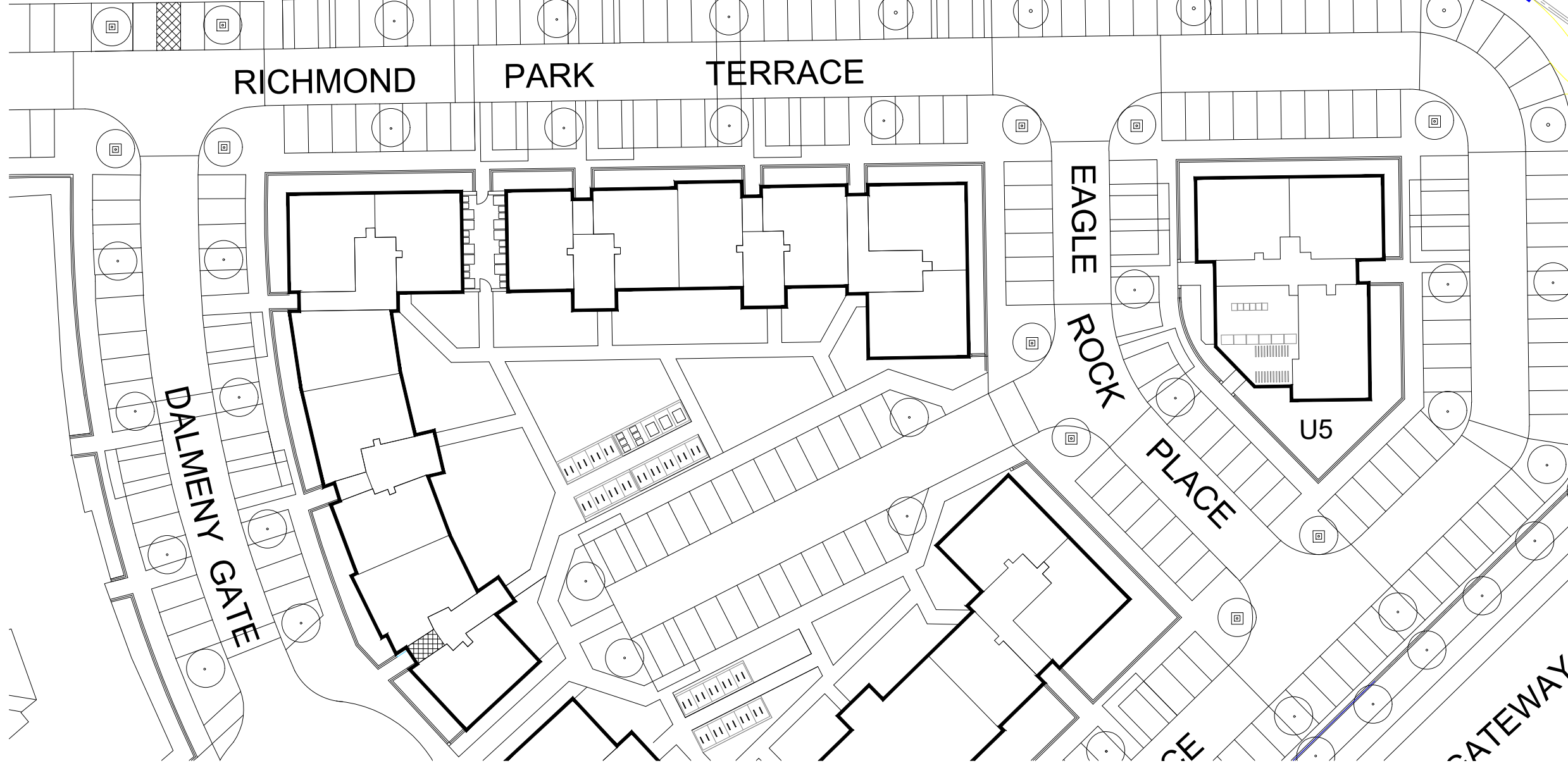
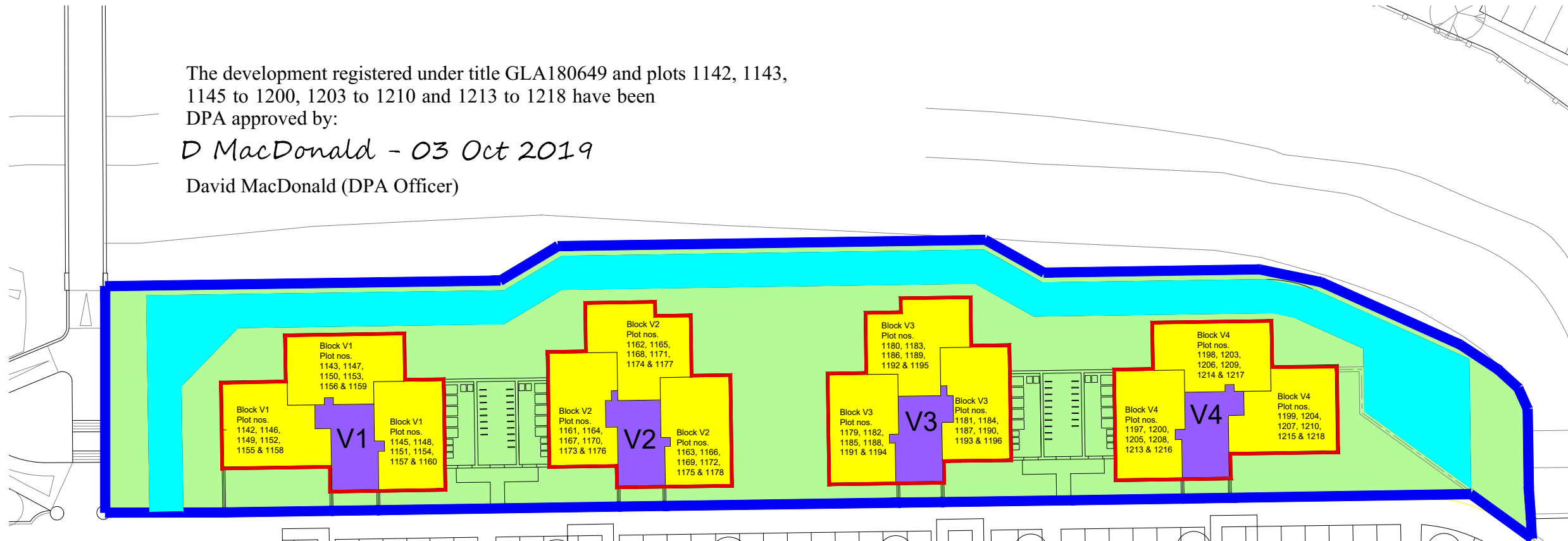

A	06.08.19	LGD	Extent of Scottish Water Wayleave added
REV	DATE	BY	AMENDMENTS
Avant Homes Argyll Court, The Castle Business Park, Stirling, FK9 4TT Tel: 01786 477777 Fax: 01786 477666 www.avanthomes.co.uk			
S:\PROJECT\019915 - Oatlands\02 Architects\10 Architectural Legal Plans\Legal - Factoring Deed Drawing			
DATE:	SCALE:	DRAWN BY:	
19.08.19	1:500@A3	LGD	
DWG TITLE:			
Proposed Residential Development Oatlands Glasgow Area V1-4			
PROJECT:			
Deed of Conditions Site Layout			
DWG No.	OL-DOC-28		Rev.
			A