





LEGEND

- Site Boundary
- Soft landscaping, parking, paths, private lighting and bin/cycle store shared between plots 411-416 & 426-440, maintained by factor with wayleave access as a service strip, sewer wayleave or fibre cable wayleave. (Light Yellow)
- Soft landscaping, paths, private lighting and bin/cycle store shared between plots 417-425, maintained by factor with wayleave access as a service strip, sewer wayleave or fibre cable wayleave. (Light Blue)
- Soft landscaping, parking, paths, private lighting and bin/cycle store shared between plots 456-473, maintained by factor with wayleave access as a service strip, sewer wayleave or fibre cable wayleave. (Light Pink)
- Landscaping, hardstanding & private lighting area shared between plots 02-14 & 19-22, maintained by factor, with wayleave access as a service strip, sewer wayleave or fibre cable wayleave. (Orange)
- Landscaping, hardstanding & private lighting area shared between plots 63-74, maintained by factor, with wayleave access as a service strip, sewer wayleave or fibre cable wayleave. (Yellow)
- Landscaping, hardstanding & private lighting area shared between plots 94-100 & 102-111, maintained by factor, with wayleave access as a service strip, sewer wayleave or fibre cable wayleave. (Green)
- Private hardstanding area shared between plots 71-74, maintained by factor, with wayleave access as a service strip, sewer wayleave or fibre cable wayleave. (Blue)
- Private hardstanding area shared between plots 125-128, maintained by factor, with wayleave access as a service strip, sewer wayleave or fibre cable wayleave. (Purple)
- Private hardstanding area shared between plots 142-145, maintained by factor, with wayleave access as a service strip, sewer wayleave or fibre cable wayleave. (Pink)
- Soft landscaping, parking, paths, and private lighting shared between plots 112-117, 147-150, & 417-424, maintained by factor with wayleave access as a service strip, sewer wayleave or fibre cable wayleave. (Red)
- Private hardstanding area shared between plots 102-109, maintained by factor, with wayleave access as a service strip, sewer wayleave or fibre cable wayleave. (Red Hatch)
- Private hardstanding area shared between plots 151-158, maintained by factor, with wayleave access as a service strip, sewer wayleave or fibre cable wayleave. (Orange Hatch)
- Private hardstanding area shared between plots 157-158, maintained by factor, with wayleave access as a service strip, sewer wayleave or fibre cable wayleave. (Yellow Hatch)
- Private hardstanding area shared between plots 159-161, maintained by factor, with wayleave access as a service strip, sewer wayleave or fibre cable wayleave. (Green Hatch)
- Private hardstanding area shared between plots 162a-168, maintained by factor, with wayleave access as a service strip, sewer wayleave or fibre cable wayleave. (Blue Hatch)
- Private hardstanding area shared between plots 165-168, maintained by factor, with wayleave access as a service strip, sewer wayleave or fibre cable wayleave. (Purple Hatch)
- Private hardstanding area shared between plots 214-220, maintained by factor, with wayleave access as a service strip, sewer wayleave or fibre cable wayleave. (Pink Hatch)
- Private hardstanding area shared between plots 243-245, maintained by factor, with wayleave access as a service strip, sewer wayleave or fibre cable wayleave. (Orange Cross Hatch)
- Private hardstanding area shared between plots 254-257, maintained by factor, with wayleave access as a service strip, sewer wayleave or fibre cable wayleave. (Yellow Cross Hatch)
- Private hardstanding area shared between plots 265-268, maintained by factor, with wayleave access as a service strip, sewer wayleave or fibre cable wayleave. (Green Cross Hatch)
- Private hardstanding area shared between plots 289-292, maintained by factor, with wayleave access as a service strip, sewer wayleave or fibre cable wayleave. (Blue Cross Hatch)
- Private hardstanding area shared between plots 293-296, maintained by factor, with wayleave access as a service strip, sewer wayleave or fibre cable wayleave. (Purple Cross Hatch)
- Private hardstanding area shared between plots 301-304, maintained by factor, with wayleave access as a service strip, sewer wayleave or fibre cable wayleave. (Pink Cross Hatch)
- Private hardstanding area shared between plots 310-314, maintained by factor, with wayleave access as a service strip, sewer wayleave or fibre cable wayleave. (Red Cross Hatch)
- Private hardstanding area shared between plots 322-329 maintained by factor, with wayleave access as a service strip, sewer wayleave or fibre cable wayleave. (Orange Comb Hatch)
- Private hardstanding area shared between plots 356-359, maintained by factor, with wayleave access as a service strip, sewer wayleave or fibre cable wayleave. (Yellow Comb Hatch)
- Private hardstanding area shared between plots 366-368, maintained by factor, with wayleave access as a service strip, sewer wayleave or fibre cable wayleave. (Green Comb Hatch)
- Private hardstanding area shared between plots 372-374, maintained by factor, with wayleave access as a service strip, sewer wayleave or fibre cable wayleave. (Blue Comb Hatch)
- Private hardstanding area shared between plots 377-381, maintained by factor, with wayleave access as a service strip, sewer wayleave or fibre cable wayleave. (Purple Comb Hatch)
- Private hardstanding area shared between plots 384-386, maintained by factor, with wayleave access as a service strip, sewer wayleave or fibre cable wayleave. (Pink Comb Hatch)
- Private hardstanding area shared between plots 392-395, maintained by factor, with wayleave access as a service strip, sewer wayleave or fibre cable wayleave. (Red Comb Hatch)
- Private hardstanding area shared between plots 399-402, maintained by factor, with wayleave access as a service strip, sewer wayleave or fibre cable wayleave. (Orange ZigZag Hatch)
- Private hardstanding area shared between plots 403-404, maintained by factor, with wayleave access as a service strip, sewer wayleave or fibre cable wayleave. (Yellow ZigZag Hatch)
- Private hardstanding area shared between plots 405-407, maintained by factor, with wayleave access as a service strip, sewer wayleave or fibre cable wayleave. (Green ZigZag Hatch)
- SUD's basin to be maintained by the factor and adopted by Scottish Water. (Dark Green)
- Substations and associated parking to be adopted and maintained by the utility provider. (Brown)
- PRI Station and associated hardstanding/landscaping to be adopted by GTC and maintained by factor. (Violet)
- Pumping Station and associated hardstanding to be adopted and maintained by Scottish Water. (Teal)
- Fibrenest Distribution Cabinet to be maintained by Fibrenest. (Dark Blue)
- Roadways, footpaths and parking adopted and maintained by East Lothian Council Roads Department with wayleave access as a service strip, sewer wayleave or fibre cable wayleave. (Grey)
- Grass service strip adopted by East Lothian Council Roads Department and maintained by factor with wayleave access as a service strip, sewer wayleave or fibre cable wayleave. (Yellow)

- Private hedging to be maintained by factor. (Dark Green Circles)
- Hardstanding area shared between plots 334-345 maintained by factor. (Green Squared Hatch)
- Soft landscaping area shared between plots 338-341 maintained by factor. (Purple Squared Hatch)
- Hardstanding area shared between plots 330-333 maintained by factor. (Pink Squared Hatch)
- Hardstanding, Soft Landscaping area shared between plots 346-353 maintained by factor. (Pink Squared Hatch)
- Hardstanding area shared between plots 346-353 & 441-455 maintained by factor. (Yellow Squared Hatch)
- Hardstanding, Soft landscaping, paths, private lighting shared between plots 441-455 maintained by factor. (Orange Squared Hatch)
- Bin/cycle store & Common Stairwell shared between plots 441-455, maintained by factor. (Turquoise)
- Adopted plot footpath by East Lothian Council Roads Department and maintained by plot with wayleave access as a service strip, sewer wayleave or fibre cable wayleave. (Bright Orange)
- Public open space, pathways and landscaping maintained by factor with wayleave access as a service strip, sewer wayleave or fibre cable wayleave. (Pale Green)

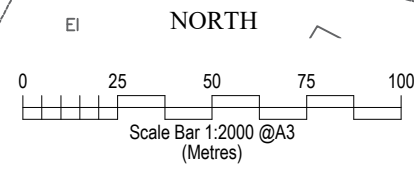
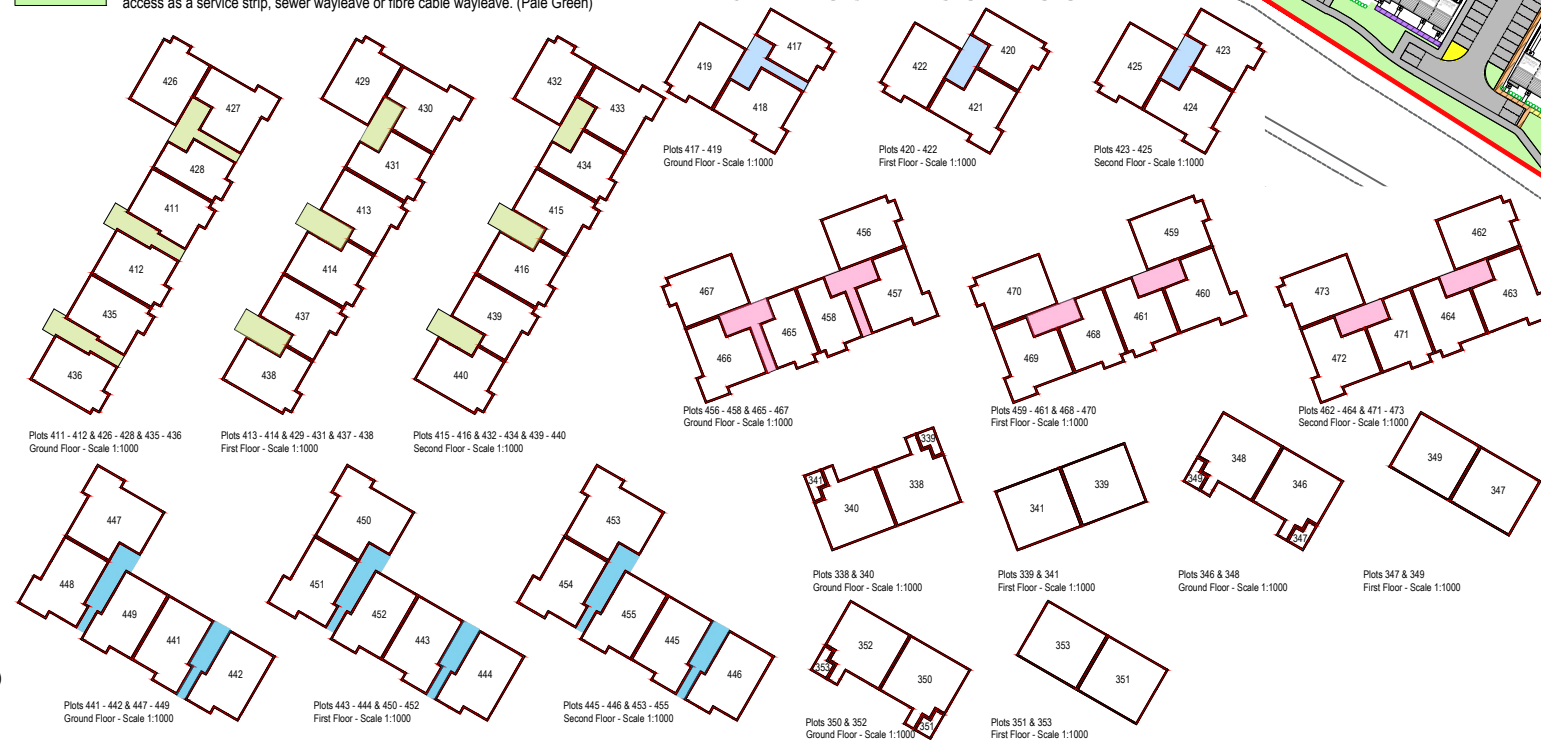

## Persimmon Homes

Persimmon Homes East Scotland  
Unit 1  
Wester Inch Business Park  
Old Well Court  
Bathgate  
West Lothian  
EH48 2TQ



3rd March 2021

Newcraighall - DMS - Rev A