

The Development registered under title GLA227455 and plots 1 to 72, 81 to 94 and 103 to 155 within have been DPA approved by:  
*Craig McFadden - 6 March 2018*  
 Craig McFadden (DPA Officer)

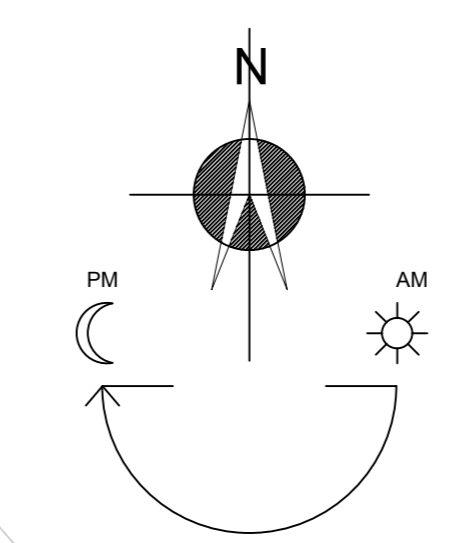

**EXTERNAL FINISHES**  
 Stonework: Forticrete Anstone split brown old weathered  
 Basecourse: Forticrete Anstone split brown old weathered  
 Render Panels: White Dolomite Chip on White Background  
 Roof Tile: Russell Highland - Slate Grey  
 Door Colour: White  
 Precast Colour: Buff  
 Rainwater Goods: Black  
 Fascias / Soffit: White (P.V.C.U.)  
 TOTAL NUMBER - 72 (Private)

**EXTERNAL FINISHES**  
 Stonework: Forticrete Anstone split brown old weathered  
 Basecourse: Forticrete Anstone split brown old weathered  
 Render Panels: Ashton Cream Chip on White Background  
 Roof Tile: Russell Highland Cottage Red  
 Door Colour: White  
 Precast Colour: Buff  
 Rainwater Goods: Black  
 Fascias / Soffit: White (P.V.C.U.)  
 TOTAL NUMBER - 67 (Private)

- LEGEND**
- DEVELOPMENT BOUNDARY
  - HA BOUNDARY
  - FEU BOUNDARY
  - PUBLIC OPEN SPACE
  - SERVICE STRIP
  - SUDS POND
  - ADOPTED ROADS (ASPHALT / BLOCK PAVING)
  - ADOPTED FOOTPATHS
  - SHARED DRIVEWAY COMMON TO PLOTS:- 06, 07, 08
  - SHARED DRIVEWAY COMMON TO PLOTS:- 42, 43, 44
  - SHARED DRIVEWAY COMMON TO PLOTS:- 119, 120
  - SHARED COURTYARD COMMON TO PLOTS:- 141, 142, 143, 144, 145, 146, 147, 148, 149, 150
  - SUB-STATION

**AMENDMENTS**

Issue	Date	Detail
A	Aug '17	Updated to suit comments from Shoosmiths. Roadway extended to development boundary. Sub-Station hatch added. Phase 1 & 2 boundaries removed.

**Bellway**  
 Hamilton Business Park  
 Caird Street  
 Hamilton ML3 0QA  
 Telephone 01698 477440  
 Fax 01698 477441  
 www.bellway.co.uk

Project  
**JOHNSTONE ROAD GARTCOSH**

Drawing  
**DEVELOPMENT PLAN APPROVAL**

(D.P.A)

Scale Drawn By Checked  
 1:500@A0 LM

Date Drawing No  
 JULY '17 GH / DPA / 01 A

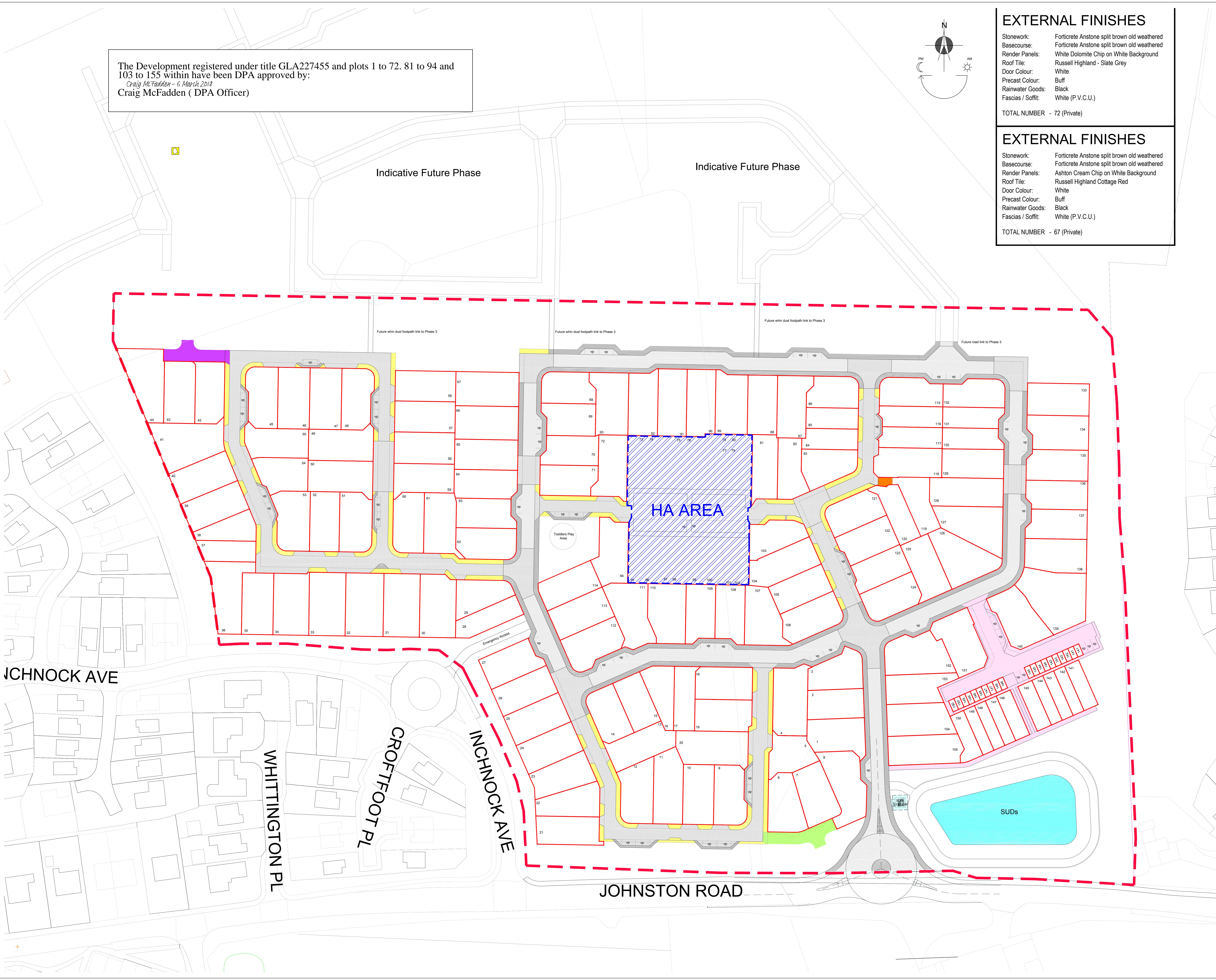

INCHNOCK AVE

WHITTINGTON PL

CROFTFOOT PL

INCHNOCK AVE

JOHNSTON ROAD

SUDs

HA AREA