

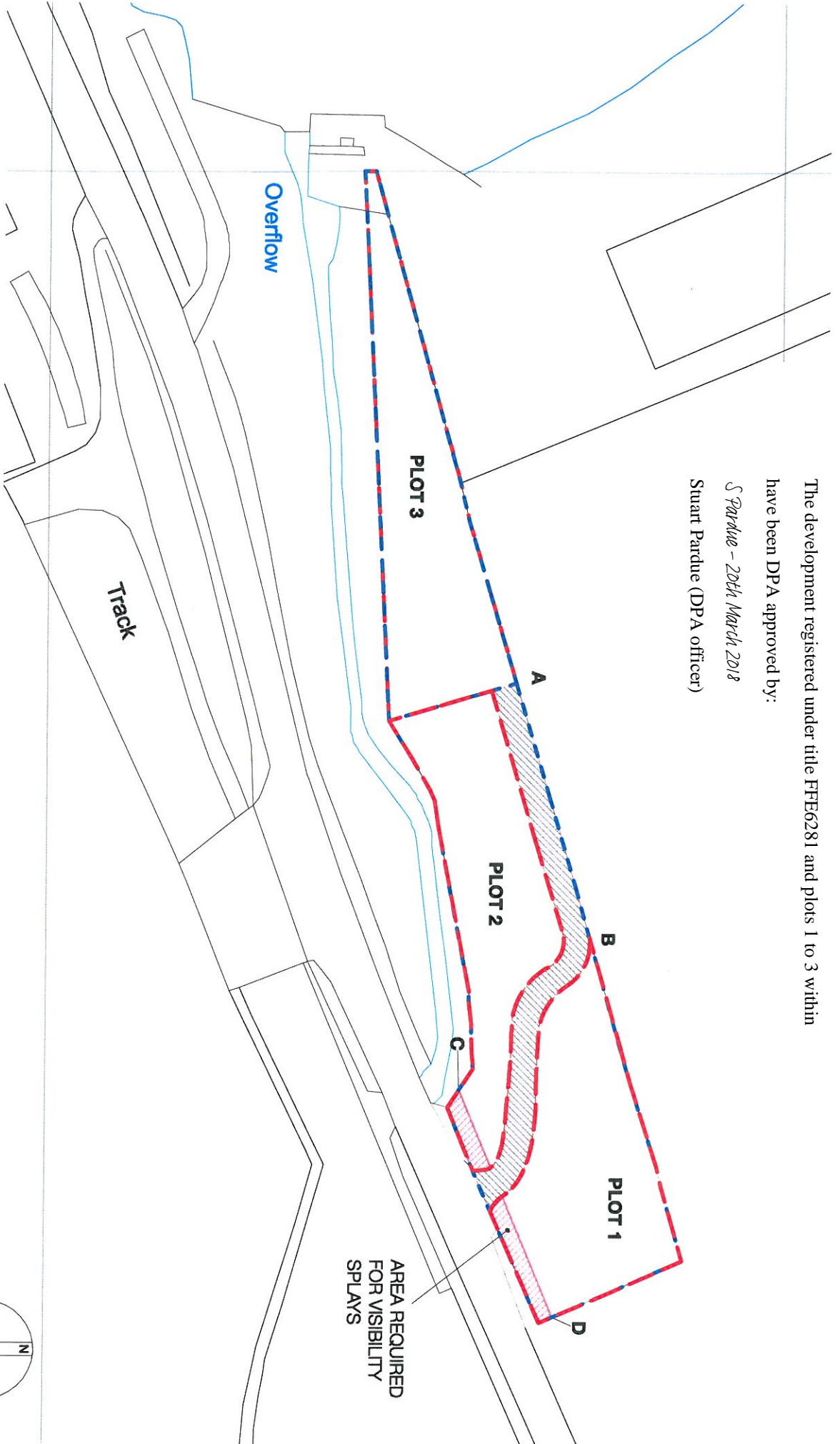





The development registered under title FFE6281 and plots 1 to 3 within
 have been DPA approved by:

S Pardue - 20th March 2018
 Stuart Pardue (DPA officer)



AREA SCHEDULE

-  PLOT 1 AREA 699.5 sqm
-  PLOT 2 AREA 651.8 sqm
-  PLOT 3 AREA 704.9 sqm
-  SITE AREA 2330.9 sqm
-  SHARED ACCESS 274.9 sqm

Client: PAUL DOW JOINERY
 Job: LOCHSIDE STABLES, KINGHORN LOCH KY3 9YG
 Description: DEVELOPMENT PLAN 1:500 @ A3
 Date: JAN 2018
 Drawing Number: 777_(DP)_04
 Status: B

signal architects
 info@signalarchitects.com
 01382 659044
 www.signalarchitects.com

Do not scale from the drawing, confirm all dimensions on site and to your own. This drawing is the copyright of Signal Architects and may not be reproduced or used in any way without the prior written consent of Signal Architects. Any discrepancy between what is shown and what is to be installed is to be resolved in favour of the installed item.