

The development registered under titles PTH39939 and PTH57310 and plots 31 to 43 within have been DPA approved by:

D MacDonald - 04/02/2022

David MacDonald
(DPA Officer)

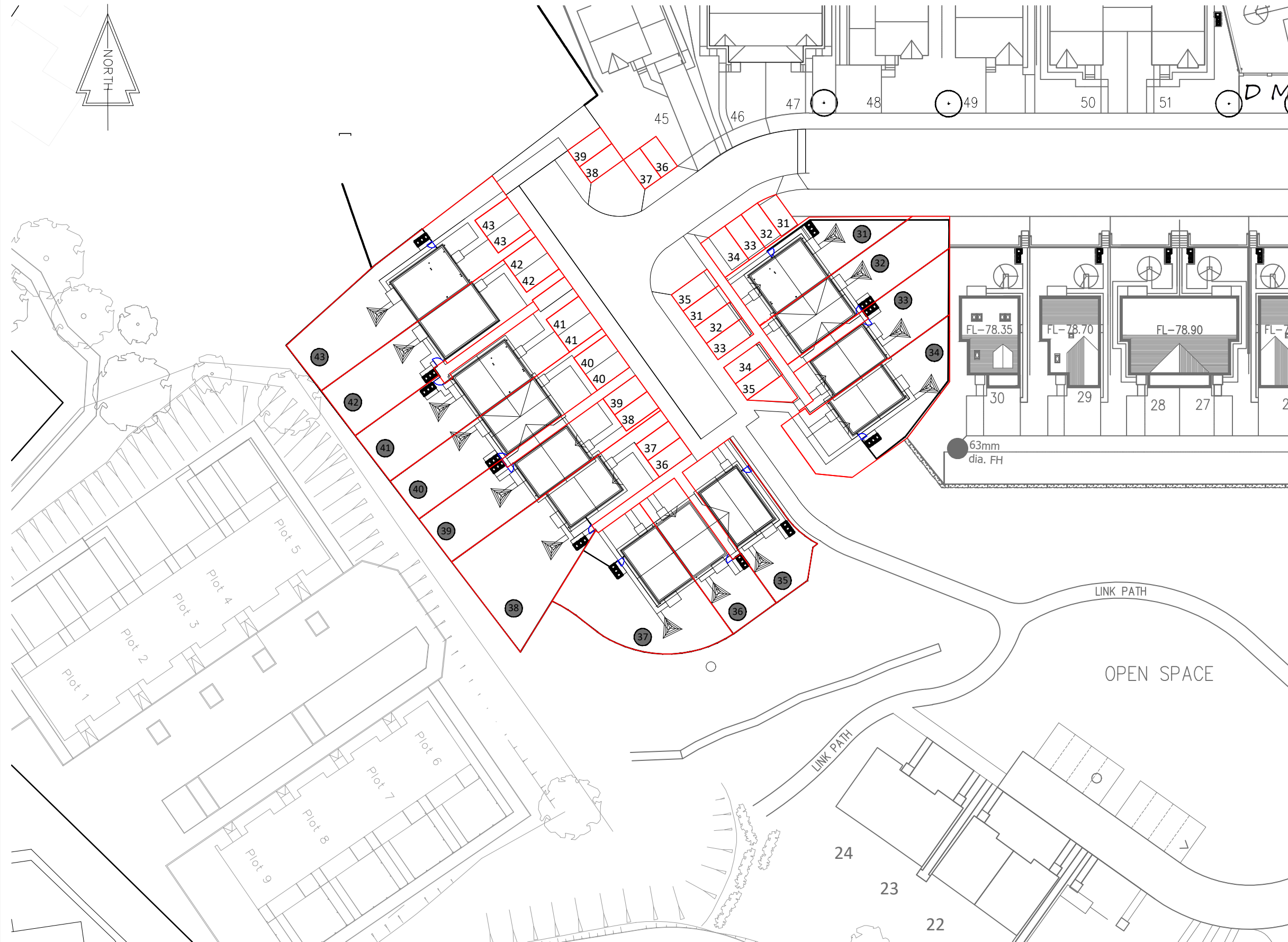
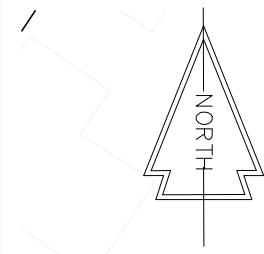

Crown Copyright All rights reserved
Licence number ES100008083

C	Jan 2022	TF	Path between plots 41 & 42 revised, Rear garden plot 34 revised
B	Jan 2022	TF	Updated to match revised Site Layout
A	Oct 2021	KS	Aligned with DDC plan
REV	DATE	BY	AMENDMENTS

GS Brown
CONSTRUCTION

The Nurseries,
St Madoes,
Glencarse, PH2 7NF
Tel: 01738 860591
Email: office@gsbrown.co.uk
www.gsbrown.co.uk

J:\10 Live Sites\Methven\Disposition Plans\HBM(LE)\A001 rev F

DATE:	SCALE:	DRAWN BY:
SEPT 2021	1:500 @ A3	KS

DWG TITLE:
DEVELOPMENT PLAN APPROVAL

PROJECT:
HAYFIELD BRAE METHVEN

DWG No.	Rev.
HBM(LE)A003	C