

The Development registered under title ELN23916 and plots 114 to 128 and 135 within have been DPA approved by:
Craig McFadden - 10 December 2019
 Craig McFadden (DPA Officer)

ORDNANCE SURVEY
 GRID REFERENCE
 X - 350100
 Y - 673100
 Letham Mains
 Smallholdings

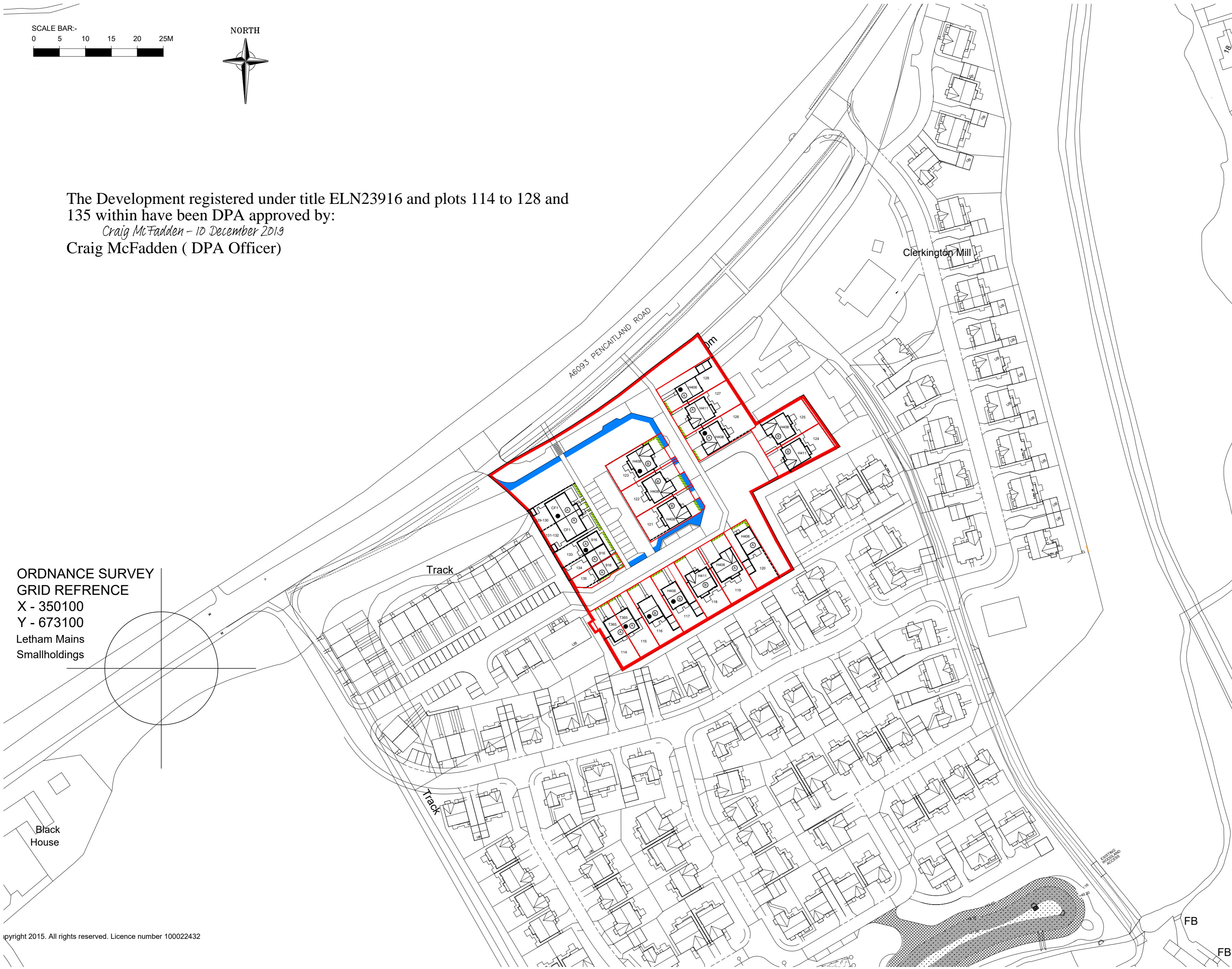

WARNING TO HOUSE-PURCHASERS
 PROPERTY MISDESCRIPTIONS ACT 1991
 BUYERS ARE WARNED THAT THIS IS A WORKING DRAWING AND IS NOT INTENDED TO BE TREATED AS A DESCRIPTIVE MATERIAL DESCRIBING IN RELATION TO ANY PARTICULAR PROPERTY OR DEVELOPMENT, OF THE SPECIFIED MATTERS PRESCRIBED BY ANY ORDER MADE UNDER THE ABOVE ACT. THE CONTENTS OF THIS DRAWING MAY BE SUBJECT TO CHANGE AT ANY TIME AND ALTERATIONS / VARIATIONS CAN OCCUR DURING THE PROGRESS OF THE WORKS WITHOUT REVISION OF DRAWING. CONSEQUENTLY THE LAYOUT, FORM, CONTENT AND DIMENSIONS OF THE FINISHED CONSTRUCTION MAY DIFFER MATERIALLY FROM THOSE SHOWN. NOR DO THE CONTENTS OF THIS DRAWING CONSTITUTE A CONTRACT, PART OF ANY CONTRACT OR WARRANTY.



DEVELOPMENT	
Dovecot Yard 2017 Alba	
TITLE	
D.P.A Plan	
SCALES 1:1250	DRG. No.
DATE Sept. 2019	DPA - 02 D