

Notes  
 Do not scale from this drawing.  
 All contractors must visit the site and be responsible for taking and checking dimensions.  
 All construction information should be taken from figured dimensions only.  
 Any discrepancies between drawings, specifications and site conditions must be brought to the attention of the supervising officer.  
 This drawing & the works depicted are the copyright of JTP.  
 This drawing is prepared for the specific project stage in the Drawing Status section below and it is not intended to be used for any other purpose. Whilst all reasonable efforts are used to ensure drawings are accurate, JTP accept no liability for any reliance placed on, or use made of, this plan by anyone for purposes other than those stated in the Drawing Status below.

- - - Development boundary
- Plot boundary
- Housing Association
- Land in private ownership
- Scottish Water SUDs basin
- Wayleave
- Adoptable access road
- Adoptable footpath
- Adoptable block paving road
- Adoptable block paving footpath
- Private access road
- Common Open Space (maintained by factor)
- SUDS access layby (maintained by factor)
- 'Meadow' space

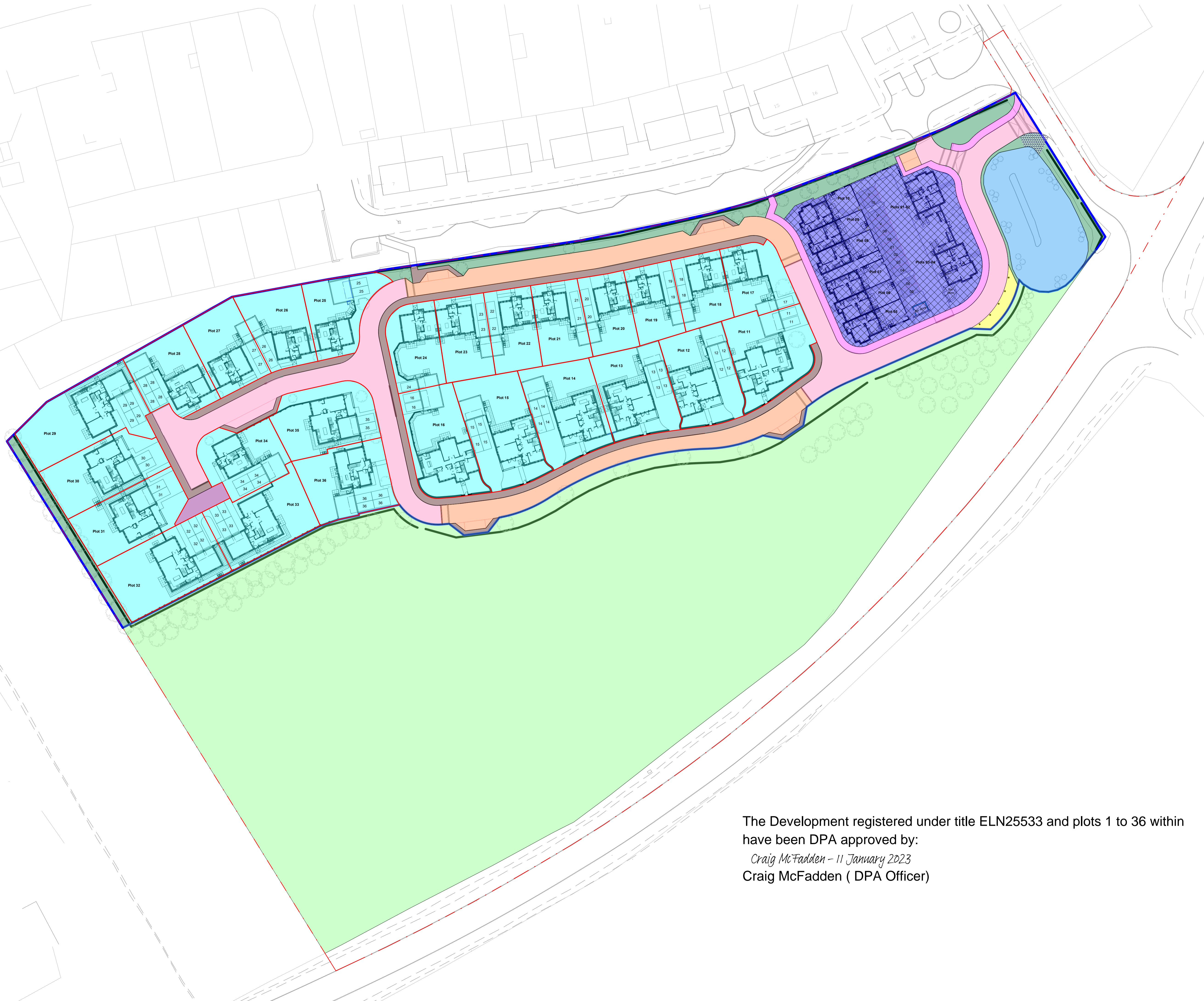

C2	08.12.22	Individual plot boundaries added. Meadow space indicated. Key updated.	SG	LD
C1	13.01.22	First issue	KB	LD

Rev	Date	Description	Drawn	Chkd
Drawing Status				

For Information



Project  
**Castlemains Dirleton**

Drawing Title  
**Development Factoring Plan**

Scale @A1 1 : 500 Job Ref. 01010G  
 Drawing No. MP-PL-DR-A-SL-020 Revision C2  
 Scale Bar

The Development registered under title ELN25533 and plots 1 to 36 within have been DPA approved by:  
*Craig McFadden - 11 January 2023*  
 Craig McFadden ( DPA Officer)