

The development registered under title MID209411 and plots 317 to 357, 359, 361, 363 to 387, 391 to 407, 411 to 413, 415, 417 to 448, 450, 455, 465, 470 to 472, 474 to 592, 596 to 609 and 701 to 705 within have been DPA approved by:

*D MacDonald - 06/12/2021*

David MacDonald (DPA Officer)

Flat Block 392-406  
Scale 1:1000 @ A3

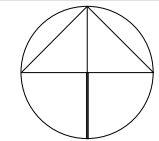
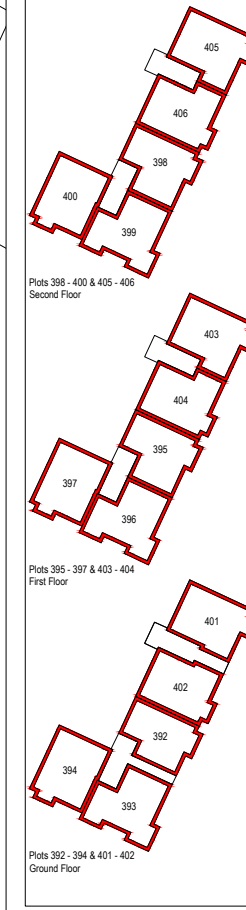

NORTH

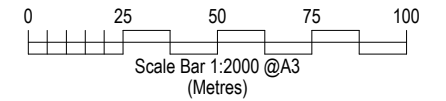

**LEGEND**

- Site Boundary**
- Private hardstanding area shared between plots 320-322 maintained by factor. (Light Red)
- Private hardstanding area shared between plots 324-326 maintained by factor. (Orange)
- Private hardstanding area shared between plots 344-346 maintained by factor. (Pink)
- Private hardstanding and parking areas shared between plots 352-354 maintained by factor. (Light Red with hatch)
- Private hardstanding area shared between plots 360-362 maintained by factor. (Light Blue)
- Soft landscaped area, paths and bin/cycle store shared between plots 373-387 maintained by factor with wayleave access to Fibrenest. (Yellow with hatch)
- Soft landscaped area, parking, paths and bin/cycle store shared between plots 392-406 maintained by factor with wayleave access to Fibrenest. (Pale Blue with cross hatch)
- Private hardstanding and parking areas shared between plots 417-419 maintained by factor. (Orange with hatch)
- Private hardstanding and parking areas shared between plots 426-429 maintained by factor. (Magenta with hatch)
- Private hardstanding and parking areas shared between plots 457-468 maintained by factor. (Dark Blue with cross hatch)
- Private hardstanding area shared between plots 475-477 maintained by factor. (Purple)
- Private hardstanding area shared between plots 511-514 maintained by factor. (Gold cross hatch)
- Private hardstanding and parking areas shared between plots 515-517 maintained by factor. (Lime)
- Private hardstanding area shared between plots 532-534 maintained by factor. (Burgundy with cross hatch)
- Private hardstanding area shared between plots 535-537 maintained by factor. (Teal)
- Private hardstanding area shared between plots 554-556 maintained by factor. (Dark Yellow)
- Private bin hardstanding shared between plots 559-563 maintained by factor. (Brown)
- Private hardstanding area shared between plots 564-566 maintained by factor. (Purple with cross hatch)
- Private hardstanding and bin hardstanding shared between plots 570-573 maintained by factor with wayleave access to Fibrenest. (Green with hatch)
- Private hardstanding area shared between plots 701-704 maintained by factor. (Turquoise with cross hatch)
- Scottish Water Servitude Right of Access (Dark Blue hatch)

**Persimmon Homes**

Persimmon Homes East Scotland  
Unit 1  
Wester Inch Business Park  
Old Well Court  
Bathgate  
West Lothian  
EH48 2TQ  
17th March 2021

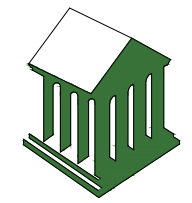

**South Gilmerton - DPA Rev E**

Flat Block 373-387  
Scale 1:1000 @ A3

