

### LEGEND

- Boundary Extent Of Grounds
- Individual Unit Boundary
- No 3 Crichton Street
- No 5 Crichton Street
- No 13 Crichton Street
- Communal Stairwell
- Communal Access
- Communal Parking
- Communal Bin Area
- Communal Space and Access

The development registered under titles FFE54178, FFE51373, FFE95545, FFE95760 and FFE97698 within have been DPA approved by:  
*D MacDonald - 31/10/2022*  
 David MacDonald (DPA Officer)

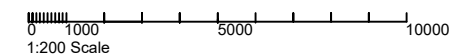
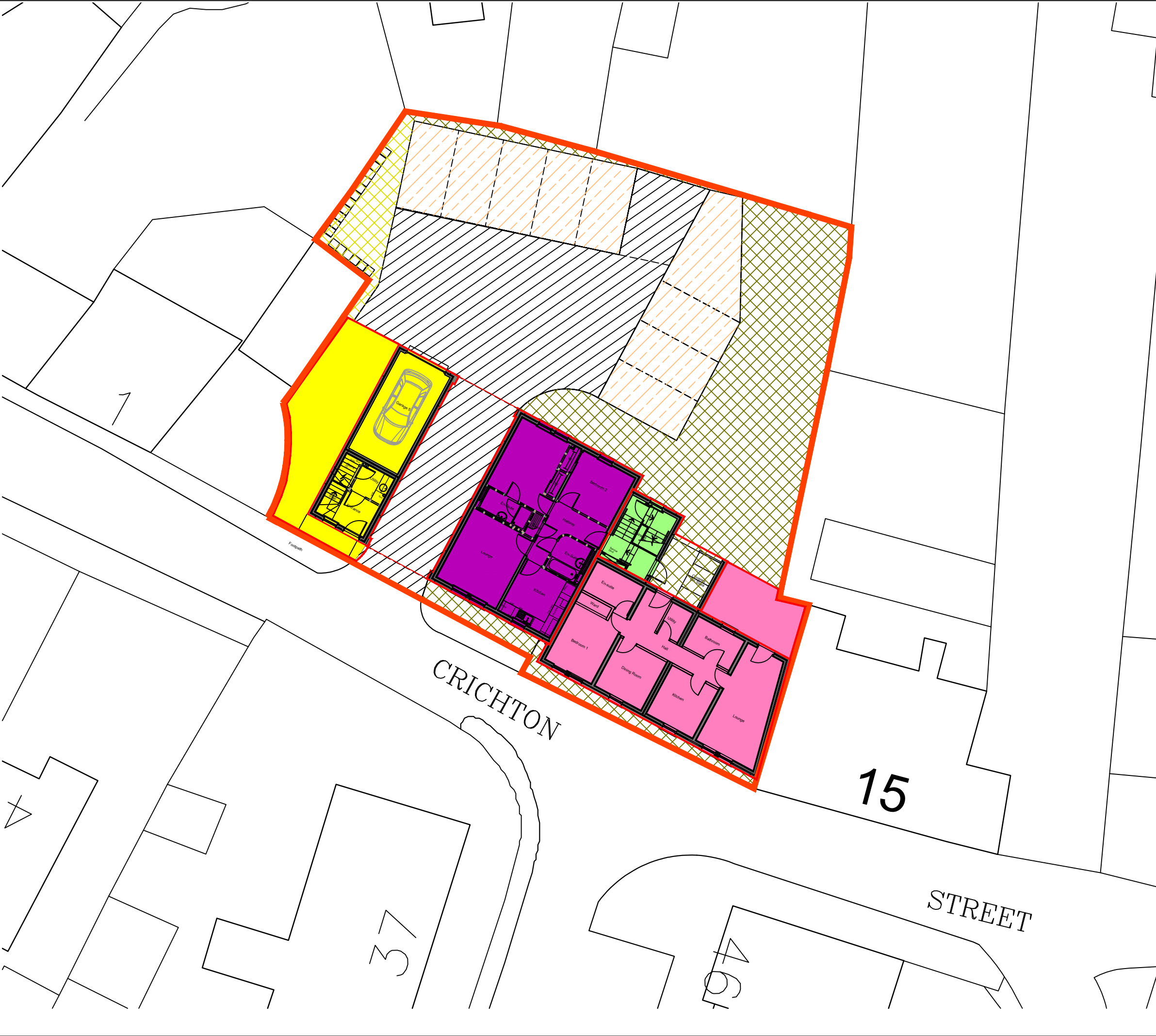

	1:200	MARCH.2022
Property Address :		
Ground Floor - Crichton Street		
Anstruther		
KY10 3DE		

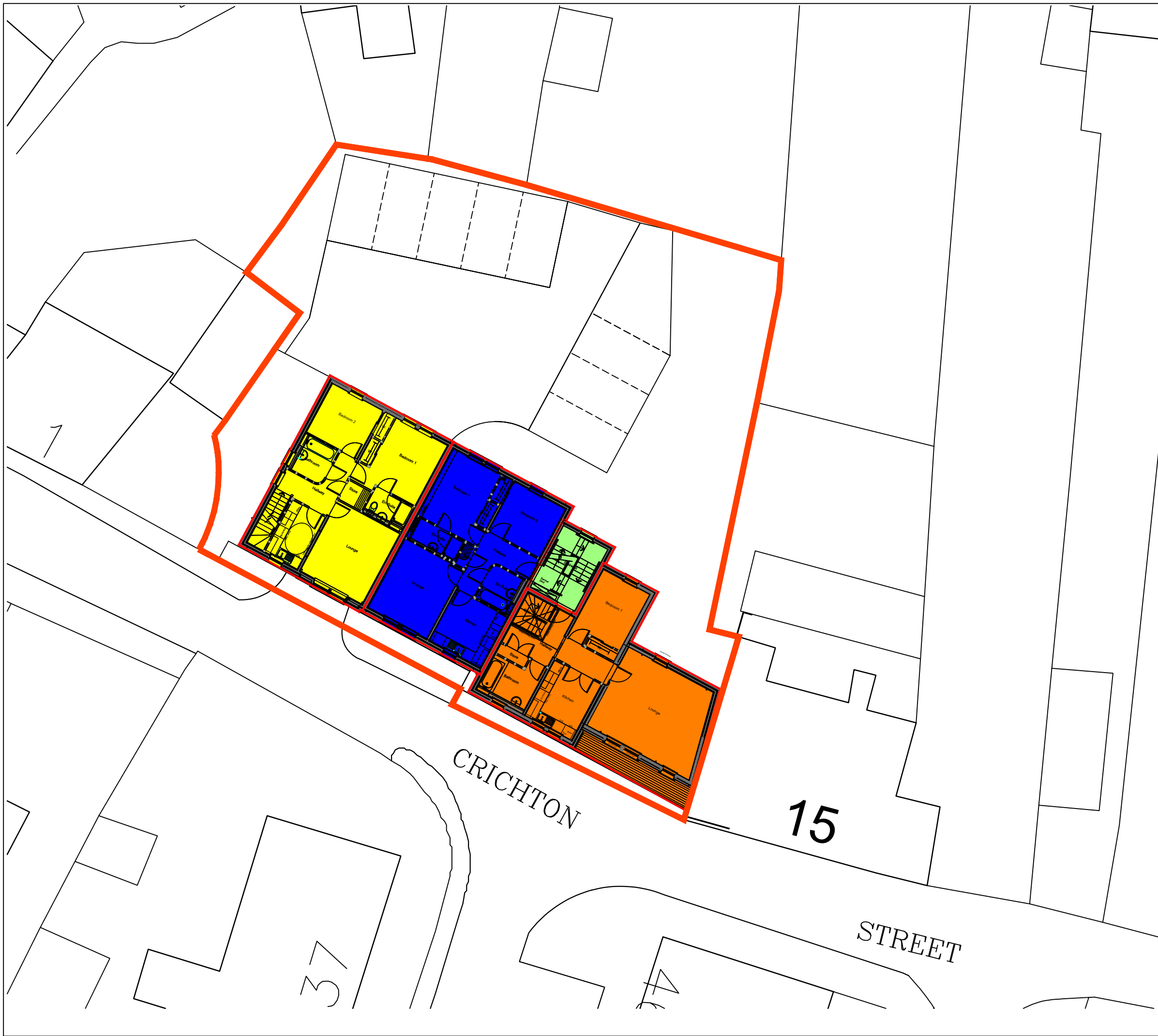

**LEGEND**

- Boundary Extent Of Grounds
- Individual Unit Boundary
- No 3 Crichton Street
- No 7 Crichton Street
- No 9 Crichton Street
- Communal Stairwell

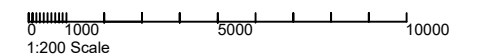

	1:200	MARCH.2022
--	-------	------------

Property Address :  
 First Floor - Crichton Street  
 Anstruther  
 KY10 3DE



**LEGEND**

- Boundary Extent Of Grounds
- Individual Unit Boundary
- No 9 Crichton Street
- No 11 Crichton Street
- Communal Stairwell

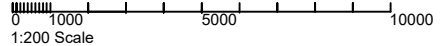

	1:200	MARCH.2022
--	-------	------------

Property Address :  
 Second Floor - Crichton Street  
 Anstruther  
 KY10 3DE