

# HOUSING DEVELOPMENT AT "BOTANICS", CROFTHHEAD ROAD, KILMAURS. KA3 2RT.

ORDNANCE SURVEY REF: NS 408411

The Development registered under title AYR67628 and plots 7,8 & 8A  
and 54 to 56 and 61 to 66, 66A and 67 to 69 within

have been DPA approved by:  
*Craig McFadden - 9 June 2017*

Craig McFadden ( DPA Officer)

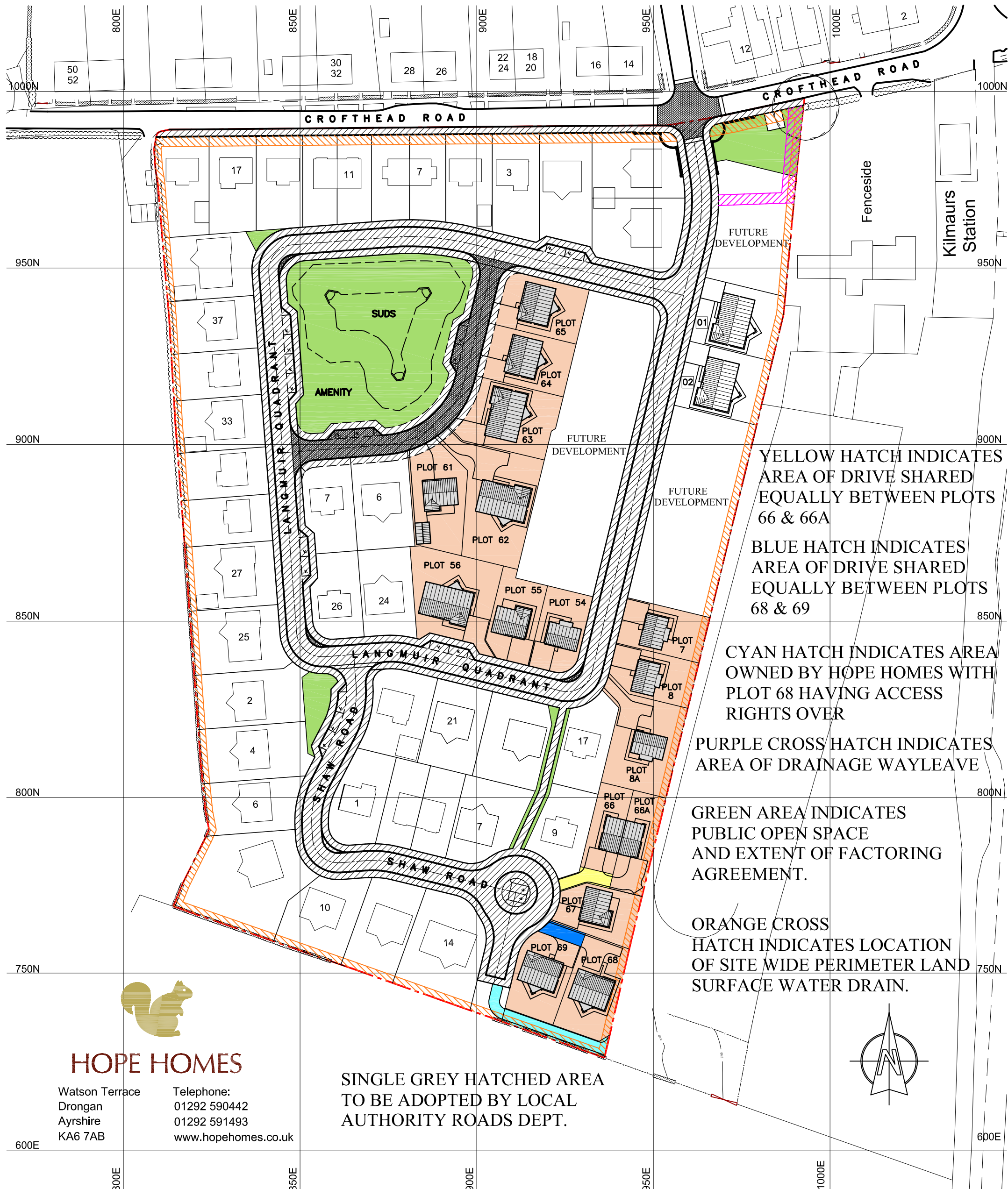

YELLOW HATCH INDICATES  
AREA OF DRIVE SHARED  
EQUALLY BETWEEN PLOTS  
66 & 66A

BLUE HATCH INDICATES  
AREA OF DRIVE SHARED  
EQUALLY BETWEEN PLOTS  
68 & 69

CYAN HATCH INDICATES AREA  
OWNED BY HOPE HOMES WITH  
PLOT 68 HAVING ACCESS  
RIGHTS OVER

PURPLE CROSS HATCH INDICATES  
AREA OF DRAINAGE WAYLEAVE

GREEN AREA INDICATES  
PUBLIC OPEN SPACE  
AND EXTENT OF FACTORING  
AGREEMENT.

ORANGE CROSS  
HATCH INDICATES LOCATION  
OF SITE WIDE PERIMETER LAND  
SURFACE WATER DRAIN.

SINGLE GREY HATCHED AREA  
TO BE ADOPTED BY LOCAL  
AUTHORITY ROADS DEPT.



**HOPE HOMES**

Watson Terrace  
Drongan  
Ayrshire  
KA6 7AB

Telephone:  
01292 590442  
01292 591493  
[www.hopehomes.co.uk](http://www.hopehomes.co.uk)

**DEED OF REAL  
BURDENS PLAN**

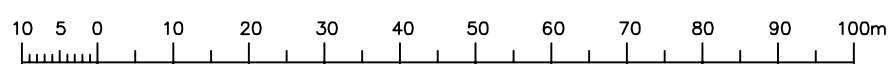

SCALE 1:1000 © A3 Rev B

May 2017