

SHARED DRIVEWAY ACCESS
PLOTS 868, 869 & 870

SHARED DRIVEWAY ACCESS
PLOTS 886, 887, 888, 889, 890, 891, 892 & 893

SHARED FOOTPATH ACCESS
PLOTS 835 & 836

SHARED FOOTPATH ACCESS
PLOTS 873, 874 & 875

The Development registered under Title FFE90275 and
Plots 831 to 876 (inclusive) and Plots 882 to 893 (inclusive)
within have been DPA approved by:
I MacLaren - 29th July 2016
Iain MacLaren (DPA Officer)

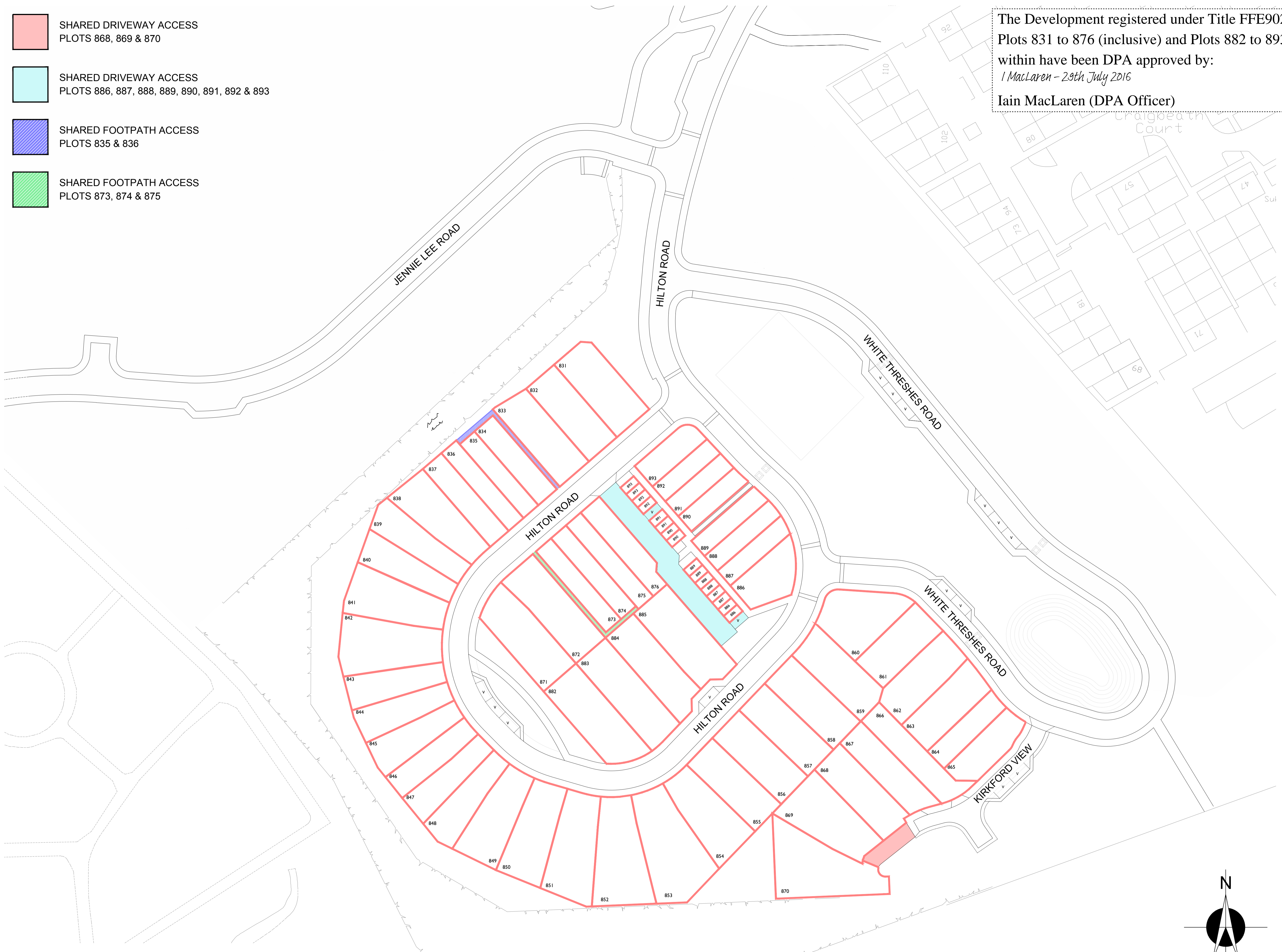

AMENDMENTS:

Issue	Date	Description

Bellway
Bellway Homes Limited (Scotland)
Bothwell House
Hamilton Business Park
Caird Street
Hamilton
ML3 0QA
Tel: 01698 477440 Fax: 01698 4774 Fax: 01698 4774 Web: www.bellway.co.uk

Project:
**COWDENBEATH
BIRCHWOOD
PHASE 4B**

Drawing:
**DEVELOPMENT
PLAN APPROVAL**

Scale: 1:500 @ A1	Date: JUNE '16	Drawn: JG
Drawing No. CH/PH4B/DPA	Rev. -	

