

The development registered under titles MID190389 & MID174837 and plots 19 to 50, 53 and 61 to 145 within have been DPA approved by:

D MacDonald - 24 Jan 2020

David MacDonald (DPA Officer)

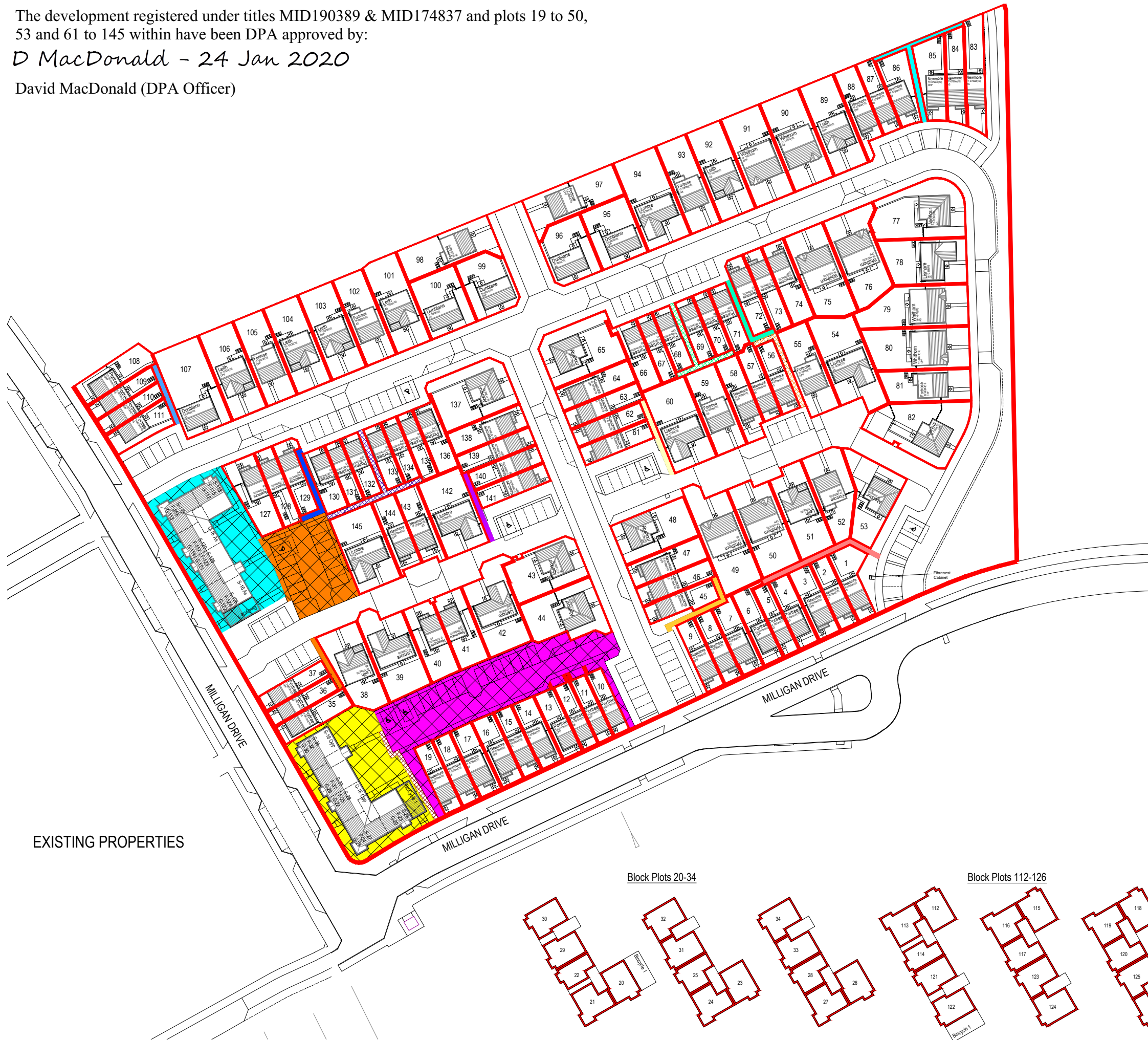
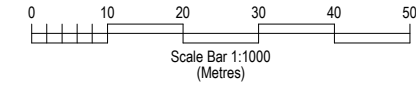

LEGEND

- Site Boundary
- Shared hardstanding 1 adopted & maintained by factor. (Light Red) - Plots 1-6
- Shared hardstanding 2 adopted & maintained by factor. (Dark Red cross hatch) - Plots 20-34
- Shared hardstanding 3 adopted & maintained by factor. (Orange) - Plots 35-37
- Shared hardstanding 4 adopted & maintained by factor. (Light Orange) - Plots 7-9 and 45-46
- Shared hardstanding 5 adopted & maintained by factor. (Orange cross hatch) - Plots 56-57
- Shared hardstanding 6 adopted & maintained by factor. (Light Yellow) - Plots 61-63
- Shared hardstanding 7 adopted & maintained by factor. (Mint Green cross hatch) - Plots 67-71
- Shared hardstanding 8 adopted & maintained by factor. (Turquoise) - Plots 72-73
- Shared hardstanding 9 adopted & maintained by factor. (Cyan) - Plots 83-87
- Shared hardstanding 10 adopted & maintained by factor. (Sky Blue) - Plots 108-111
- Shared hardstanding 11 adopted & maintained by factor. (Blue) - Plots 128-129
- Shared hardstanding 12 adopted & maintained by factor. (Indigo cross hatch) - Plots 131-135 and 143-144
- Shared hardstanding 13 adopted & maintained by factor. (Purple) - Plots 139-141
- Shared hardstanding courtyard 1 adopted & maintained by factor. (Magenta with black hatch) - Plots 10-34
- Shared hardstanding courtyard 2 adopted & maintained by factor. (Orange with black hatch) - Plots 112-126 and 143-144
- Shared soft landscaped area, paths and bicycle store adopted & maintained by factor. (Yellow with black hatch) - Plots 20-34
- Shared soft landscaped area, paths and bicycle store adopted & maintained by factor (Cyan with black hatch) - Plots 112-126

Block Plots 20-34

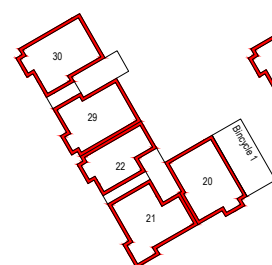

Plots 20-22 and 29-30
Ground Floor

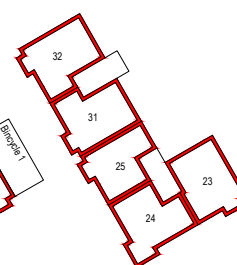

Plots 23-25 and 31-32
First Floor

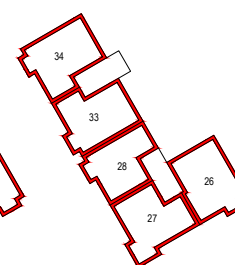

Plots 26-28 and 33-34
Second Floor

Block Plots 112-126



Plots 112-114 and 121-122
Ground Floor



Plots 115-117 and 123-124
First Floor

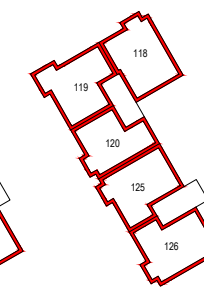

Plots 118-120 and 125-126
Second Floor

Persimmon Homes

Persimmon Homes East Scotland
Unit 1
Wester Inch Business Park
Old Well Court
Bathgate
West Lothian
EH48 2TQ

23rd January 2020

