

NOTICE TO HOUSERS - PARCELINGS
 This drawing is a preliminary drawing and is not intended to be used as a final drawing. It is subject to change without notice. It is the responsibility of the client to ensure that all necessary permissions and consents are obtained before any work is carried out. The client should also ensure that all necessary permissions and consents are obtained before any work is carried out. The client should also ensure that all necessary permissions and consents are obtained before any work is carried out.

The Development registered under Title FFE114989
 and all plots within including the open space have
 been DPA approved by:
 I MacLaren - 13th November 2017
 Iain MacLaren (DPA Officer)

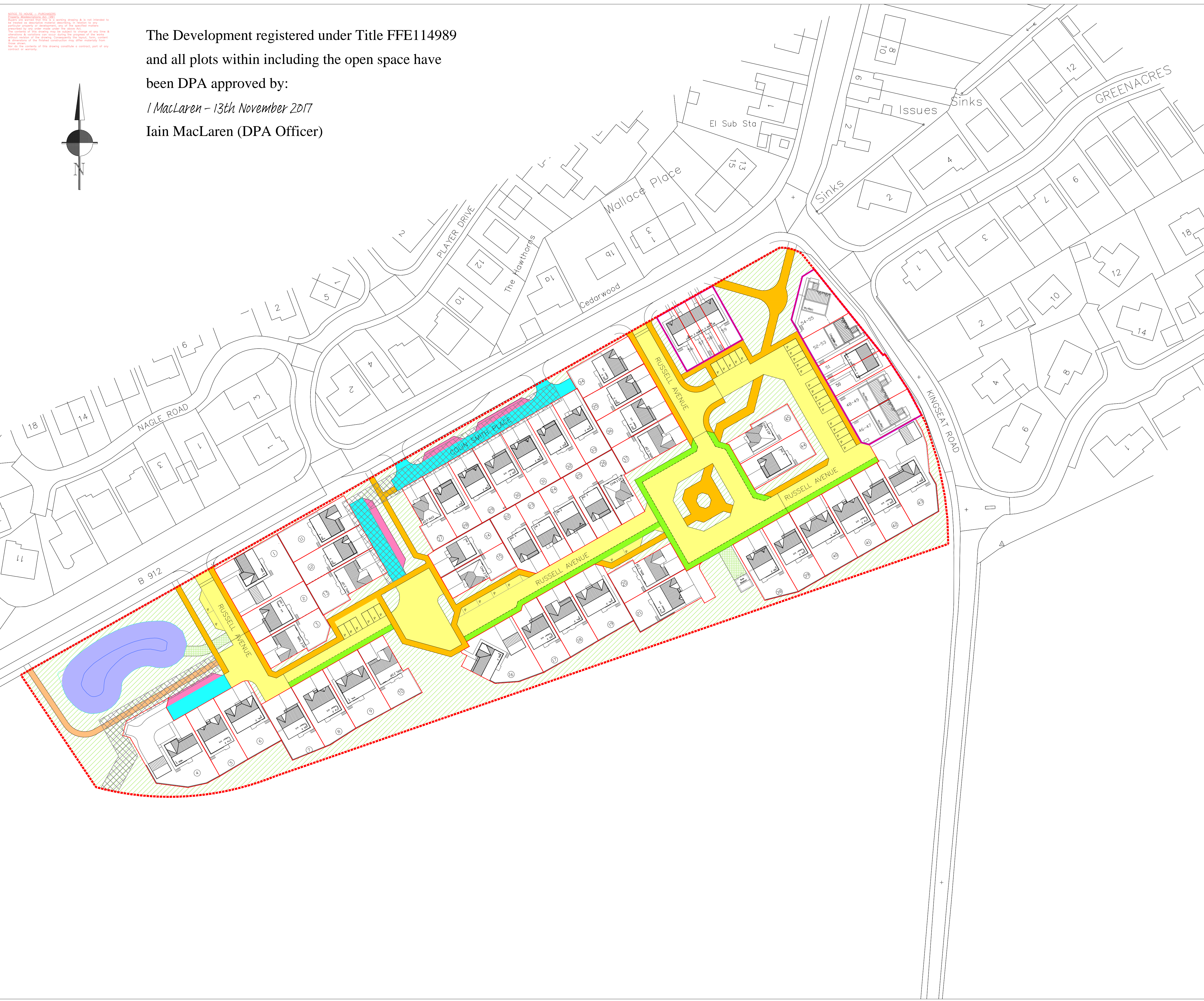
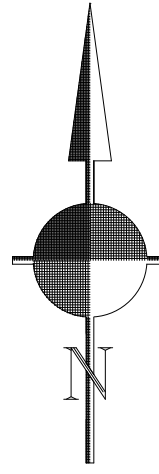

LEGEND:

- Adoptable Footpaths
- Adoptable Roads
- Adoptable Parking Bays P
- Adoptable Service Strip
- Factored Footpath
- Private Shared Access Road
- Private Parking Bays
- Adoptable SUDS Basin
- Factored Public Open Space
- Factored Service Access Surface
- Sewer Wayleaves
- Feu Boundary
- Affordable Boundary
- Title Boundary

NOTES

A FEB'17 PLM NORTH WEST CORNER OPEN SPACE REVISED
 B APR'17 PLM SEWER WAYLEAVES ADDED. DUAL FRONTAGE PLOT LANDSCAPE BUFFER REMOVED.
 C JUN'17 PLM PLOT 4 REVISED TO REFLECT REVISED LANDSCAPING BOUNDARY. SERVICE STRIPS INCREASED FROM 1M TO 2M AT REQUEST OF R&T
 D JUN'17 PLM AFFORDABLE BOUNDARY ADDED
 E JUL'17 PLM PRIVATE SHARED DRIVEWAY OMITTED IN LEGEND & REPLACED BY FACTORED ACCESS ROADWAY. FACTORED DEVELOPMENT PARKING INCLUDED ON LAYOUT TO REFLECT PLANNING CONDITION 25. VISITOR PARKING IDENTIFIED ON LAYOUT WITH 'V' AS PER RDS KEEPER REQUEST. SUDS BASIN REVISED IN LEGEND.

REV	DATE	DRAWN	DESCRIPTION
F	AUG'17	PLM	VISITOR PARKING REVISED ON LEGEND & ON PLAN. SHARED ACCESS ROAD & SHARED COMMUNAL VISITOR PARKING REVISED ON LEGEND AS A RESULT OF RECENT COMMUNICATION FROM ROADS & TRANSPORT RELATIVE TO RCC.
G	OCT'17	PLM	REVISIONS TO PLOT 6, 7, 9, 10, 13, 24 & 27 DUE TO CHANGES ON SITE. PLEASE REFER TO DEVELOPMENT LAYOUT REVISION 1 FOR FULL DESCRIPTION OF CHANGES.
H	NOV'17	PLM	ADDPATABLE PARKING BAY LEGEND REVISED FROM 'V' TO 'P' AS PER ROADS & TRANSPORT REQUEST.
I	NOV'17	PLM	PRIVATE SHARED COMMUNAL VISITOR PARKING REVISED AT LEGALS REQUEST TO PRIVATE PARKING BAYS.

Taylor Wimpey East Scotland
 1 Masterton Park
 Carnegie Campus
 Dunfermline KY11 8PL
 Tel 01383 845 700 Fax 01383 845 725
 www.taylorwimpey.com

Project:
**Land West of Kingseat Road, Fife
 Kingseat**

Title:
Master Feu Layout

Dwg No: **11411 / - / FEU-01 |**

Scale: 1:500 @ A1 Date: FEB'17
 Drawn By: RC Checked By: PLM