

INFORMATION

JOB Residential Development		
CLIENT Doonfoot Developments Ltd		
SITE Nightingale House, 18-20 Doonfoot Road, Ayr, KA7 4DN		
DRAWING TITLE Development Plan		
DRAWING No. 17-0217/TDP/01	REV A	
SCALE As Stated	DRAWN DK	DATE Feb '17
Edesign Architecture & Planning Ltd. 64 Wellington Chambers, Ayr, KA7 1EH T: 01292 263799 T: 01292 289332 E: enquiry@edesignarchitecture.co.uk		
REV A	DESCRIPTION All units shown	DATE 16.08.17

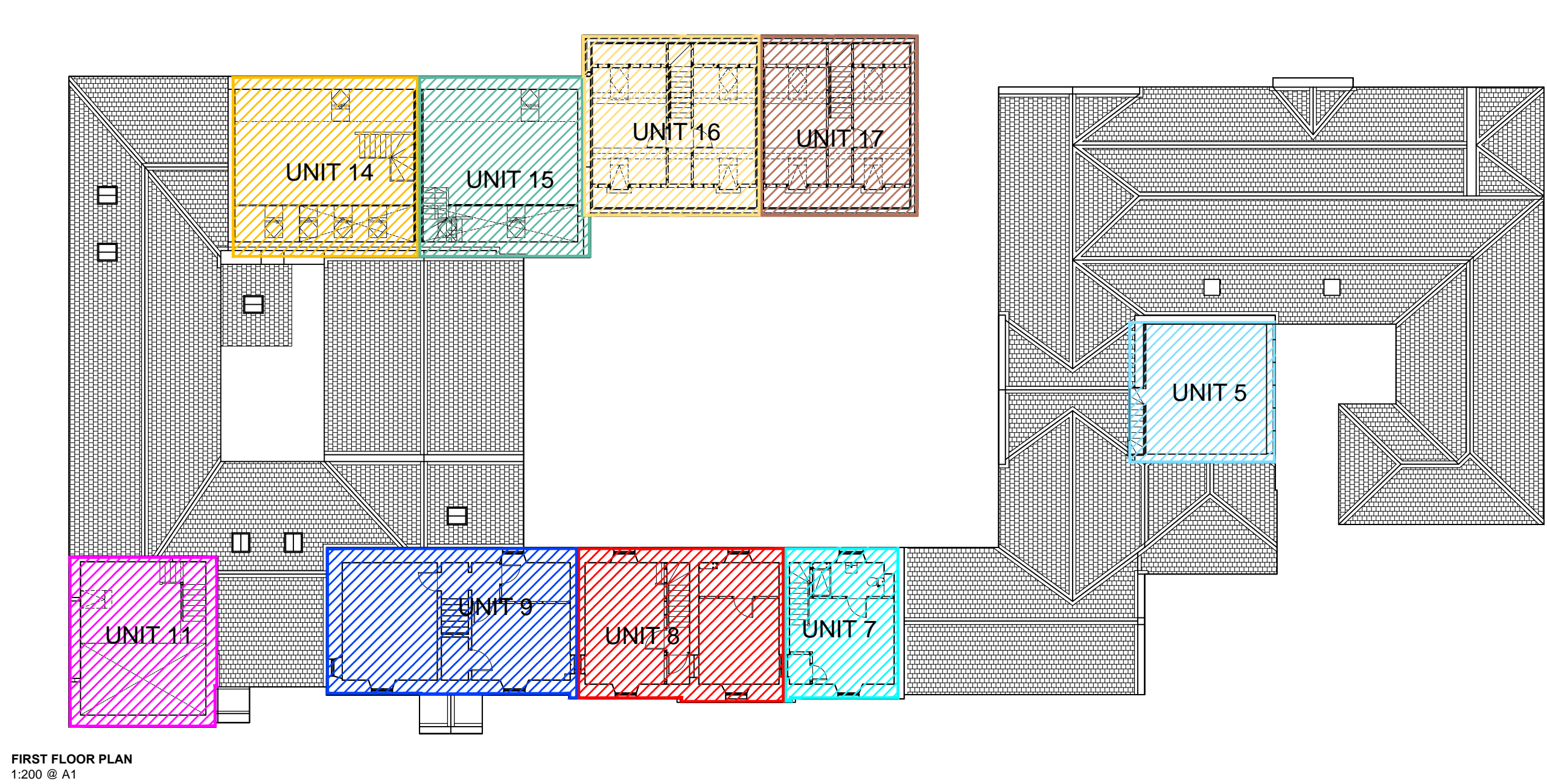
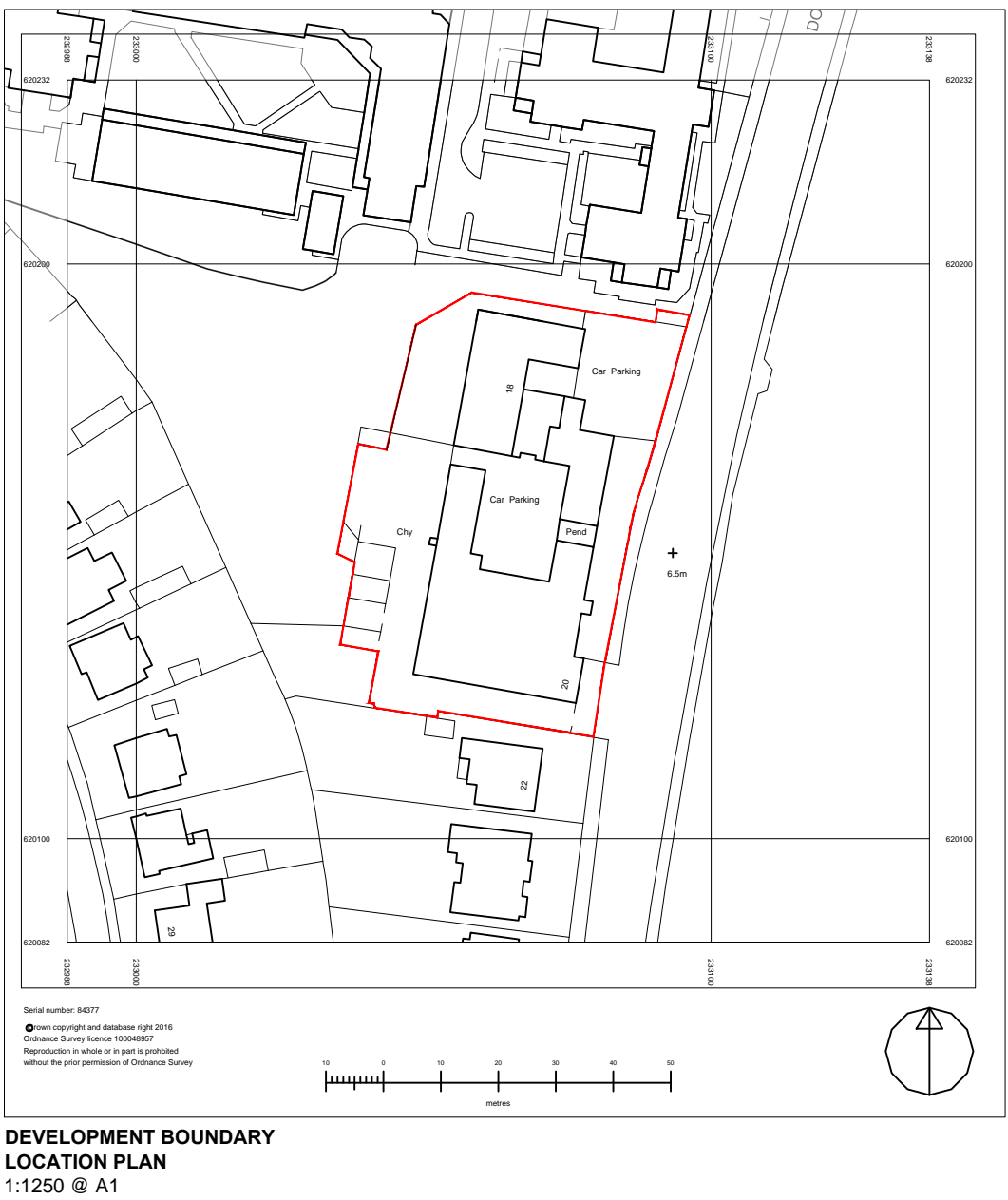

The Development registered under Title AYR103936 and  
Units 1 to 17 (inclusive) within have been DPA approved by:  
*I MacLaren - 5th September 2017*  
Iain MacLaren (DPA Officer)

NOTES:  
- Do not scale from drawing; use written dimensions only.

