

NOTES

**LEGEND:**

Adoptable Footpaths	
Adoptable Roads	
Adoptable Service Strip Factor Maintained	
Sub-Station / Switch Station	
Pumping Station	
Bike Store	
Bin Store	
Factor Maintained Public Open Space Serving Development	
Factor Maintained Public Open Space Serving Flats	
Factor Maintained Parking Court	
Factor Maintained Footpath	
Factor Maintained Hedge Planting	
Factor Maintained SUDS Basin	
Private Parking Space	
Footpath Serving Flats	
Factor Maintained Drying Greens exclusive to Dunedin Cammore	
Factor Maintained Access to Pumping Station/SubStations/Switching Station	
Private Shared Driveway	
Factor Maintained Play Area	
TW Title Boundary	
Feu Boundary	

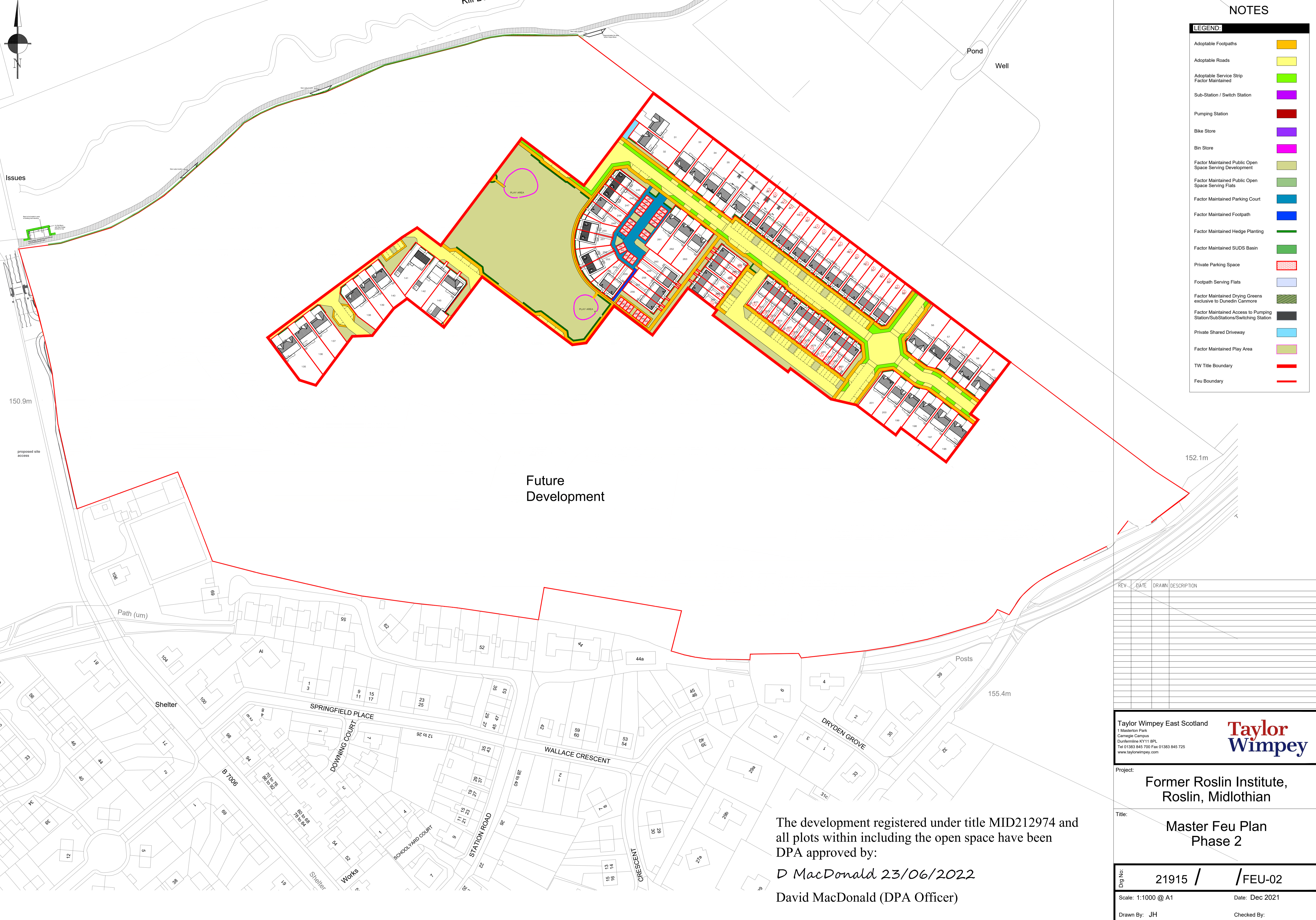

Future  
Development

REV.	DATE	DRAWN	DESCRIPTION

Taylor Wimpey East Scotland  
1 Masterton Park  
Carnegie Campus  
Dunfermline KY11 8PL  
Tel 01383 8467700 Fax 01383 845725  
www.taylorwimpey.com



Project:  
**Former Roslin Institute,  
Roslin, Midlothian**

Title:  
**Master Feu Plan  
Phase 2**

The development registered under title MID212974 and  
all plots within including the open space have been  
DPA approved by:  
*D MacDonald 23/06/2022*  
David MacDonald (DPA Officer)

Dwg No: 21915 / /FEU-02

Scale: 1:1000 @ A1 Date: Dec 2021

Drawn By: JH Checked By: