

The development registered under titles OAZ17120, OAZ17123, OAZ17266, OAZ17853 & OAZ18449 and plots 1 to 28 (Phase 1) and 1 to 12 & 33 to 42 (Phase 2) within have been DPA approved by:

*The Keeper - 18 July 2023*  
Keeper for the Registers of Scotland

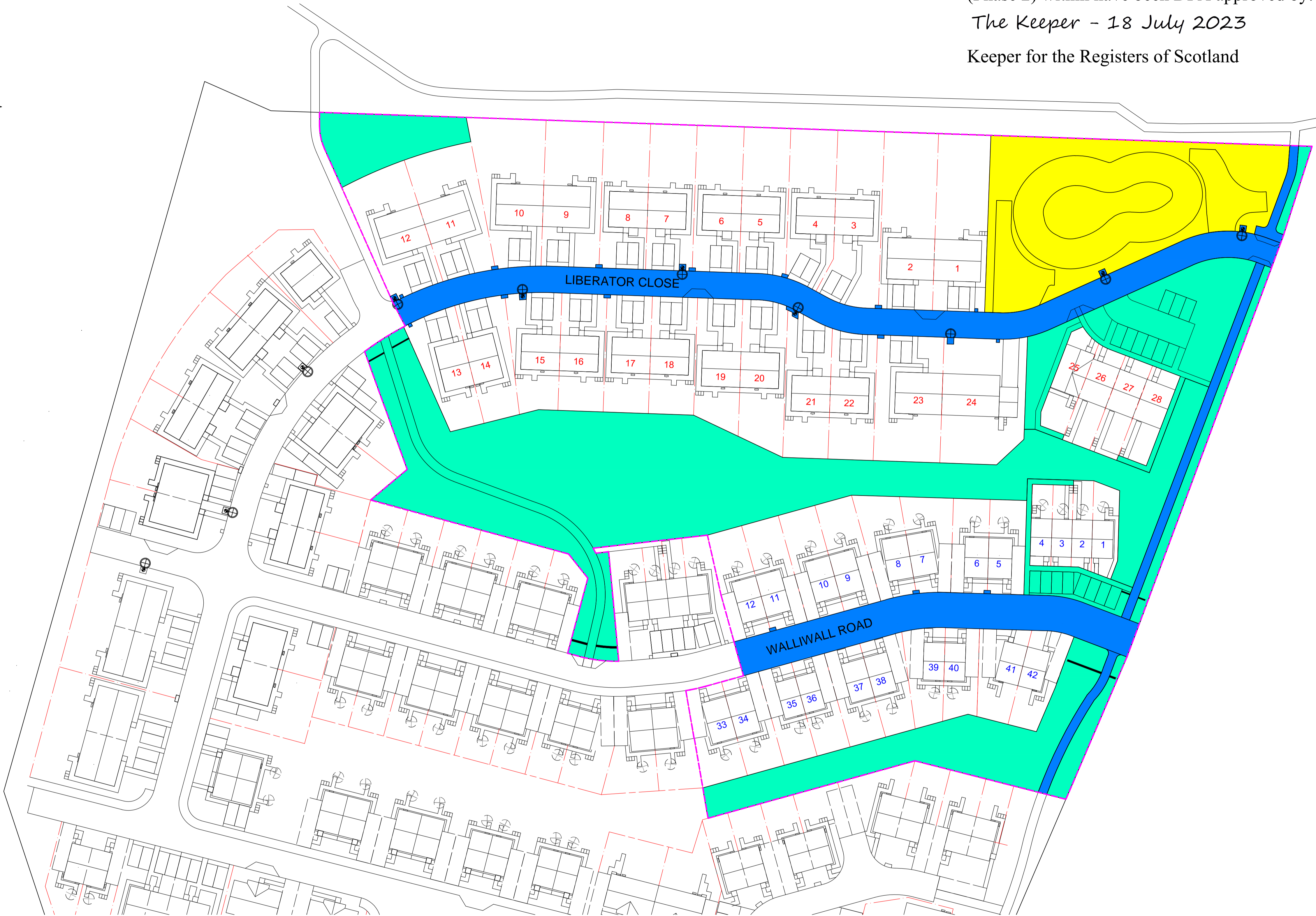
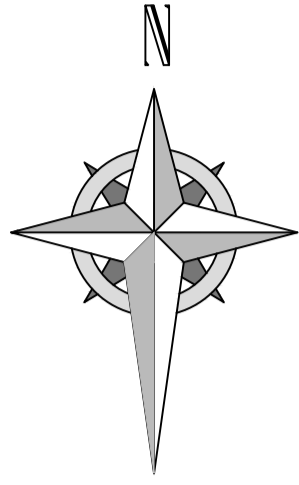

**POSTAL ADDRESSES**

**Phase 1**

Plot no.	Postal address
1	-18, Liberator Close, Kirkwall, Orkney, KW15 1LZ
2	-20, Liberator Close, Kirkwall, Orkney, KW15 1LZ
3	-22, Liberator Close, Kirkwall, Orkney, KW15 1LZ
4	-24, Liberator Close, Kirkwall, Orkney, KW15 1LZ
5	-26, Liberator Close, Kirkwall, Orkney, KW15 1LZ
6	-28, Liberator Close, Kirkwall, Orkney, KW15 1LZ
7	-30, Liberator Close, Kirkwall, Orkney, KW15 1LZ
8	-32, Liberator Close, Kirkwall, Orkney, KW15 1LZ
9	-34, Liberator Close, Kirkwall, Orkney, KW15 1LZ
10	-36, Liberator Close, Kirkwall, Orkney, KW15 1LZ
11	-38, Liberator Close, Kirkwall, Orkney, KW15 1LZ
12	-40, Liberator Close, Kirkwall, Orkney, KW15 1LZ
13	-39, Liberator Close, Kirkwall, Orkney, KW15 1LZ
14	-37, Liberator Close, Kirkwall, Orkney, KW15 1LZ
15	-35, Liberator Close, Kirkwall, Orkney, KW15 1LZ
16	-33, Liberator Close, Kirkwall, Orkney, KW15 1LZ
17	-31, Liberator Close, Kirkwall, Orkney, KW15 1LZ
18	-29, Liberator Close, Kirkwall, Orkney, KW15 1LZ
19	-27, Liberator Close, Kirkwall, Orkney, KW15 1LZ
20	-25, Liberator Close, Kirkwall, Orkney, KW15 1LZ
21	-23, Liberator Close, Kirkwall, Orkney, KW15 1LZ
22	-21, Liberator Close, Kirkwall, Orkney, KW15 1LZ
23	-19, Liberator Close, Kirkwall, Orkney, KW15 1LZ
24	-17, Liberator Close, Kirkwall, Orkney, KW15 1LZ
25	-15, Liberator Close, Kirkwall, Orkney, KW15 1LZ
26	-13, Liberator Close, Kirkwall, Orkney, KW15 1LZ
27	-11, Liberator Close, Kirkwall, Orkney, KW15 1LZ
28	-9, Liberator Close, Kirkwall, Orkney, KW15 1LZ

**Phase 2**

Plot no.	Postal address
1	-2, Walliwall Road, Kirkwall, Orkney, KW15 1LQ
2	-4, Walliwall Road, Kirkwall, Orkney, KW15 1LQ
3	-6, Walliwall Road, Kirkwall, Orkney, KW15 1LQ
4	-8, Walliwall Road, Kirkwall, Orkney, KW15 1LQ
5	-10, Walliwall Road, Kirkwall, Orkney, KW15 1LQ
6	-12, Walliwall Road, Kirkwall, Orkney, KW15 1LQ
7	-14, Walliwall Road, Kirkwall, Orkney, KW15 1LQ
8	-16, Walliwall Road, Kirkwall, Orkney, KW15 1LQ
9	-18, Walliwall Road, Kirkwall, Orkney, KW15 1LQ
10	-20, Walliwall Road, Kirkwall, Orkney, KW15 1LQ
11	-22, Walliwall Road, Kirkwall, Orkney, KW15 1LQ
12	-24, Walliwall Road, Kirkwall, Orkney, KW15 1LQ
33	-25, Walliwall Road, Kirkwall, Orkney, KW15 1LQ
34	-23, Walliwall Road, Kirkwall, Orkney, KW15 1LQ
35	-21, Walliwall Road, Kirkwall, Orkney, KW15 1LQ
36	-19, Walliwall Road, Kirkwall, Orkney, KW15 1LQ
37	-17, Walliwall Road, Kirkwall, Orkney, KW15 1LQ
38	-15, Walliwall Road, Kirkwall, Orkney, KW15 1LQ
39	-13, Walliwall Road, Kirkwall, Orkney, KW15 1LQ
40	-11, Walliwall Road, Kirkwall, Orkney, KW15 1LQ
41	-9, Walliwall Road, Kirkwall, Orkney, KW15 1LQ
42	-7, Walliwall Road, Kirkwall, Orkney, KW15 1LQ

**KEY**

- 1 - Plot number for Phase 1
- 1 - Plot number for Phase 2
- - - - - Delineates the extent of the development
- - - - - Area 2.380 hectares
- - - - - Delineates the extent of each individual plot
- Blue line - Adopted roads / footpaths
- Green area - Common Parts
- Yellow area - Adopted SUDS area

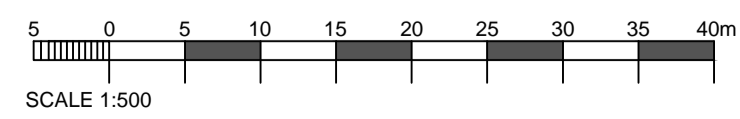

**ORKNEY BUILDERS**  
(CONTRACTORS) LTD